

THIS DRAWING IS COPYRIGHT © Western Design Ltd 2019

REPRODUCING THESE DRAWINGS BY PRINTING OR COPYING MAY LEAD TO ERRORS, PLEASE REFER TO SCALE BAR. DO NOT SCALE OFF THESE DRAWINGS FOR CONSTRUCTION PURPOSES. IF ANY DISCREPANCIES ARE FOUND, PLEASE CONTACT WESTERN DESIGN ARCHITECTS IMMEDIATELY.

DESIGNERS RISK ASSESSMENT- HEALTH AND SAFETY THE CONSTRUCTION (DESIGN AND MANAGEMENT) REGULATIONS 2015

Where appropriate, for significant hazards specific to the project please refer to drawing CDM01

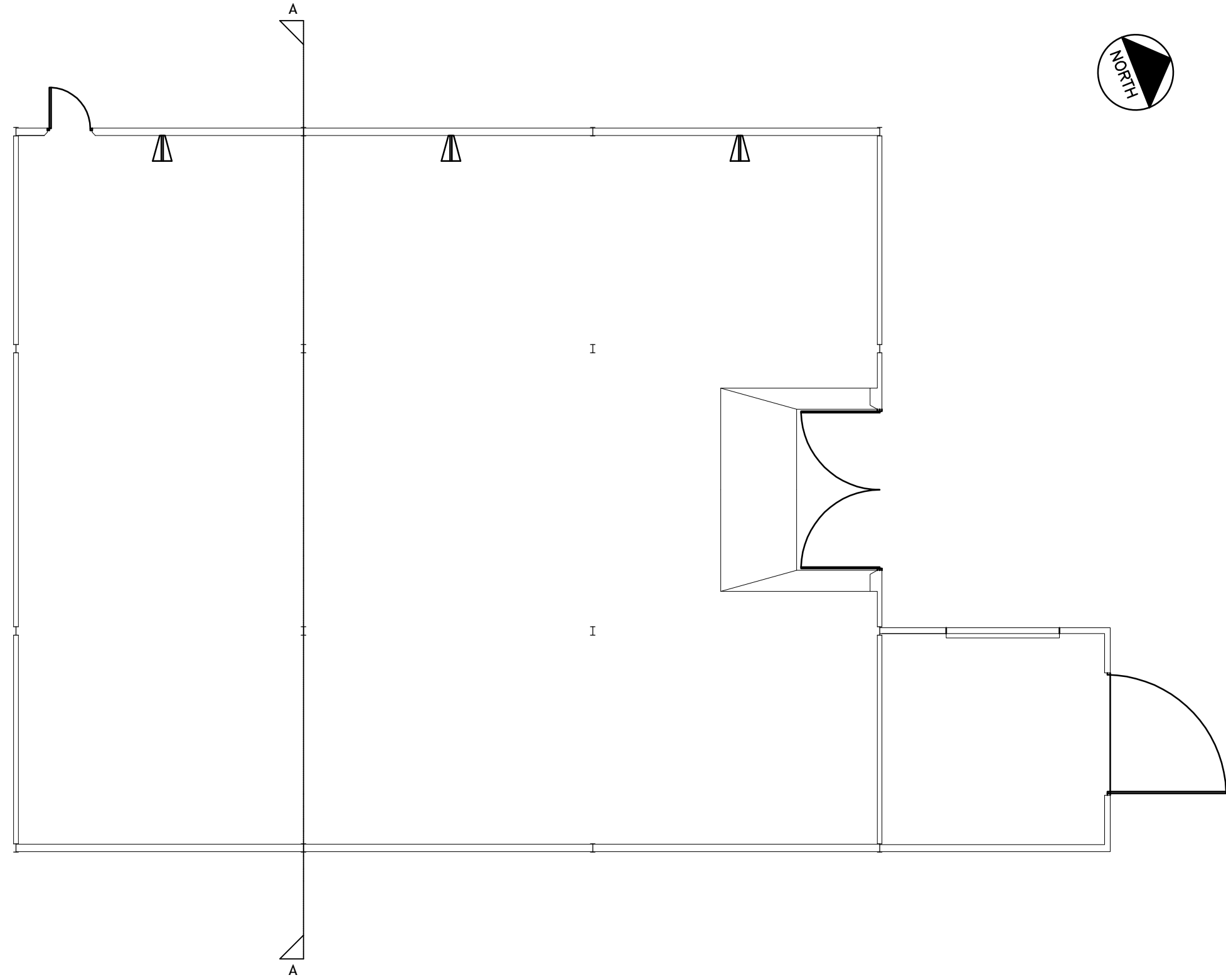

REV.	DETAILS	BY	CKD	DATE

WDA
 westerndesignarchitects.com
 Western Design Architects
 12 The Granary, Hinton Business Park, Tarrant Hinton, Dorset, DT11 8JF
 T:01258 830675 E:info@westerndesign.co.uk

CLIENT
 Julie & Jamie Kedge

PROJECT
 Barn at Slyers Lane, Stinsford

DRAWING TITLE
 Existing Ground Floor Plan

DATE 31.03.2020	DRAWN BY MT	CHECKED BY JT
--------------------	----------------	------------------

SCALE 1:100@A3	JOB NO. 1819150
-------------------	--------------------

DRAWING NO. 03	REVISION -
--------------------------	---------------

PLANNING