

Detailed planning consent for one three bedroom bungalow with parking

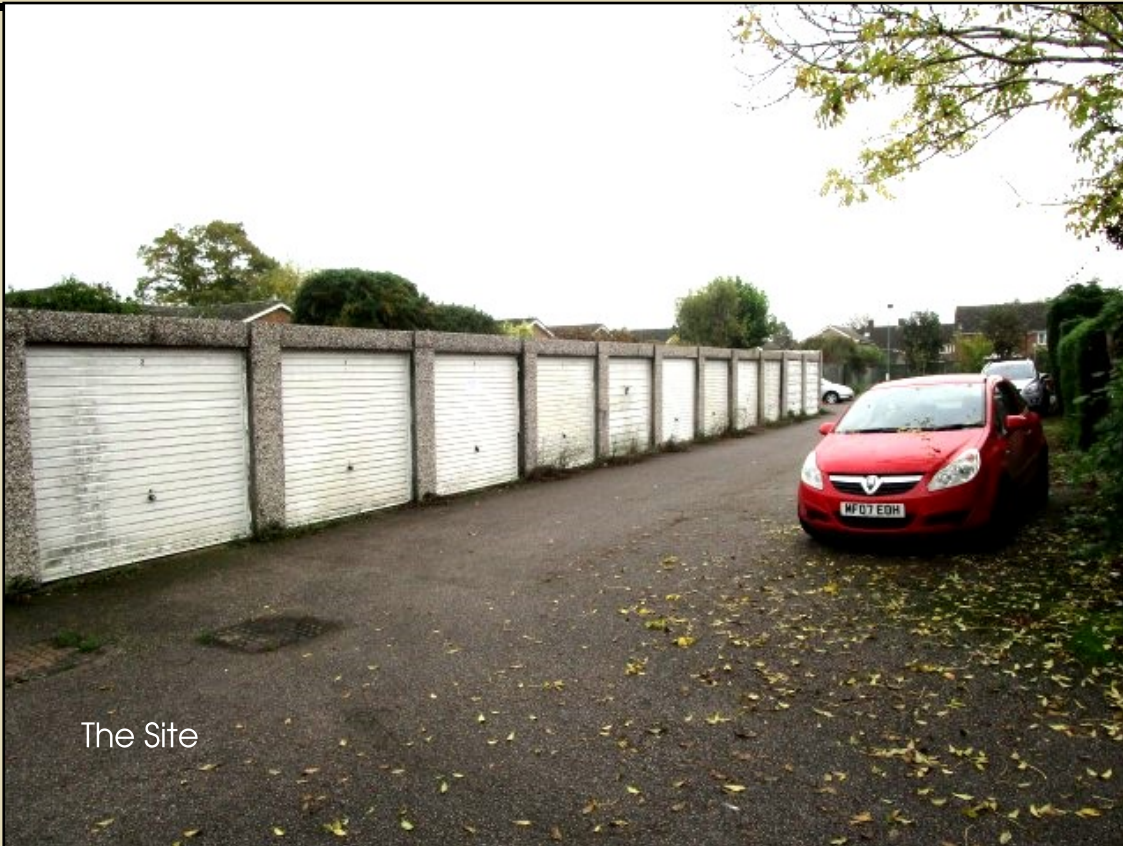

Land & Garages Bright Ridge/Keel Gardens

1-5 Keel Gardens
Southborough
TN4 0JQ

For Sale

Description

The site is irregular in shape and slopes gently from south to north. It currently consists of some 12 lock up garages with hard standing parking and turning area covering the whole site.

Proposed Development

A 3 bedroom detached bungalow of approx. 88 sq. mtrs comprising living/kitchen/dining room, entrance hall, separate WC, bathroom plus 7 parking spaces

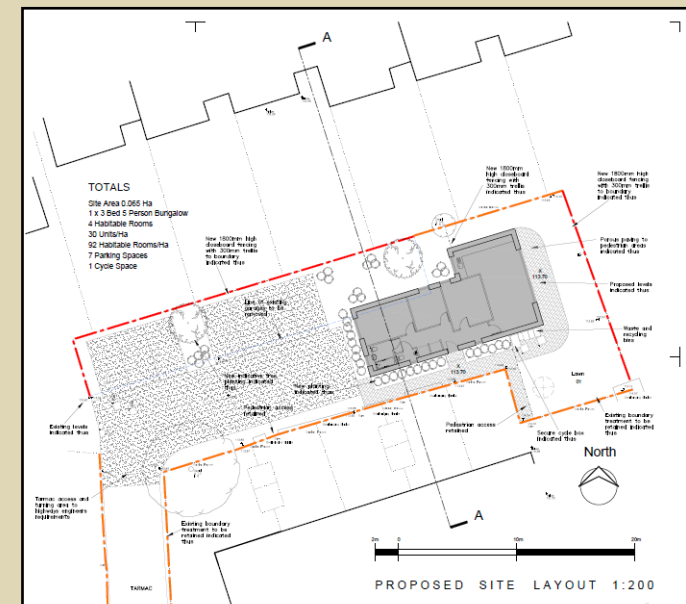

Location

The site is situated within an estate of mixed tenure housing mainly built in the 1950s/60s. The estate itself sits on the edge of Southborough adjoining open countryside with regular bus services to Southborough, Tunbridge Wells and Tonbridge town centres. Southborough centre is approx. 0.5 mile providing good shopping facilities and easy access to Tunbridge Wells and Tonbridge High Streets providing excellent shopping, sporting and recreational facilities as well as varied schools for all ages.

The A26 trunk road joins into the A21 approx. 2.5 miles to the north giving access to London via the M25.

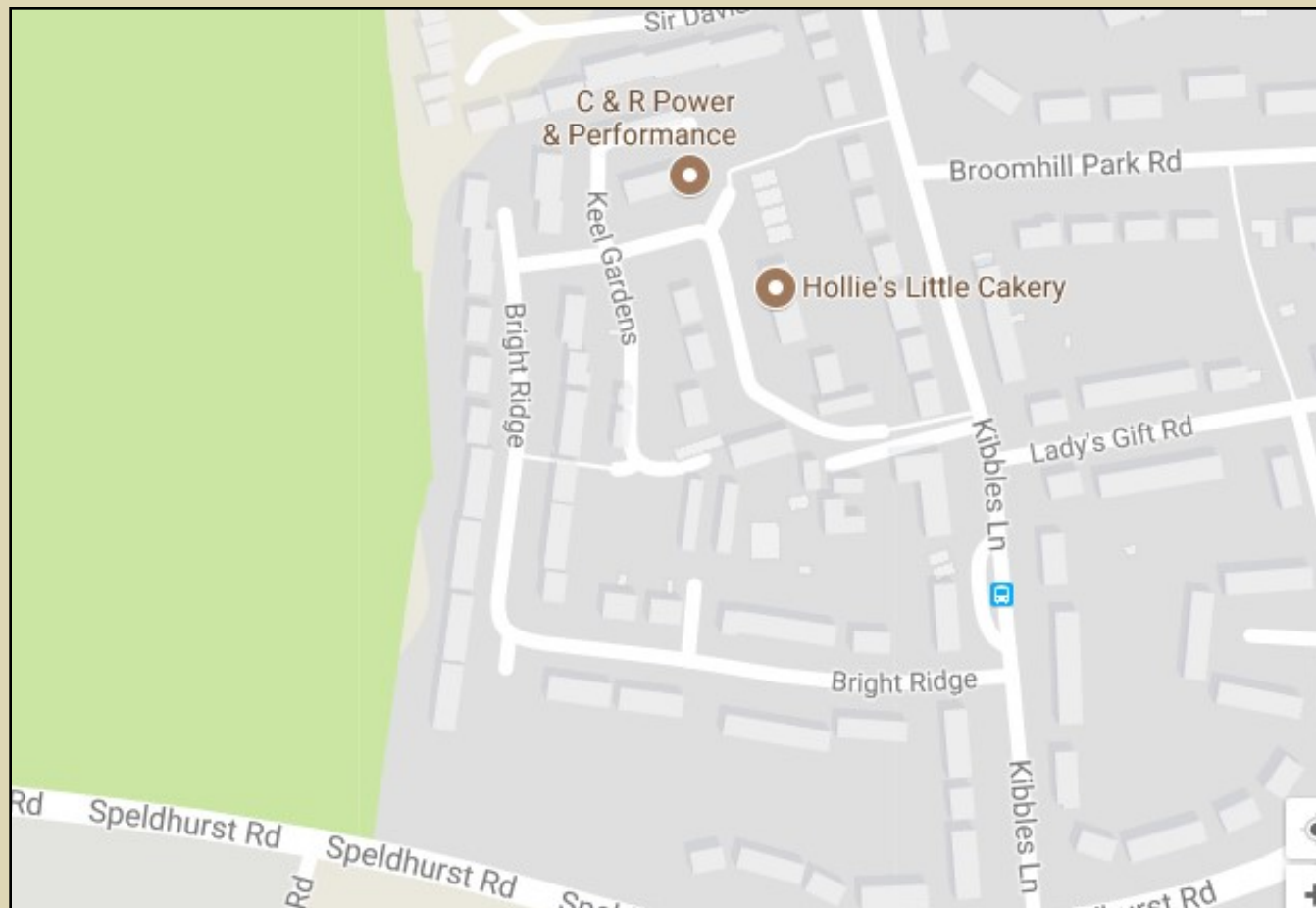

Planning

Detailed planning consent has been granted by Tunbridge Wells Borough Council under ref. nos. 17/00372/FULL and dated 6th April 2017 for the demolition of the existing garages and the erection of one 3 bedroom bungalow with 7 parking spaces.

Tenure

The site is to be sold freehold with vacant possession on completion

Price

Offers invited in the region of £100,000, subject to contract

Method of Sale

Interested parties should make any offer for the site on a subject to contract basis by no later than noon on Friday 17th November 2017. Owners reserve the right not to accept the highest offer or indeed any offers

Services

Intending purchasers should make their own enquiries in respect of availability and capacity of services

Viewings

The site may be viewed at any reasonable time during daylight hours

Agent Details

For further information please contact:

Peter Randall

01732 363633

West Kent

RPC Land & New Homes

158 High Street

Tonbridge

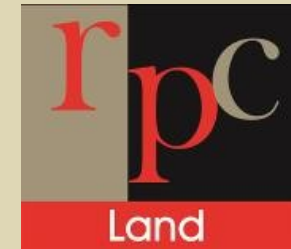

Misrepresentation Clause

RPC Land & New Homes for themselves and for the vendors of this property for whom they act, give notice that:

These particulars are prepared only for the guidance of prospective purchasers. They are intended to give a fair overall description of the property but do not constitute the whole or any part of an offer or contract. RPC Land & New Homes undertake to comply with the terms of the Property Misdescriptions Act 1991 but prospective purchasers must satisfy themselves as to the accuracy of the contents of these particulars, and RPC Land & New Homes will not be liable in negligence for any loss arising from the use of these particulars.

Any information contained herein (whether in the text, plans or photographs) is given in good faith but RPC Land & New Homes cannot guarantee the accuracy of any description, dimensions, references to condition, necessary permissions for use and occupation or any other details contained therein, nor should any information contained herein be relied upon as a statement or representation of fact. Prospective purchasers or tenants must satisfy themselves as to the accuracy of all information contained in these particulars.

Prices and rents quoted in these particulars may be subject to VAT in addition.

Nothing in these particulars shall be deemed to be a statement that the property is in good condition or otherwise, and reference to any plant, machinery, equipment, services, fixtures or fittings at the property shall not constitute a representation as to its state or condition or that it is capable of fulfilling its intended function. Prospective purchasers should satisfy themselves as to the fitness of such items for their requirements.

The photographs appearing in this brochure show only certain parts and aspects of the property. Certain aspects of the property may have changed since the photographs were taken and it should not be assumed that the property remains precisely as displayed in the photographs. It should not be assumed that everything shown in the photographs is included in the sale of the property. Furthermore no assumptions should be made in respect of parts of the property which are not shown in the photographs.

Any reference in these particulars to the fact that alterations have been carried out or that a particular use is made of any part of the property is not intended to be a statement that any necessary planning, building regulations or other consents have been obtained and these matters must be verified by any intending purchaser.

No employee of RPC Land & New Homes has any authority to make or give any representation or warranty whatsoever in relation to the property.