

R (Forge Field Society) v Sevenoaks District Council [2014] EWHC 1895 (Admin).

Palmer v Herefordshire Council & Anor [2016] EWCA Civ 1061.

Barnwell Manor Wind Energy Ltd v (1) East Northamptonshire DC & Others [2014] EWCA Civ 137.

Jones v Mordue [2015] EWCA Civ 1243.

Cartographic Sources

1840	Sholden Tithe Map
1872	Ordnance Survey Map (1:2,500)
1877	Ordnance Survey Map (1:10,560)
1898	Ordnance Survey Map (1:2,500)
1899	Ordnance Survey Map (1:10,560)
1906	Ordnance Survey Map (1:2,500)
1907-8	Ordnance Survey Map (1:10,560)
1937-8	Ordnance Survey Map (1:2,500)
1938	Ordnance Survey Map (1:10,560)
1958	Ordnance Survey Map (1:2,500)
1960	Ordnance Survey Map (1:10,560)
1971	Ordnance Survey Map (1:2,500)
1973	Ordnance Survey Map (1:10,000)

1981-7 Ordnance Survey Map (1:10,000)

Appendix 1: Gazetteer of Heritage Data

Heritage Data

HER Event Data

EvUID	RecordType	Name	EventTypes
EKE13282	NON	Desk based assessment of land to the north-west of Sholden	DESK BASED ASSESSMENT
EKE4750	INT	HULL PLACE PARK	EXCAVATION
EKE4877	INT	Hull Place, Sholden sewer scheme watching brief	WATCHING BRIEF
EKE5011	INT	Sholden, Deal proposed site of new Safeways store	EVALUATION
EKE16915	INT	Excavation & watchig brief, London Road, Sholden 2013	EXCAVATION; WATCHING BRIEF

HER Monument Data

MonUID	RecordType	PrefRef	Name	MonType	PeriodRang
MKE15886	MON	TR 35 SE 366	Roman ditches, Sholden, field adjacent to London Road	DITCH; DITCH	Roman
MKE17325	MON	TR 35 SE 393	Roman remains found during sewerage watching brief at Hull Place, Sholden	PIT; DITCH; GULLY	Roman
MKE26733	LB	TR 35 SE 474	HULL PLACE	SITE; HOUSE; OUTBUILDING; HOUSE; HOUSE; STEPS; RAILINGS	Post Medieval to Modern
MKE26734	LB	TR 35 SE 464	GATES GATE PIERS AND WALL ABOUT 30 METRES NORTH EAST OF HULL PLACE	SITE; GATE; GATE PIER; WALL; RAILINGS; RAILINGS; WALL; GATE PIER; GATE	Post Medieval to Modern
MKE26735	LB	TR 35 SE 476	STABLE BLOCK AND THE COACH HOUSE ABOUT 50 METRES NORTH WEST OF HULL PLACE	SITE; STABLE; STABLE; DATE STONE; STABLE; HOUSE	Post Medieval

MKE26762	LB	TR 35 SE 481	CHURCH OF ST NICHOLAS	CHURCH; SITE; PARISH CHURCH; PARISH CHURCH; COMMEMORATIVE MONUMENT; PLAQUE; PARISH CHURCH	Medieval to Post Medieval
MKE27002	LB	TR 35 SE 519	THE DOWER HOUSE	SITE; HOUSE; SCHOOL	Post Medieval
MKE27003	LB	TR 35 SE 520	SHOLDEN HALL	SITE; HOUSE; HOUSE; HOSPITAL	Post Medieval to Modern
MKE62930	FS	MKE62930	Iron Age copper alloy coin	FINDSPOT	Late Iron Age
MKE63858	FS	MKE63858	Medieval silver coin	FINDSPOT	Medieval
MKE64030	FS	MKE64030	Medieval copper alloy figurine	FINDSPOT	Medieval
MKE64063	FS	MKE64063	Early Medieval copper alloy brooch	FINDSPOT	Early Medieval or Anglo-Saxon
MKE64064	FS	MKE64064	Early Medieval copper alloy brooch	FINDSPOT	Early Medieval or Anglo-Saxon
MKE64065	FS	MKE64065	Early Medieval copper alloy brooch	FINDSPOT	Early Medieval or Anglo-Saxon
MKE64108	FS	MKE64108	Early Medieval copper alloy brooch	FINDSPOT	Early Medieval or Anglo-Saxon
MKE64130	FS	MKE64130	Early Medieval copper alloy brooch	FINDSPOT	Early Medieval or Anglo-Saxon
MKE64142	FS	MKE64142	Iron Age copper alloy coin	FINDSPOT	Late Iron Age
MKE64154	FS	MKE64154	Iron Age copper alloy coin	FINDSPOT	Late Iron Age
MKE64453	FS	MKE64453	Medieval copper alloy key (locking)	FINDSPOT	Medieval
MKE65717	FS	MKE65717	Iron Age copper alloy coin	FINDSPOT	Iron Age
MKE66070	FS	MKE66070	Iron Age copper alloy coin	FINDSPOT	Iron Age
MKE66072	FS	MKE66072	Iron Age copper alloy coin	FINDSPOT	Iron Age
MKE66301	FS	MKE66301	Iron Age copper alloy coin	FINDSPOT	Iron Age
MKE7306	MON	TR 35 SE 4	Sholden Roman Villa	DITCH; PIT; VILLA	Roman
MKE7409	MON	TR 35 SE 108	Five ring ditches	RING DITCH	Unknown
MKE7410	MON	TR 35 SE 109	Ring ditches	RING DITCH	Unknown
MKE7414	MON	TR 35 SE 113	Cropmark of a barrow cemetery	BARROW CEMETERY	Unknown
MKE7415	MON	TR 35 SE 114	Cropmark of an enclosure	ENCLOSURE	Unknown
MKE7483	MON	TR 35 SW 70	Cropmarks of 6 ring ditches, to the west of Sholden	RING DITCH	Unknown

MKE76263	MON	TR 35 SW 359	Cropmark of a linear feature, to the north-west of Sholden	LINEAR FEATURE	Unknown
MKE76264	MON	TR 35 SE 839	Cropmark of an enclosure, to the north-west of Sholden	ENCLOSURE	Unknown
MKE76265	MON	TR 35 SW 360	Cropmark of an enclosure, to the north-west of Sholden	ENCLOSURE	Unknown
MKE78372	MON	TR 35 SW 384	Goal post enclosure, west of Sholden	GOAL POST ENCLOSURE	Unknown
MKE80378	MON	TR 35 SE 855	Cropmark of linear feature to the south west of Sholden	LINEAR FEATURE	Unknown
MKE87042	FRM	MKE87042	Outfarm in Sholden	FARMSTEAD	Post Medieval
MKE87043	FRM	MKE87043	Farmstead in Sholden	FARMSTEAD	Post Medieval
MKE87044	FRM	MKE87044	Hull Place (Hull House)	FARMSTEAD	Post Medieval
MKE87045	FRM	MKE87045	The Dower House	FARMSTEAD	Post Medieval
MKE88978	FRM	MKE88978	Sholden Farm	FARMSTEAD	Post Medieval
MKE88979	FRM	MKE88979	Farmstead in Sholden	FARMSTEAD	Post Medieval
MKE88980	FRM	MKE88980	Farmstead west of Sholden Farm	FARMSTEAD	Post Medieval
MKE91260	MON	TR 35 SW 450	Cropmark of a ring ditch, to the west of Sholden	RING DITCH	Unknown
MKE95021	FS	MKE95021	Copper alloy buckle	FINDSPOT	Medieval
MKE95229	FS	MKE95229	Copper alloy harness fitting	FINDSPOT	Unknown
MKE95230	FS	MKE95230	Copper alloy key (locking)	FINDSPOT	Unknown
MKE95231	FS	MKE95231	Lead token	FINDSPOT	Unknown
MKE95232	FS	MKE95232	Copper alloy coin	FINDSPOT	Roman
MKE95233	FS	MKE95233	Copper alloy lace tag	FINDSPOT	Unknown
MKE95234	FS	MKE95234	Copper alloy strap end	FINDSPOT	Unknown
MKE95235	FS	MKE95235	Copper alloy coin weight	FINDSPOT	Medieval to Post Medieval
MKE95236	FS	MKE95236	Silver coin	FINDSPOT	Post Medieval to Unknown
MKE95237	FS	MKE95237	Copper alloy buckle	FINDSPOT	Medieval to Post Medieval
MKE95238	FS	MKE95238	Copper alloy strap end	FINDSPOT	Unknown
MKE95250	FS	MKE95250	Copper alloy coin	FINDSPOT	Roman
MKE95273	FS	MKE95273	Silver coin	FINDSPOT	Post Medieval
MKE95274	FS	MKE95274	Silver coin	FINDSPOT	Medieval

MKE95275	FS	MKE95275	Copper alloy jetton	FINDSPOT	Post Medieval
MKE95284	FS	MKE95284	Copper alloy coin	FINDSPOT	Roman
MKE95285	FS	MKE95285	Copper alloy coin	FINDSPOT	Middle Iron Age to Late Iron Age
MKE95286	FS	MKE95286	Copper alloy coin	FINDSPOT	Middle Iron Age to Late Iron Age
MKE95287	FS	MKE95287	Copper alloy coin	FINDSPOT	Middle Iron Age
MKE95288	FS	MKE95288	Copper alloy coin	FINDSPOT	Middle Iron Age to Late Iron Age
MKE95295	FS	MKE95295	Copper alloy coin	FINDSPOT	Post Medieval to Unknown
MKE95382	FS	MKE95382	Copper alloy coin	FINDSPOT	Post Medieval
MKE95385	FS	MKE95385	Silver coin	FINDSPOT	Medieval
MKE97756	BLD	TR 35 SE 10	Milestone Sandwich Road, Sholden	MILESTONE	Unknown
MKE98151	BLD	TR 35 SE 904	VAD Hospital Sholden Hall, London Road, Deal	HOSPITAL	Modern
MKE101242	FS	MKE101242	POST MEDIEVAL Copper alloy BUCKLE	FINDSPOT	Post Medieval
MKE101243	FS	MKE101243	POST MEDIEVAL Copper alloy BUCKLE	FINDSPOT	Post Medieval
MKE101244	FS	MKE101244	MEDIEVAL Copper alloy BUCKLE	FINDSPOT	Medieval to Post Medieval
MKE101245	FS	MKE101245	MEDIEVAL Lead TOKEN	FINDSPOT	Medieval to Post Medieval
MKE101246	FS	MKE101246	POST MEDIEVAL Copper alloy BUCKLE	FINDSPOT	Post Medieval
MKE101249	FS	MKE101249	POST MEDIEVAL Copper alloy WEIGHT	FINDSPOT	Post Medieval
MKE101250	FS	MKE101250	MEDIEVAL Copper alloy BUCKLE	FINDSPOT	Medieval
MKE101251	FS	MKE101251	BRONZE AGE Copper alloy SOCKETED AXEHEAD	FINDSPOT	Late Bronze Age
MKE101252	FS	MKE101252	IRON AGE Copper alloy COIN	FINDSPOT	Middle Iron Age
MKE101253	FS	MKE101253	MEDIEVAL Copper alloy BUCKLE	FINDSPOT	Medieval
MKE101254	FS	MKE101254	POST MEDIEVAL Copper alloy TOKEN	FINDSPOT	Post Medieval
MKE101255	FS	MKE101255	MEDIEVAL Copper alloy BUTTON	FINDSPOT	Medieval to Post Medieval
MKE101256	FS	MKE101256	POST MEDIEVAL Copper alloy STRAP FITTING	FINDSPOT	Post Medieval
MKE102153	FS	MKE102153	Lead TOKEN	FINDSPOT	Medieval to Post Medieval
MKE102154	FS	MKE102154	POST MEDIEVAL Silver COIN	FINDSPOT	Post Medieval

MKE110692	MON	TR 35 SE 920	Roman trackway, pits and cremation, London Road, Sholden	TRACKWAY; PIT; ANIMAL BURIAL; DITCH; CREMATION BURIAL	Roman
MKE112814	FS	MKE112814	Post Medieval silver coin	FINDSPOT	Medieval
MKE112815	FS	MKE112815	Iron Age copper alloy coin	FINDSPOT	Middle Iron Age to Late Iron Age
MKE112816	FS	MKE112816	Post Medieval copper alloy mount	FINDSPOT	Post Medieval
MKE112827	FS	MKE112827	Modern lead unidentified object	FINDSPOT	Post Medieval to Modern
MKE112829	FS	MKE112829	Post Medieval silver coin	FINDSPOT	Post Medieval
MKE112831	FS	MKE112831	Medieval silver coin	FINDSPOT	Medieval
MKE112832	FS	MKE112832	Post Medieval copper alloy coin	FINDSPOT	Post Medieval

Historic England Data

Historic England Listed Buildings

List Entry	Name	Grade	Easting	Northing
1069743	THE RECTORY	II	636259	151824.3608
1069755	GRAVESTONE/CROSS IMMEDIATELY SOUTH WEST OF TOWER OF CHURCH OF ST MARTIN	II	634605.187	151489.7428
1069757	WALLED GARDEN AT THE MANOR HOUSE TO SOUTH WEST OF HOUSE	II	635105.65	151534.5108
1069775	BREWER'S FARMHOUSE	II	635080.202	151580.4288
1069776	MANOR FARM HOUSE	II	635105.202	151558.6888
1069781	STONE HALL	II	634992.306	151631.4218
1069782	CHURCH OF ST MARTIN	II*	634618.893	151504.5628
1069817	MILESTONE HOUSE	II	636510	152042.3608
1069818	JENKIN'S WELL	II	636224	151920.3608
1069819	MANOR HOUSE COTTAGE	II	636425	151774.3608
1069820	THE ADMIRAL KEPPEL INN	II	636292	151883.3608
1069821	NORMAN HOUSE	II	636281	151890.3608
1069822	98, MANOR ROAD	II	636258.357	151904.8638
1069824	302, MIDDLE DEAL ROAD	II	636477	152155.3608
1069832	BARN AT HILLSIDE FARM	II	635046.168	151305.8688

1069855	GREAT MONGEHAM FARMHOUSE	II	634660.926	151283.4238
1069857	IVY COTTAGES	II	636410	152048.3608
1069858	REDOURY COTTAGE	II	635010.716	151362.5738
1069859	IVY HOUSE	II	635000.378	151346.9808
1237019	COTTINGTON COURT FARMHOUSE	II	635040.546	153338.5418
1237020	WALL AND OUTBUILDING ABOUT 25 METRES SOUTH OF COTTINGTON COURT FARMHOUSE	II	635030.536	153311.4058
1237023	HULL PLACE	II	635689.24	152787.7138
1237024	GATES GATE PIERS AND WALL ABOUT 30 METRES NORTH EAST OF HULL PLACE	II	635705.669	152809.9728
1237025	STABLE BLOCK AND THE COACH HOUSE ABOUT 50 METRES NORTH WEST OF HULL PLACE	II	635638	152842.3608
1237026	TOMB CHEST AND HEADSTONE ABOUT 1+5 METRES EAST OF CHURCH OF ST NICHOLAS	II	635938.197	152162.8998
1237584	CHURCH OF ST NICHOLAS	II*	635923.847	152170.0748
1253759	HOLLY FARM	II	636333	151861.3608
1253762	94 AND 96, MANOR ROAD	II	636273	151895.3608
1254092	110, MONGEHAM ROAD	II	635376.653	151806.0038
1261480	112, MONGEHAM ROAD	II	635370.941	151797.1188
1261528	TORMORE SCHOOL	II	636205	151797.3608
1261551	CHURCH HOUSE	II	634696.595	151495.9838
1261552	THE OLD RECTORY	II	634604.283	151536.5148
1261619	EYTHORNE COTTAGE	II	636340	152023.3608
1261645	285-293, LONDON ROAD	II	636345	151975.3608
1264004	TOMB CHEST AND VAULT AND HEADSTONE ABOUT 2 AND 5 METRES NORTH OF CHURCH OF ST NICHOLAS	II	635935.058	152169.6268
1264295	THE DOWER HOUSE	II	635760	152790.3608
1264296	SHOLDEN HALL	II	635831.242	152145.8588
1343693	HOUSE ADJOINING NO 98 ON CORNER OF MANOR ROAD AND LONDON ROAD	II	636259.07	151913.0688
1343697	CHURCH OF ST LEONARDS	II*	636267	151853.3608
1343698	COURT HOUSE	II	636216	151842.3608
1343714	GREAT MONGEHAM HOUSE	II	634638.541	151461.9828
1363450	HILLSIDE FARMHOUSE	II	635066.311	151319.8438
1363460	226 AND 228, MONGEHAM ROAD	II	635014.144	151289.1298

1363462	THE COTTAGE	II	636718	152290.3608
1393876	K6 TELEPHONE KIOSK	II	636226.253	151899.8408

Historic England Registered Parks and Gardens

List Entry	Name	Grade	Easting	Northing
1000180	NORTHBOURNE COURT	II*	633787.3179	152295.5839

Appendix 2: Findspots recorded in the study area

Findspots of Iron Age date:

- Two copper alloy coins within the site (MKE66070, 66072);
- Copper alloy coin c. 90m north of the site (MKE64142);
- Copper alloy coin c. 120m north-west of the site (MKE112815);
- Copper alloy coin c. 150m west of the site (MKE62930);
- Copper alloy coin c. 170m south of the site (MKE66072);
- Copper alloy coin c. 190m north of the site (MKE65717);
- Copper alloy coin c. 195m north of the site (MKE64154);
- Copper alloy socketed axehead c. 205m north-west of the site (MKE101251);
- Copper alloy coin c. 215m north-west of the site (MKE101252);
- Copper alloy coin c. 290m north-west of the site (MKE95285);
- Copper alloy coin c. 300m north-west of the site (MKE95288);

- Copper alloy coin c. 345m west of the site (MKE63463);
- Copper alloy coin c. 365m north-west of the site (MKE95286);
- Copper alloy coin c. 365m south-west of the site (MKE66070);
- Copper alloy coin c. 365m north-west of the site (MKE95287); and
- Silver coin c. 440m east of the site (MKE65853).

Findspots of Romano-British date:

- Coin c. 255m north-west of the site (MKE95232);
- Coin c. 270m north-west of the site (MKE95284); and
- Coin c. 300m north-west of the site (MKE95250).

Findspots of early medieval and medieval date:

- Copper alloy brooch c. 255m south of the site (MKE64064);
- Copper alloy brooch c. 315m south of the site (MKE64063);
- Copper alloy button c. 40m north of the site (MKE101255);
- Copper alloy brooch c. 75m west of the site (MKE64130);

- Silver coin c. 140m west of the site (MKE112814);
 - Copper alloy brooch c. 190m west of the site (MKE64065);
 - Lead token c. 220m north-west of the site (MKE101245);
 - Silver coin c. 225m north-west of the site (MKE95274);
 - Silver coin c. 230m north-west of the site (MKE112831);
 - Copper alloy buckle c. 240m west of the site (MKE95237);
 - Copper alloy buckle c. 245m north-west of the site (MKE101253);
 - Lead token c. 270m north-west of the site (MKE102153);
 - Copper alloy key c. 285m south-east of the site (MKE64453);
 - Copper alloy buckle c. 285m north-west of the site (MKE101250);
 - Copper alloy buckle c. 305m north-west of the site (MKE101244);
 - Silver coin c. 365m west of the site (MKE95385);
 - Silver coin c. 415m north of the site (MKE63858);
 - Copper alloy figurine c. 440m north-west of the site (MKE64030);
 - Copper alloy buckle c. 455m north-west of the site (MKE95021);
 - Copper alloy coin weight c. 460m west of the site (MKE95235); and
 - Copper alloy brooch c. 470m south-west of the site (MKE64108).
- Findspots of post-medieval to modern date:
- Copper alloy strap fitting c. 15m north of the site (MKE101256);
 - Lead unidentified object c. 150m north-west of the site (MKE112827);
 - Copper alloy mount c. 180m north-west of the site (MKE112816);
 - Copper alloy buckle c. 185m north-west of the site (MKE101242);
 - Copper alloy token c. 215m north-west of the site (MKE101254);
 - Copper alloy buckle c. 235m north-west of the site (MKE101243);
 - Copper alloy buckle c. 235m north-west of the site (MKE101246);
 - Copper alloy buckle c. 235m north-west of the site (MKE101249);
 - Silver coin c. 265m north-west of the site (MKE112829);
 - Silver coin c. 270m north-west of the site (MKE95236);

- Silver coin c. 270m north-west of the site (MKE102154);
- Copper alloy coin c. 280m north-west of the site (MKE112832); and
- Copper alloy jetton c. 290m north-west of the site (MKE95275).
- Silver coin c. 295m north-west of the site (MKE95273);
- Copper alloy coin c. 345m north of the site (MKE95295); and
- Copper alloy coin c. 405m north-west of the site (MKE95382).
- Copper alloy strap end c. 240m west of the site (MKE95238);
- Copper alloy lace tag c. 245m west of the site (MKE95233);
- Copper alloy harness fitting c. 275m north-west of the site (MKE95229);
- Copper alloy key c. 275m north-west of the site (MKE95230);
- Lead token c. 280m north-west of the site (MKE95231); and
- Copper alloy strap end c. 295m north-west of the site (MKE95234).

Findspots of uncertain date:

Appendix 3: Designation Descriptions

CHURCH OF ST MARTIN

Overview

Heritage Category:
Listed Building

Grade:
II*

List Entry Number:
1069782

Date first listed:
01-Jun-1949

Date of most recent amendment:
08-Feb-1974

Statutory Address:
CHURCH OF ST MARTIN, NORTHBOURNE ROAD

Map



© Crown Copyright and database right 2020. All rights reserved. Ordnance Survey Licence number 100024900.

© British Crown and SeaZone Solutions Limited 2020. All rights reserved. Licence number 102006.006.

Use of this data is subject to [Terms and Conditions](https://historicengland.org.uk/terms/website-terms-conditions/) (<https://historicengland.org.uk/terms/website-terms-conditions/>).

The above map is for quick reference purposes only and may not be to scale. For a copy of the full scale map, please see the attached PDF -

[1069782.pdf](#)

(http://mapservices.HistoricEngland.org.uk/printwebservicehle/StatutoryPrint.svc/428330/HLE_A4L_Grade|HLE_A3L_Grade.pdf)

The PDF will be generated from our live systems and may take a few minutes to download depending on how busy our servers are. We apologise for this delay.

This copy shows the entry on 18-Dec-2020 at 16:11:39.

Location

Statutory Address:

CHURCH OF ST MARTIN, NORTHBOURNE ROAD

The building or site itself may lie within the boundary of more than one authority.

County:

Kent

District:

Dover (District Authority)

Parish:

Great Mongeham

National Grid Reference:

TR 34619 51504

Details

GREAT MONGEHAM

860/6/150 NORTHBOURNE ROAD 01-JUN-49 Church of St Martin (Formerly listed as: NORTHBOURNE ROAD CHURCH OF ST MARTIN) (Formerly listed as: CHURCH HILL CHURCH OF ST MARTIN)

II*

Parish church. C12, C13, C14 and C15, much restored by William Butterfield in 1851. Built of flint with stone quoins and dressings and plaintiled roofs. Nave with north and south aisles and clerestorey, chancel with chapels, and west tower. Four stage Perpendicular West tower with buttresses and crenellated parapet. Norman window to west half of north chapel shows early origin of church but aisled nave and chancel with chapels are early C13 restored circa 1851 with south aisle rebuilt by Butterfield. C14 nave clerestorey. North Porch with tiled roof. Some pre-Butterfield lancets in south chapel. Traceried windows and some double lancets. Chancel and north chapel have east windows of 1861. INTERIOR: Three bay arcades with rectangular piers and pointed arches both slightly chamfered. Restored Crown post roof. Roof has panels with quatrefoil carving. Perpendicular tower screen. C13 piscina and 2 sedilia. Jacobean wall monument to Edward Crayford Esq, d.1615. Pulpit of 1851, probably by Butterfield. Chancel furnishings also Butterfield.

[Buildings of England "North East and East Kent" ps 338-339.]

Listing NGR: TR3461951504

Legacy

The contents of this record have been generated from a legacy data system.

Legacy System number:

177235

Legacy System:

LBS

Sources

Books and journals

Pevsner, N, Newman, J, The Buildings of England: Kent III, (1983), 338-9

Legal

This building is listed under the Planning (Listed Buildings and Conservation Areas) Act 1990 as amended for its special architectural or historic interest.

End of official listing

NORTHBOURNE COURT

Overview

Heritage Category:
Park and Garden

Grade:
II*

List Entry Number:
1000180

Date first listed:
01-May-1986

Map

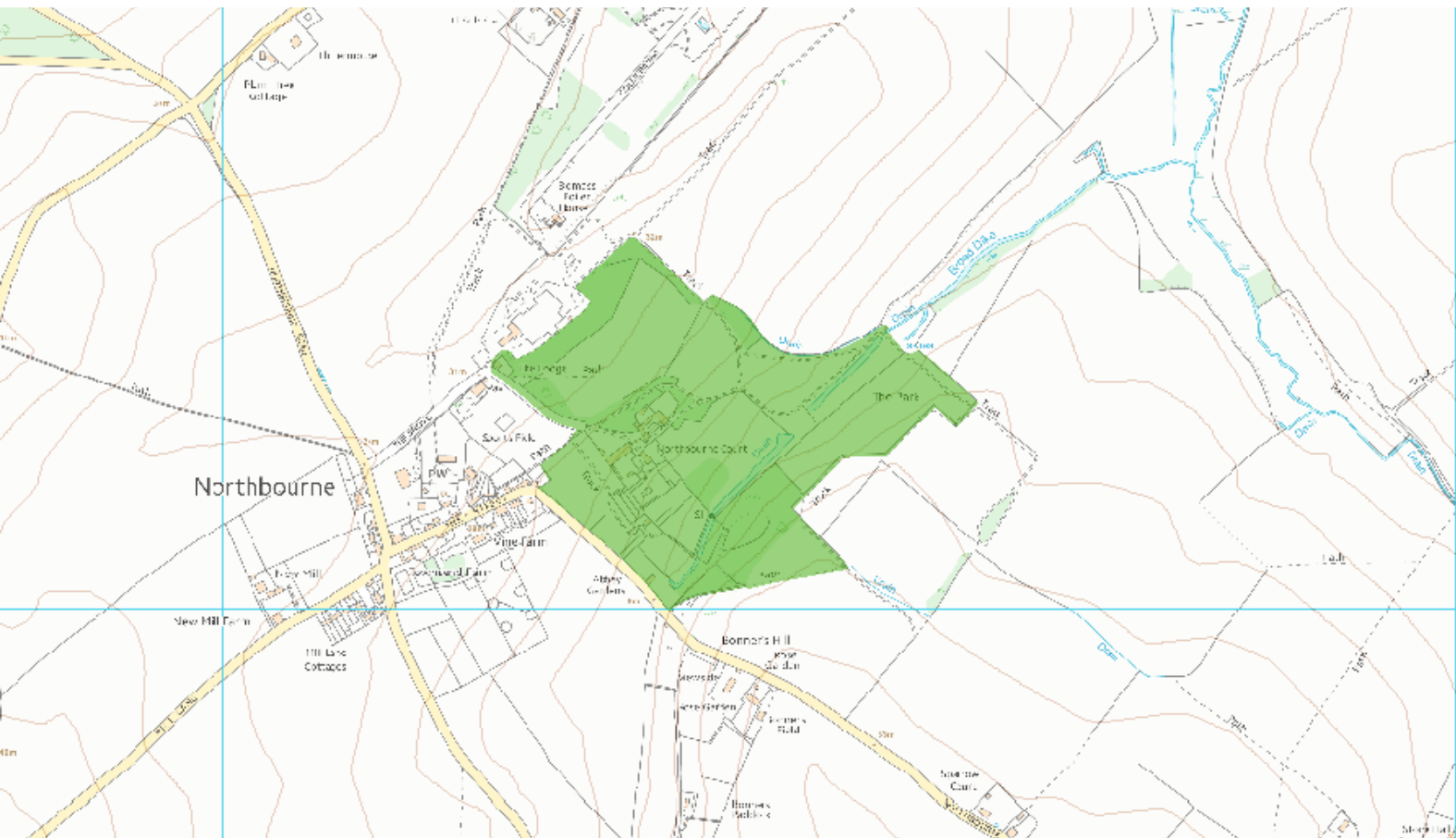

© Crown Copyright and database right 2020. All rights reserved. Ordnance Survey Licence number 100024900.

© British Crown and SeaZone Solutions Limited 2020. All rights reserved. Licence number 102006.006.

Use of this data is subject to [Terms and Conditions](https://historicengland.org.uk/terms/website-terms-conditions/) (<https://historicengland.org.uk/terms/website-terms-conditions/>).

The above map is for quick reference purposes only and may not be to scale. For a copy of the full scale map, please see the attached PDF -

[1000180.pdf](#)

(http://mapservices.HistoricEngland.org.uk/printwebservicehle/StatutoryPrint.svc/216/HLE_A4L_Grade|HLE_A3L_Grade.pdf)

The PDF will be generated from our live systems and may take a few minutes to download depending on how busy our servers are. We apologise for this delay.

This copy shows the entry on 18-Dec-2020 at 16:11:42.

Location

The building or site itself may lie within the boundary of more than one authority.

County:

Kent

District:

Dover (District Authority)

Parish:

Great Mongeham

County:

Kent

District:

Dover (District Authority)

Parish:
Northbourne

National Grid Reference:
TR 33829 52264

Details

A late C16 or early C17 walled garden with formal terraces, with an adjacent C19 park.

HISTORIC DEVELOPMENT

Northbourne belonged to Eadbald, a Saxon king of Kent who in AD 618 gave the Manor and land to the Abbot of St Augustine's, Canterbury, in whose ownership it was still recorded in Domesday Book. Northbourne Manor became Crown property at the Dissolution and in 1540 Henry VIII gave it in exchange for other property to Archbishop Cranmer. It reverted to the Crown and was gifted to new owners on two further occasions: in 1561 by Queen Elizabeth to her foster brother, Edward Sanders, for his lifetime and in 1604 by James I to Sir Edwin Sandys, who built a mansion on the site and may have constructed the terraced gardens (CL 1925). Sir Edwin died in 1629 and Northbourne remained in the Sandys family until, on the death of Sir Richard Sandys in 1726, the terms of inheritance left the house unoccupied. It was pulled down in c 1750 and the estate sold by a representative of Sir Richard Sandys' daughters in 1795 (ibid). Northbourne had a number of subsequent owners until purchased in 1895 by the second Lord Northbourne. It remains (1997) in private hands.

DESCRIPTION

LOCATION, AREA, BOUNDARIES, LANDFORM, SETTING Northbourne Court lies adjacent to the east end of Northbourne village, c 1km west of the A258, Deal to Sandwich road. The 23ha registered site comprises c 3ha of formal and ornamental gardens and 20ha of parkland with small areas of woodland. It lies on the slopes and floor of a shallow valley which runs north-eastwards from the dip-slope of the North Downs to the levels of the Lydden valley, 4km distant. The site is bounded to the south-west by a high brick wall running beside the lane from Northbourne south-east to Great Mongeham (Bonners Lane) with, at its west end, village houses and a recreation ground. The north-west boundary is lined by the industrial-style buildings, yards and screen mounding of the Kent Salads factory which are built on the line of a road known as The Drove, while beyond this and beyond the north and east boundaries, land under intensive arable and horticultural cropping generally abuts the site, except for a narrow area of rough grazing and marshland which extends from the north-east boundary towards the Lydden valley.

ENTRANCES AND APPROACHES The formal approach to the house and gardens is from the north-west corner of the site, a drive curving 250m south-eastwards to the north-west front of the house from a lodge, shown established by 1871-2 (OS 1877), at the junction with The Drove. The public entrance to the gardens is from the south-west, on Bonners Lane, through a rusticated-stone carriage arch in the boundary wall hung with a set of C19 wrought-iron gates (wall and gateway listed grade II*); this may have formed the entrance to the site of an earlier house (CL 1925). A broad grass path lined with fruit trees runs 50m north-eastwards through a rectangular garden compartment extending nearly 200m uphill to the north-west and c 50m to the south-east, which is walled on all sides except the south-east. It is laid to meadow grass and, largely at the south-east end (shown established as an orchard in 1871-2, OS), groups of fruit trees. Brick piers in the north-east wall mark the gateway to the inner garden compartments; an early C17 red-brick stable and coach house (listed grade II) with Kentish Jacobean-style gables (CL 1925) stands on the north-west side of the gateway and immediately behind its north-west side, the high, buttressed south-west and south-east walls retaining the tiered terraces. To the south-east of the gateway is a two-storey, brick-built keeper's lodge.

PRINCIPAL BUILDINGS Northbourne Court (listed grade II) stands on the north-west slope of the valley, on a level platform overlooking the inner walled gardens. The house is of two storeys with an attic and hipped, tiled roof above a parapet and is built of red brick with flint and rubble in the rear elevation. It dates from the early and late C18, with extensions of c 1930 and is possibly built on part of the site of Sir Edwin Sandys' earlier mansion, demolished c 1750 (Hasted 1797-1801) and itself built on the site of a monastic grange of St Augustine's. It may, alternatively, be an adaptation of outbuildings associated with the early C17 mansion (CL 1925). Within 20-30m of the house, further ranges of buildings form an ensemble with it: to the north-east, a C17 red-brick and tile-roofed coach house, stables, and barn (extended and repaired in the C18 and C19 and listed grade II) form an open, south-east-facing courtyard while to the north-west a large, C17 red-brick barn on a flint base (listed grade II*) faces south-eastwards onto a walled and grassed former farmyard with further outbuildings.

GARDENS AND PLEASURE GROUNDS The gardens consist of a series of four walled compartments (all walls listed grade II) to the south, south-west, and west of the house. On its south-east, garden front, the house opens onto two levels of stone-paved terrace with low-growing silver and grey planting, enclosed on its north-east side by a brick wall (listed grade II) extending from the house and on its south-east side by the wall retaining the raised platform. In the south-west corner, a flagged path leads from the terrace through an open-sided brick loggia, converted from an outbuilding and giving views onto the garden compartment enclosure below, into a small, walled herb garden offering a view from a doorway in its south-east wall. From a path running along the north-east front of the house, a long flight of stone steps provides the main access down into the walled garden below. Its north-east end, enclosed largely by flint walls, is raised by a brick retaining wall to form a low, grassed platform flanked by a rose border

under the east wall and laid out with abundant herbaceous and shrub planting around remnants of flint walls, steps, and paving which may survive either from the former monastic grange and chapel or from the C17 mansion. The central area of the compartment, which may have formed the court of the mansion, is laid to lawn with a central rectangular lily pool built by 1937 on the site of a former fountain (OS). The south-west end of the compartment is enclosed by a massive, three-tier bank of brick-faced terraces, each c 8m deep with the top level standing some 9-10m above the lawned court and the two lower levels extending north-eastwards to form raised walks against the enclosing north-west and south-east walls of the compartment. The terraces, which form a viewing mount, were probably built by Sir Edwin Sandys in the early C17 (CL 1925) but possibly by his predecessor, Edward Sanders (guide leaflet). A grassed walk along the top terrace overlooking the outer, western, walled compartment, is flanked by a line of cypress trees (planted in the late C20 to replace former mature trees) which continues north-westwards in the compartment below as a 100m long avenue and vista, focused on a gateway in the north-west wall. The two lower terraces and their extended arms are also lined with grassed walks and are abundantly planted with varied mixed borders and edged with lavender. The terraces are connected to each other at each end and to the lawn below by flights of brick or stone steps.

A gateway and wrought-iron gates in the centre of the south-east wall leads into a further walled compartment, 80m x 30m, divided by a north/south central path and laid out at the south-west end as a flower, vegetable, and propagating garden. A wide grassed path flanked by mixed shrub borders running along the south-east edge of the compartment and terminating in a timber seat (now, 1997, in a ruinous state) forms a continuation of the axial path from the carriage arch in the outer, south-west wall. South-east of the kitchen garden is a further compartment, walled on all sides except the south-east where it is enclosed by woodland, containing a former canalised watercourse and sluice (now, 1997, dry), shown established on Mudge's map of Kent of 1801.

PARK The park lies to the north and north-east of the walled gardens, on the north-west and south-east slopes of the valley. The former watercourse running through the garden continues its north-eastward course through the park, its 8-10m wide channel, which opens into a mill pond 160m north-east of the gardens, shown in existence by 1871-2 (OS). Apart from a wide strip of land under arable cultivation on the north-west boundary, adjacent to the Kent Salads factory, the entire open parkland is laid to grazing and dotted with clumps, groups, and individual trees of mixed age and species including a group of mature holm oak 160m north-west of the house beside the drive and new trees planted following storm damage in 1987 to the north and north-east of the stable block. The parkland appears to have been laid out in the C19, between 1801 (it is not indicated on Mudge's map) and 1871-2 (OS), extending at that time 0.5km north-east of its present (1997) boundary.

Some 250m north-east of the house, the boundary of the park is marked by a sunk fence, on a line shown the OS 1st edition, the ditch containing a few remnants of a stone ha-ha wall. At the north-west end of the sunk fence the boundary continues to the course of The Drove through a narrow belt of woodland, established by 1871-2 (and partly replanted in the 1990s) which contains the site of a former lodge (gone by 1937, OS) serving a drive to the stables.

North-east of the kitchen garden wall a loose group of trees, including mature holm oaks, marks the site of a probable former pond (map and field evidence) shown in existence and enclosed by an ornamental tree belt in 1871-2 (OS). An overgrown circular brick bason with a central flint and masonry dome, 35m north-east of the garden wall, appear be surviving features of a former fountain, shown in existence by 1899 (OS).

REFERENCES

E Hasted, *The History and Topographical Survey of the County of Kent ... (1797-1801)* [Facsimile edn 1972] *Country Life*, 57 (13 June 1925), pp 954-61; 128 (11 August 1960), pp 278-9 J Newman, *The Buildings of England: West Kent and the Weald* (1969), p 392 T Wright, *The Gardens of Britain* 4, (1978), pp 73-6 *The Gardens of Northbourne Court*, guidebook, (nd)

Maps W Mudge, *Map of Kent*, 1" to 1 mile, 1801

OS 6" to 1 mile: 1st edition surveyed 1871-2, published 1877 2nd edition published 1899 3rd edition published 1906 OS 25" to 1 mile: 3rd edition published 1906 1937 edition

Description written: August 1997 Register Inspector: VCH Edited: November 2003

Legacy

The contents of this record have been generated from a legacy data system.

Legacy System number:

1085

Legacy System:

Parks and Gardens

Legal

This garden or other land is registered under the Historic Buildings and Ancient Monuments Act 1953 within the Register of Historic Parks and Gardens by Historic England for its special historic interest.

End of official listing

Don't have an account? Register [here](https://account.historicengland.org.uk/sign-in) (<https://account.historicengland.org.uk/sign-in>)

© Historic England 2020

CHURCH OF ST AUGUSTINE

Overview

Heritage Category:
Listed Building

Grade:
I

List Entry Number:
1264324

Date first listed:
11-Oct-1963

Statutory Address:
CHURCH OF ST AUGUSTINE, THE STREET

Map

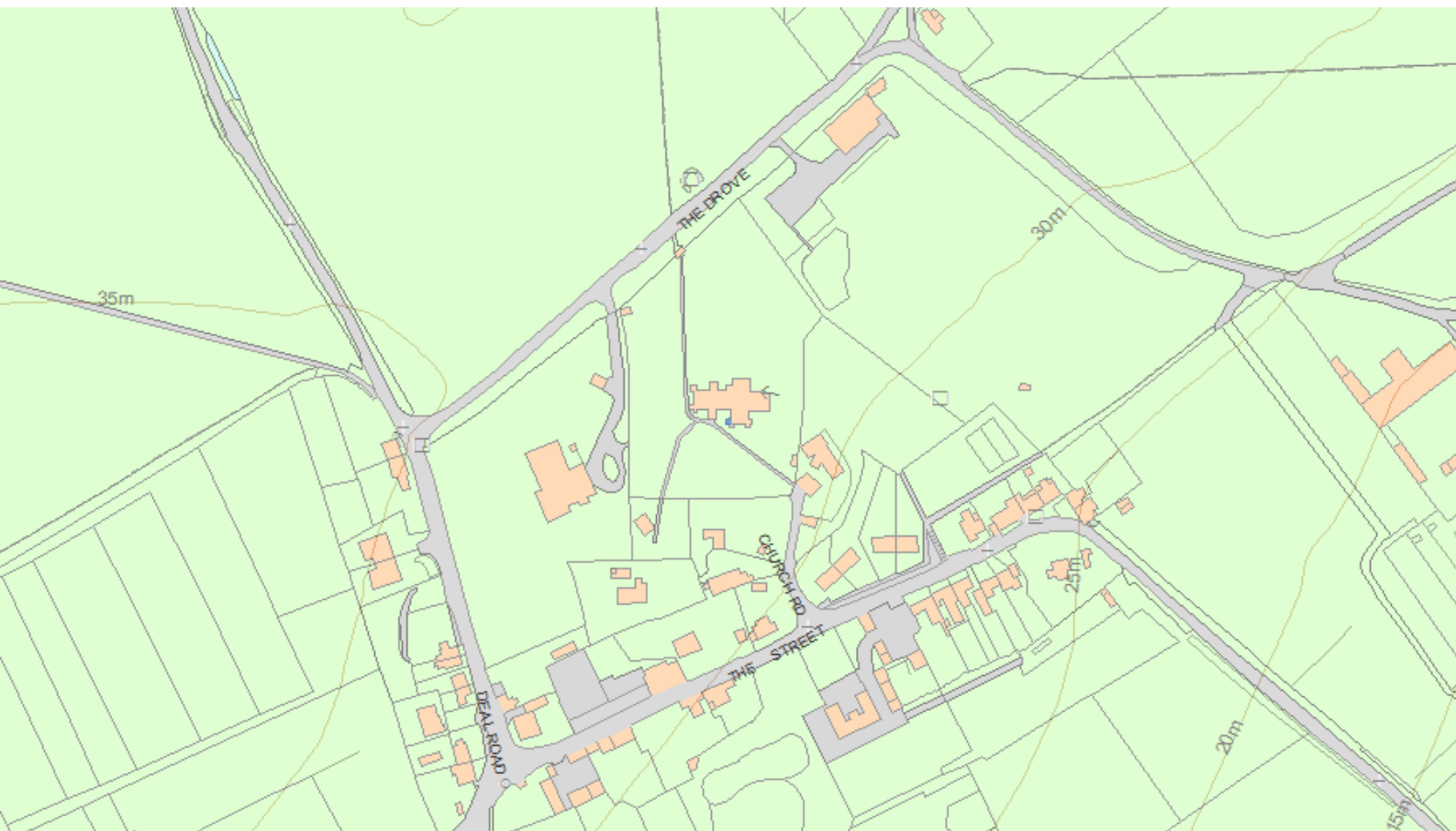

© Crown Copyright and database right 2020. All rights reserved. Ordnance Survey Licence number 100024900.

© British Crown and SeaZone Solutions Limited 2020. All rights reserved. Licence number 102006.006.

Use of this data is subject to [Terms and Conditions](https://historicengland.org.uk/terms/website-terms-conditions/) (<https://historicengland.org.uk/terms/website-terms-conditions/>).

The above map is for quick reference purposes only and may not be to scale. For a copy of the full scale map, please see the attached PDF -

[1264324.pdf](#)

(http://mapservices.HistoricEngland.org.uk/printwebservicehle/StatutoryPrint.svc/241623/HLE_A4L_Grade|HLE_A3L_Grade.pdf)

The PDF will be generated from our live systems and may take a few minutes to download depending on how busy our servers are. We apologise for this delay.

This copy shows the entry on 18-Dec-2020 at 16:11:50.

Location

Statutory Address:

CHURCH OF ST AUGUSTINE, THE STREET

The building or site itself may lie within the boundary of more than one authority.

County:

Kent

District:

Dover (District Authority)

Parish:

Northbourne

National Grid Reference:

TR 33364 52233

Details

NORTHBOURNE THE STREET TR 35 SW (north side)

4/34 Church of 11.10.63 St. Augustine

GVI

Parish church. C12, re-fenestrated C13 and early C14, with porches 1865. Flint with plain tiled roof. Cruciform with central tower and north and south porches. Squat central tower with bold quoins, string course and parapet and low spire. Massive raking buttresses, with tiled weathering, in re-entrant angles to transepts. West end with clasping buttress to north, and offset angle buttresses on south; simple chamfered west door with lancet over. South doorway with scallop capitals on nook shafts with zig-zag moulding and billet-moulded hood. Lancet windows through- out, except south transept, with bar tracery, much brick dressing and repair to east end. East window composition of lancet, with round headed lancet over and roundel with billet moulded surround over that. Interior: simple, tall nave with 4 steps up to west door, with original reveals of Romanesque lancets, the eastermost reveals of C13 pointed lancets. C19 roof with king posts and secondary crown posts to purlins. Blocked round headed recess to north east. Tower crossing arches with scalloped nook shafts with square responds and impostes with bold roll mould and zig-zag moulding. Chancel arch rebuilt pointed. Nave gable with window opening above crossing arch. Transepts with large lancets, that in south transept with inserted Y-tracery. Chancel with trefoil headed reveals to north and south lancets. Large pointed arched recess on east wall containing 2 tier lancets. The lower chancel wall is considerably thickened. Fittings: triangular headed piscina with crude shafts and drip. Chamfered elliptical sedile with 3 C19 seats. Aumbrey in north wall. Reredos, and other embellishments by J. F. Bentley 1865, of stone and alabaster, with tabernacle, quatrefoiled lozenges with evangelical symbols, attached shafts and stiffleaf enrichment. North and south wall with quatrefoil recesses also, recording the work done 1865 for the Hannam family. Polychrome tiles throughout the sanctuary. C19 corona lucis in south transept and crossing. Choir stalls incorporate C18 bead moulded panelling, more of which is in the south transept. Arms of George II in nave dated 1751. Two hatchments in south transept, and sculptural fragment, a C14 head of a king. Large areas of old floor tiles survive, especially in the south transept and the crossing. Monument: Sir Edwyn Sandys, erected prior to his death, 1628. Very large free standing monument in black marble and alabaster. He and his wife lie at different levels, hands clasped in prayer and in well executed if stiff pose, on pilastered chest with coats of arms. Deep columned recess with entablature, and curtains tied back, crowned with cartouche shields and large pedimented and draped achievement. Inner walls of recess with helm at head and gloves at feet, with 3 cherubs above. The rear wall carved with inscription plaque of 1830 and 2 awkward angels, probably of same date. Sir Edwyn, Elizabethan lawyer and courtier, built the house and surviving gardens at Northbourne Court, and drew up the constitution of the colony of Virginia, providing the model for the other North American States. The church was a possession of St. Augustine's Abbey, Canterbury, hence its dedication and scale. (See B.O.E. Kent II. 1983 406; see also Hasted, 1800, p.584).

Listing NGR: TR3344754059

Legacy

The contents of this record have been generated from a legacy data system.

Legacy System number:

428148

Legacy System:

LBS

Sources

Books and journals

Hasted, E, History and Topographical Survey of the County of Kent, (1800), 584

Newman, J, The Buildings of England: North East and East Kent, (1983), 406

Legal

This building is listed under the Planning (Listed Buildings and Conservation Areas) Act 1990 as amended for its special architectural or historic interest.

End of official listing

Appendix 4: Figures

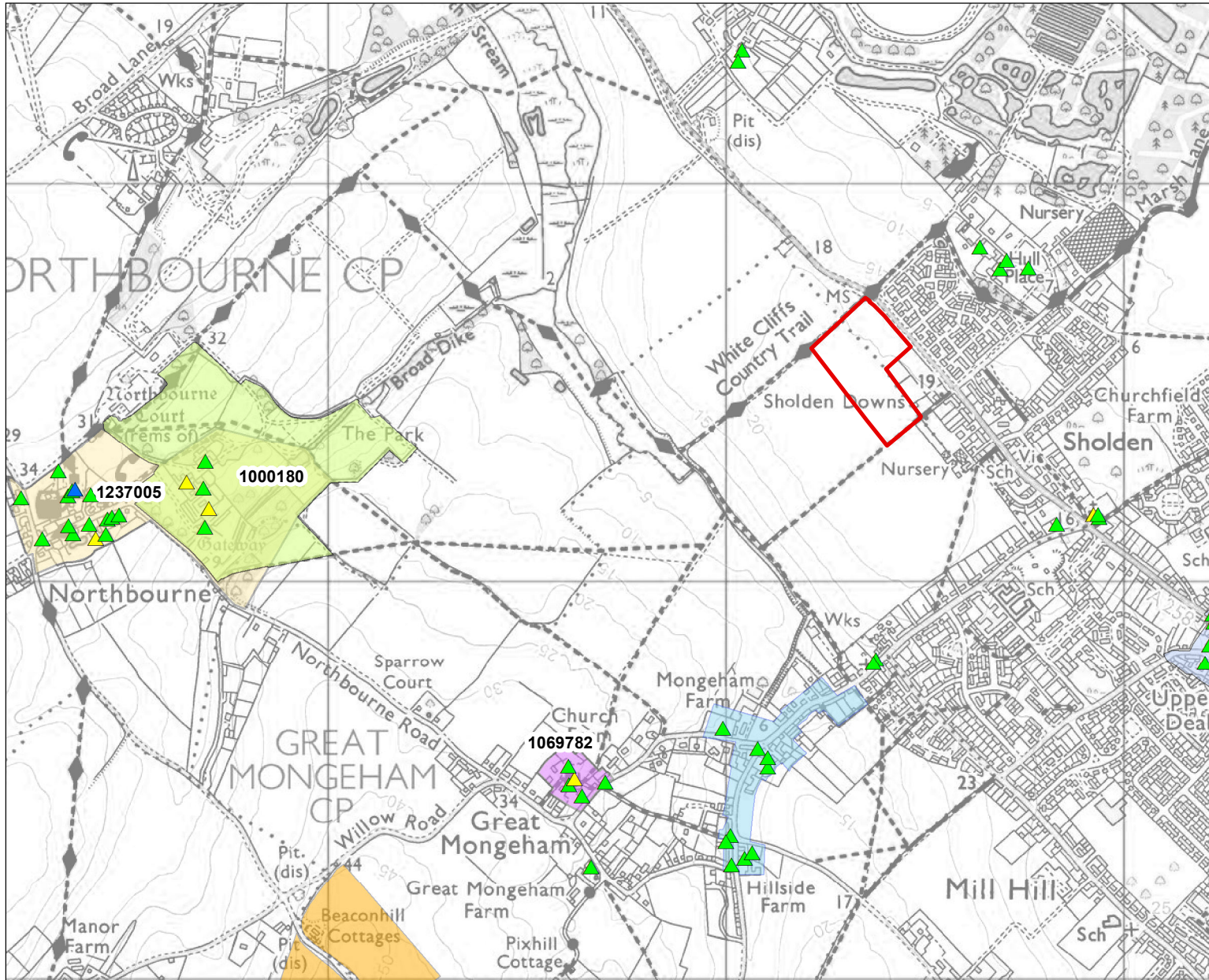

KEY

- Site
- ▲ Grade I Listed Building
- ▲ Grade II* Listed Building
- ▲ Grade II Listed Building
- Scheduled Monument
- Registered Park and Garden
- Great Mongeham Conservation Area
- Church Great Mongeham Conservation Area
- Upper Deal Conservation
- Northbourne Conservation

Revisions:
First Issue- 17/12/2020 RG

Figure 1: Designated Heritage Assets

Land south-west of
Sandwich Road, Sholden

Client: Richborough Estates
 DRWG No: P20-2511 Sheet No: - REV:-
 Drawn by: RG Approved by: GST
 Date: 17/12/2020
 Scale: 1:15,000 @ A3

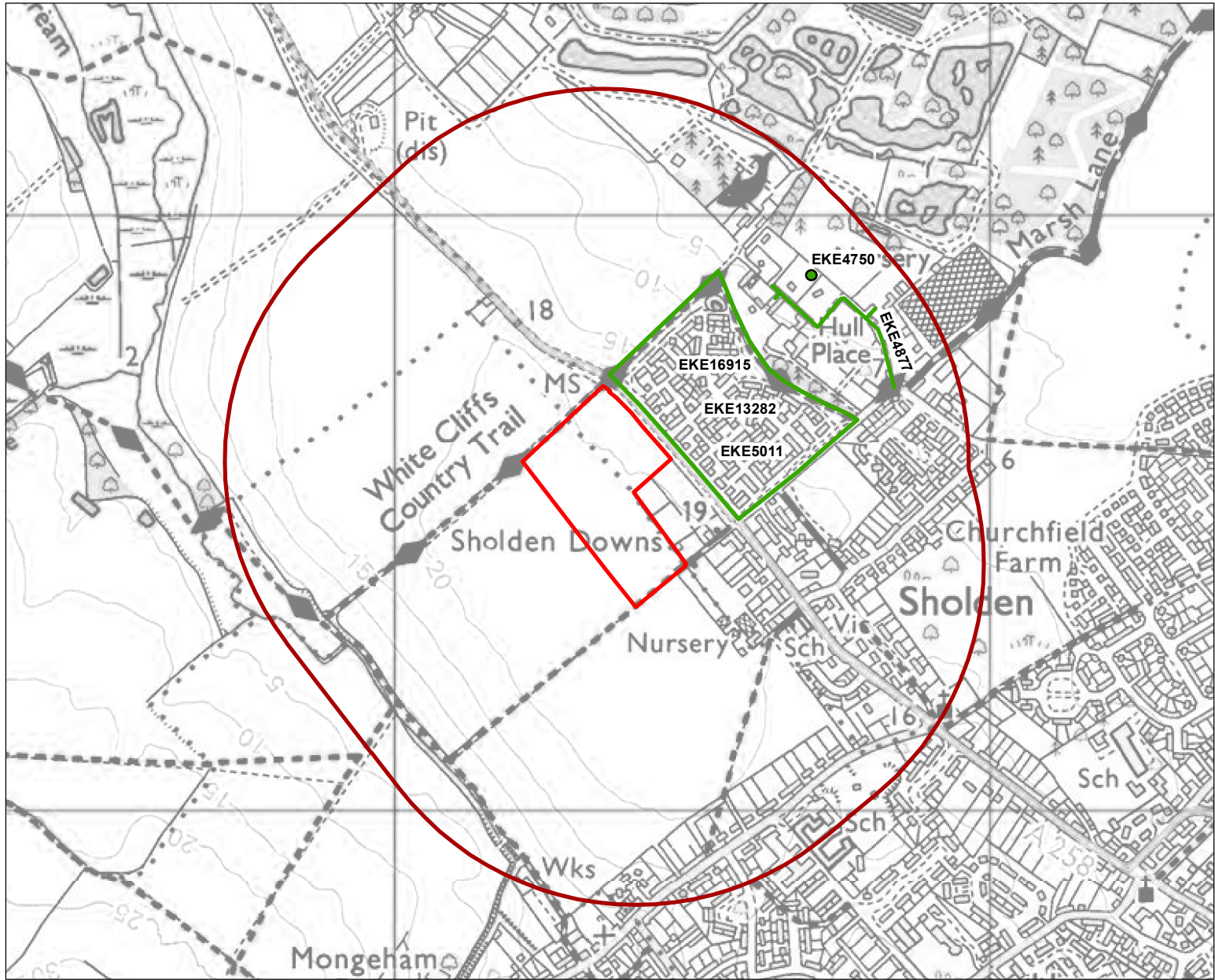

KEY

- Site
- Study Area
- HER Event Point
- HER Event Line
- HER Event Polygon

Revisions:
First Issue- 17/12/2020 RG

Figure 2: Kent HER Event Data

Land south-west of Sandwich Road, Sholden

Client: Richborough Estates
 DRWG No: P20-2511 Sheet No: - REV:-
 Drawn by: RG Approved by: GST
 Date: 17/12/2020
 Scale: 1:10,000 @ A3

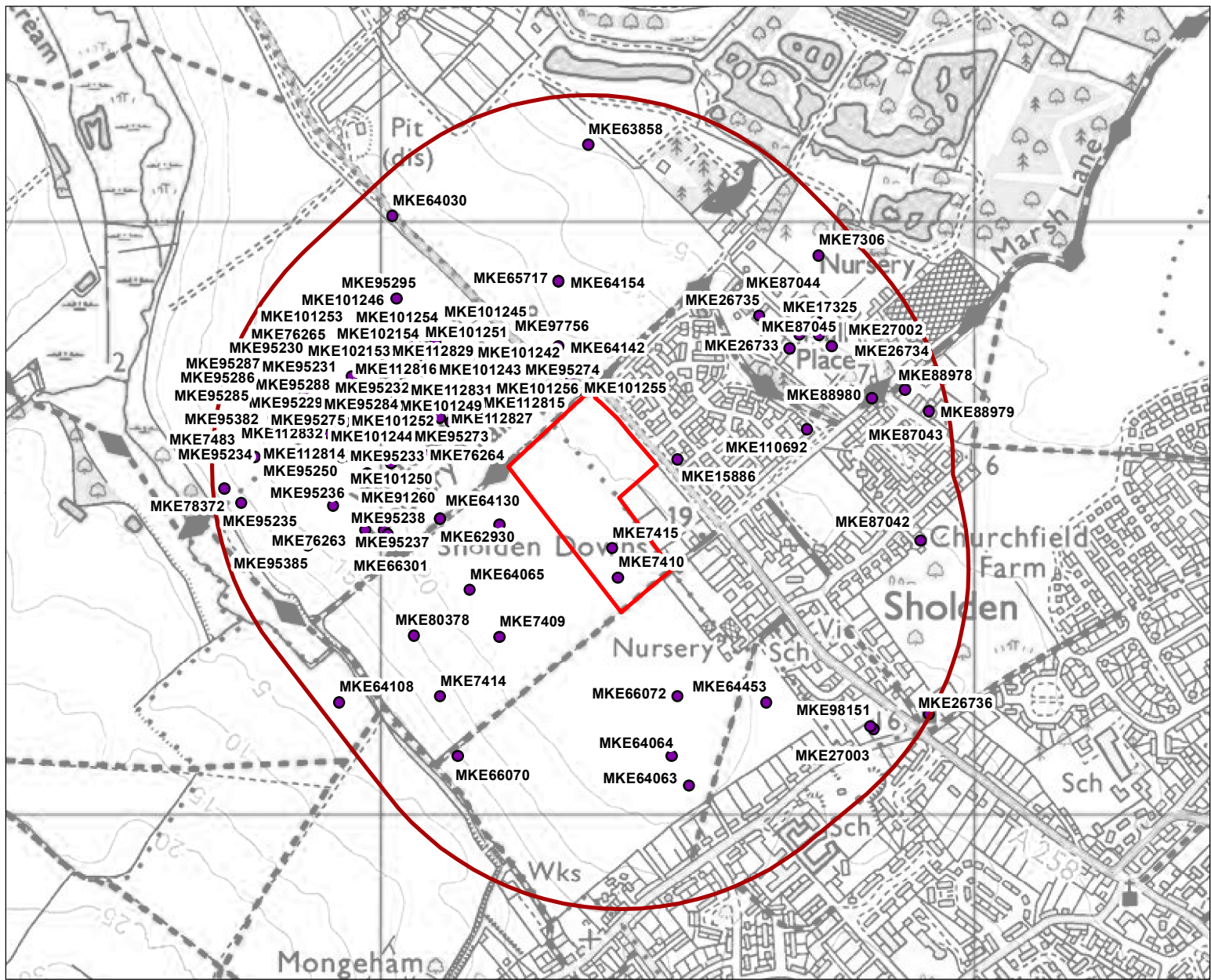

KEY

- Site
- Study Area
- HER Monument Point

Revisions:
First Issue- 17/12/2020 RG

Figure 3: Kent HER Monument Data

Land south-west of Sandwich Road, Sholden

Client: Richborough Estates
 DRWG No: P20-2511 Sheet No: - REV:-
 Drawn by: RG Approved by: GST
 Date: 17/12/2020
 Scale: 1:10,000 @ A3



Appendix 5: Geophysical Survey Report

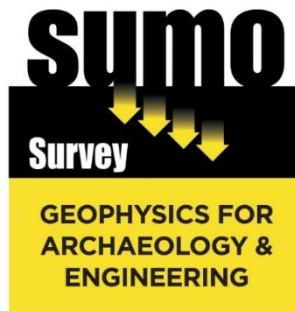

GEOPHYSICAL SURVEY REPORT

Land off Sandwich Road, Sholden, Kent

Client

Pegasus Group

On behalf of

Richborough Estates Ltd

Survey Report

00920

Date

November 2020



Survey Report 00920: Land off Sandwich Road, Sholden, Kent

Survey dates	2-3, 16-17 November 2020
Field co-ordinator	Robert Knight MA
Field Team	Oliver Thomas Jasmin Folland MA James Hunt BA
Report Date	26 November 2020
CAD Illustrations	Rebecca Fradgley BSc
Report Author	Rebecca Fradgley BSc
Project Manager	Simon Haddrell BEng AMBCS PCIfA
Report approved	Dr John Gater BSc DSc(Hon) MCIfA FSA

SUMO Geophysics Ltd
Cowburn Farm
Market Street
Thornton
Bradford
BD13 3HW

T: 01274 835016

SUMO Geophysics Ltd
Vineyard House
Upper Hook Road
Upton upon Severn
Worcestershire
WR8 0SA

T: 01684 592266

www.sumoservices.com
geophysics@sumoservices.com

TABLE OF CONTENTS

1	LIST OF FIGURES	1
2	SURVEY TECHNIQUE	1
3	SUMMARY OF RESULTS	2
4	INTRODUCTION	2 - 3
5	RESULTS	3 - 4
6	DATA APPRAISAL & CONFIDENCE ASSESSMENT	5
7	CONCLUSION	5
8	REFERENCES	5

Appendix A Technical Information: Magnetometer Survey Methods, Processing and Presentation

Appendix B Technical Information: Magnetic Theory

1. LIST OF FIGURES

Figure 01	NTS	Site Location
Figure 02	1:3000	Magnetometer Survey - Greyscale Plots - Overview
Figure 03	1:3000	Magnetometer Survey - Interpretation - Overview
Figure 04	1:1500	Magnetometer Survey - Greyscale Plots - Area 1
Figure 05	1:1500	Magnetometer Survey - Interpretation - Area 1
Figure 06	1:2000	Magnetometer Survey - Greyscale Plots - Area 2
Figure 07	1:2000	Magnetometer Survey - Interpretation - Area 2
Figure 08	1:3000	2007 Google Earth Image showing cropmark features
Figure 09	1:3000	Minimally Processed Data – Greyscale Plots
Figure 10	1:3000	Magnetometer Survey - XY Traceplots clipped at +/-15nT - Overview
Figure 11	1:1500	Magnetometer Survey - XY Traceplots clipped at +/-15nT - Area 1
Figure 12	1:2000	Magnetometer Survey - XY Traceplots clipped at +/-15nT - Area 2

2. SURVEY TECHNIQUE

Detailed magnetic survey (magnetometry) was chosen as the most efficient and effective method of locating the type of archaeological anomalies which might be expected at this site.

Bartington Grad 601-2

Traverse Interval 1.0m

Sample Interval 0.25m

3 SUMMARY OF RESULTS

- 3.1 A detailed magnetometer survey was conducted over approximately 17.5 hectares of land off Sandwich Road, Sholden, Kent. The survey has confirmed the presence of sub-circular enclosures visible as cropmark features on aerial imagery and has also revealed evidence for further enclosures and ring-ditches. Several linear and curvilinear anomalies have been mapped; these could be linked to the enclosures but could also relate to old field boundaries or agricultural activity. Ploughing effects are visible over much of the site, with areas of natural variation mapped in the north and two underground services in the south.

4 INTRODUCTION

- 4.1 **SUMO Geophysics Ltd** were commissioned to undertake a geophysical survey of an area outlined for development. This survey forms part of an archaeological investigation being undertaken by **Pegasus Group** on behalf of **Richborough Estates Ltd**.

4.2 Site details

NGR / Postcode	TR 354 523 / CT14 0AD
Location	The site is located to the west of Sholden, near Deal, Kent. Sandwich Road forms the north-eastern boundary of the area, with Mongeham Road to the south and agricultural land to the north and west.
HER	Kent
District	Dover
Parish	Deal CP
Topography	Mostly level with a slight fall to the west.
Current Land Use	Arable
Geology (BGS 2020)	Solid: Seaford Chalk Formation - chalk. Superficial: No superficial deposits are recorded across the majority of the area, though a small area of Head - clay and silt - is present over the north-eastern corner.
Soils (CU 2020)	Soilscape 6: freely draining slightly acid loamy soils.
Archaeology (PG 2020)	A number of cropmarks and soil marks have been identified within the site on aerial photographs, and as part of the National Mapping Programme, comprising potential ring ditches, an enclosure and linear features (see Plate 1, below). A concentration of ring ditches, mainly focused to the west of the site, (MKE7410) may be contemporary with the cropmark enclosure in the site, though the nature of the feature indicates that it may have originated during the Iron Age, and continued use into the Roman period (MKE7415). Romano-British activity has been recorded in the wider study area, although none within the site itself. The site of Sholden Roman villa (MKE7306, EKE4750) is recorded c.430m to the north-east with associated trackways and field boundaries. A ditch of potential Roman date was recorded during evaluation in the field east of the site though its orientation suggests it is not likely to have continued into the site.

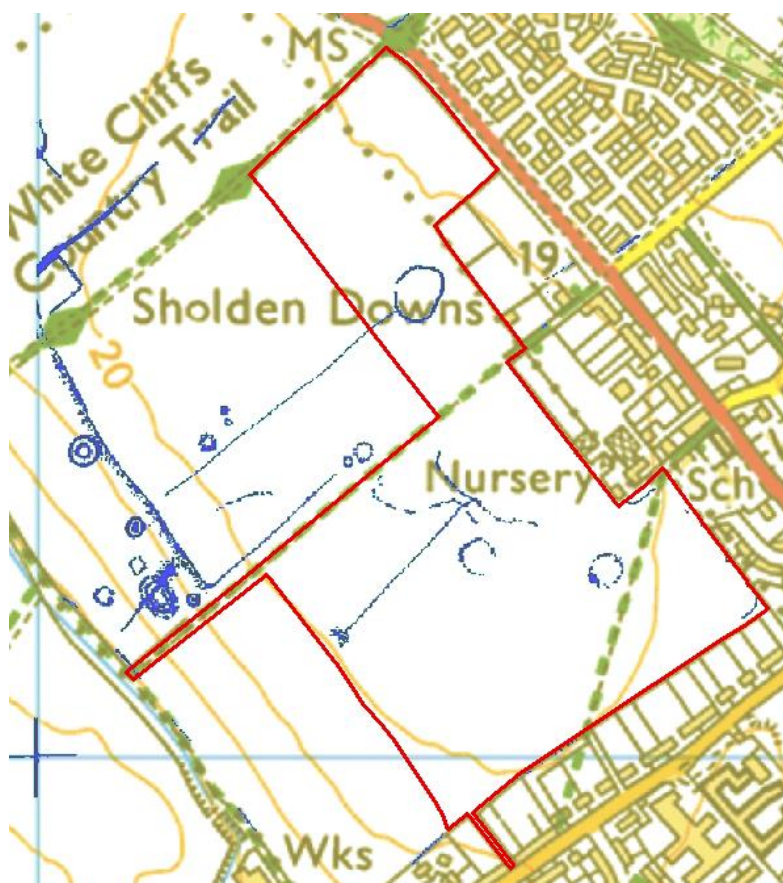

Plate 1: Map of cropmarks from the National Mapping Programme (PG 2020; Plate 2).

Survey Methods	Magnetometer survey (fluxgate gradiometer)
Study Area	c. 17.5 ha

4.3 Aims and Objectives

To locate and characterise any anomalies of possible archaeological interest within the study area.

5 RESULTS

The survey has been divided into two survey areas (Areas 1-2) and specific anomalies have been given numerical labels [1] [2] which appear in the text below, as well as on the Interpretation Figure(s).

5.1 Probable / Possible Archaeology

- 5.1.1 A sub-oval enclosure [1], approximately 35m x 45m in size, has been identified in Area 1 in the same location as a partial cropmark enclosure visible on Google imagery (Fig. 08). The enclosure has apparent entrances on its western and eastern sides, though it is possible that they are a result of truncation by agricultural activity as opposed to genuine features.
- 5.1.2 Two further sub-circular enclosures [2-3] have been detected in Area 2, with the partial enclosure at [2] some 33m in diameter, and the enclosure at [3] approximately 25m wide. A smaller ring-ditch [4], measuring 13m in diameter, has been identified further to the south,

with parallel ditch-type responses extending to the west. The shape and form of each of the features is suggestive of a later prehistoric origin.

- 5.1.3 Four additional possible ring-ditches [5-8] have been mapped, each measuring between c. 13m and 16m in diameter. The magnetic responses of these anomalies is much weaker than that at [4], or the larger enclosures at [1-3], hence their interpretation as *possible archaeology*. They could also have natural or agricultural explanations.
- 5.1.4 Two curvilinear ditch-type responses [9] are noted in the north of Area 2 and could have an archaeological explanation. The responses tentatively extend to the south-east, towards a speculative partial rectilinear feature [10], in the east of the area.
- 5.1.5 An area of enhanced magnetic response [11] to the south of [9] and between the two sub-circular enclosures of [2] and [3] could have an archaeological origin. The magnetic responses of the feature are characteristic of thermoremanent anomalies, which could indicate the remains of possible kilns or ovens, though the presence of the nearby pipeline and field boundary may be affecting the results.

5.2 ***Uncertain***

- 5.2.1 A number of linear and curvilinear anomalies of uncertain origin have been mapped across the site, on varying orientations and alignments. It is possible that some of the responses relate to ditches or divisions associated with the later prehistoric activity, however many of the straight linear anomalies could be a result of former (modern) field boundaries or ploughing effects.
- 5.2.2 Several discrete areas of enhanced magnetic response are also noted across the area. Given the later prehistoric activity on the site, a potential archaeological explanation cannot be ignored; however, it is just as likely that they have a natural origin and reflect areas of natural pitting within the chalk geology (see 5.4.1 below).

5.3 ***Agricultural – Ploughing***

- 5.3.1 Evidence for modern ploughing activity is visible across much of the site in the form of closely spaced, magnetically weak, parallel linear anomalies.

5.4 ***Natural / Geological / Pedological / Topographic***

- 5.4.1 Amorphous areas of enhanced magnetic response are noted in Area 1. They are indicative of areas of natural magnetic variation often seen on chalk geologies, and partially visible as a soil mark on aerial photographs (Fig. 08).

5.5 ***Ferrous / Magnetic Disturbance***

- 5.5.1 Strong bipolar linear anomalies running across Area 2 are indicative of underground services, such as pipes or cables.
- 5.5.2 Ferrous responses close to boundaries are due to adjacent fences and gates. Smaller scale ferrous anomalies ("iron spikes") are present throughout the data and are characteristic of small pieces of ferrous debris (or brick / tile) in the topsoil; they are commonly assigned a modern origin. Only the most prominent of these are highlighted on the interpretation diagram.