

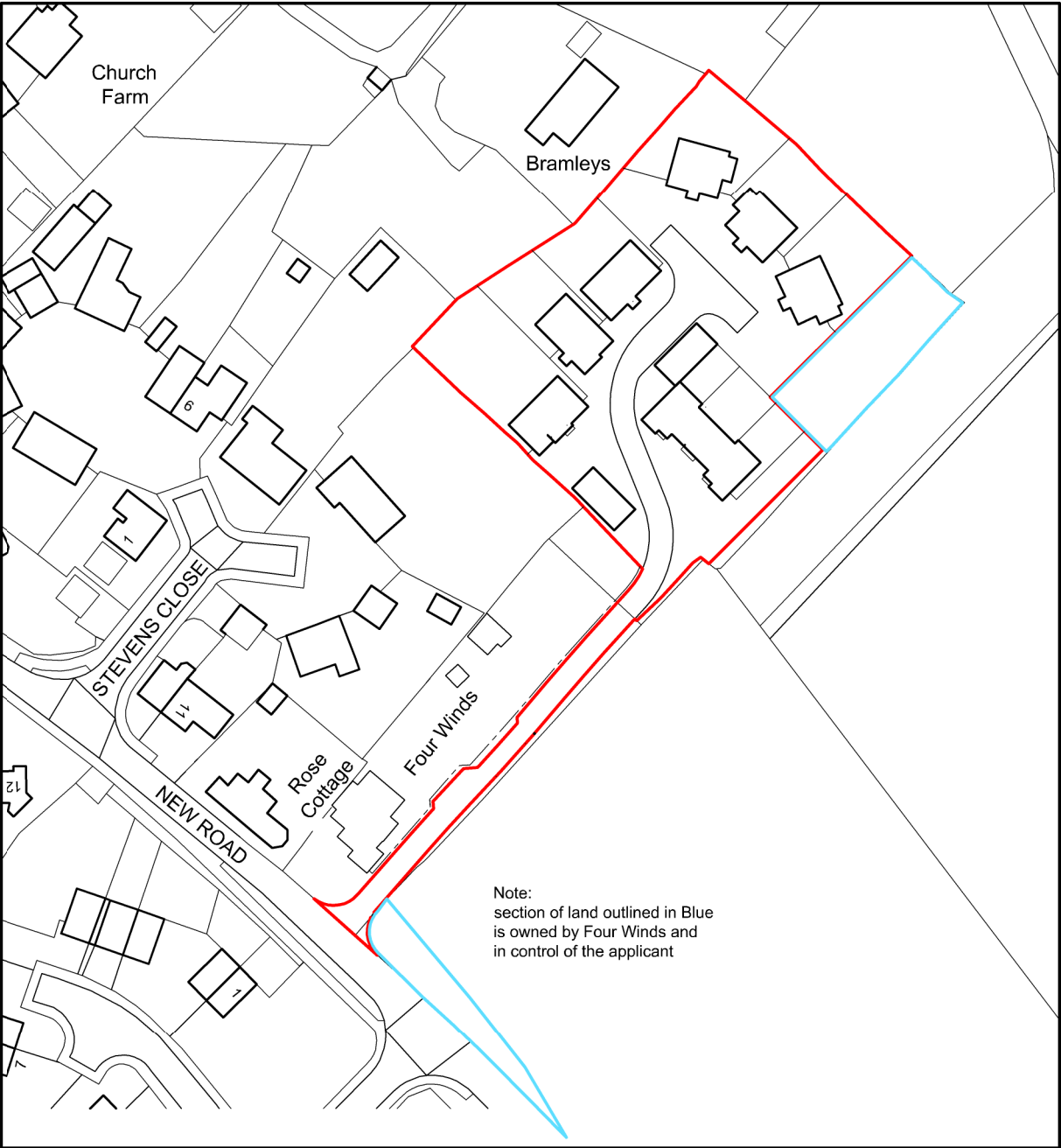

Proposed block plan

scale 1:500

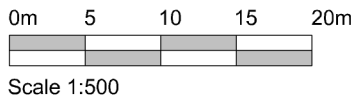

Site location plan

scale 1:1250

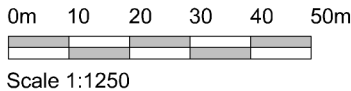

07.04.2025	Revision L:	House types Plots 1 & 3 changed and position of dwellings on Plots 2, 4 & 5 adjusted
12.02.2025	Revision K:	updated to accord with final house types
18.04.2024	Revision J:	Speed table removed and road width reduced to form speed restriction
15.04.2024	Revision I:	Dwellings to Plots 1 & 2 repositioned
29.02.2024	Revision H:	House type Plots 1 & 2 changed
02.02.2024	Revision G:	blue line amended as requested by client
26.01.2024	Revision F:	parking amended to accord with KCC highways comments - land adjacent to site access outlined in blue and annotated
15.12.2023	Revision E:	2No visitor parking spaces added
15.11.2023	Revision D:	layout amended with revised house types
31.10.2023	Revision C:	minor alterations to clients requirements
27.09.2023	Revision B:	layout amended with revised house types
20.07.2022	Revision A:	minor alterations to clients requirements

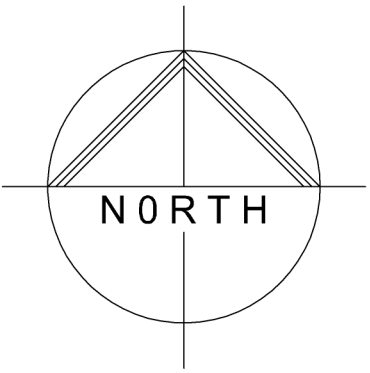

Project Address:
proposed development at:
Fours Winds & Orchard Nurseries
New Road, Egerton
Ashford Kent TN27 9DT

Drawing Title:
proposed block plan
site location plan

Scale:
as stated @ A2

Date:
July 2022

Drawing Number:
NR/675/BP01

Revision:
L:

Client
Lansdown Asset Management

Nigel Bradbury Designs
Office Suite B, Willow Walk Business Centre
Starts Hill Road, Farnborough, Kent, BR6 7AA
Telephone: 01689 852609
e.mail: nigel@nigelbradburydesigns.co.uk

Drawing Status: Issued for planning

Date: 04.07.2022

© Copyright Nigel Bradbury Designs