

Notes:

Please report all discrepancies, errors and omissions.
 Verify all dimensions on site before commencing any work on site or preparing shop drawings.
 All materials, components and workmanship are to comply with the relevant British Standards, Codes of Practice, and appropriate manufacturers recommendations that from time to time shall apply.
 For all specialist work, see relevant drawings.
 This drawing and design are copyright of RMB Consultants (Civil Engineering) Ltd.
 When this document is provided in electronic file format it is intended as a guide only and the recipient is to verify all dimensions and details with the Architects. If this is not acceptable, the files must be returned unused together with a written communication declining acceptance of this condition.

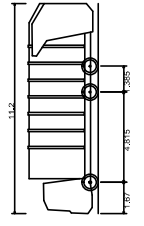

Phoenix 2 Duo (P2-15W with Elite 6x4 chassis)
 Overall Length 11.200m
 Overall Width 3.750m
 Overall Height 2.850m
 Min Body Ground Clearance 0.304m
 Track Width 2.500m
 4.1 sec
 Kerb to Kerb Turning Radius 9.500m

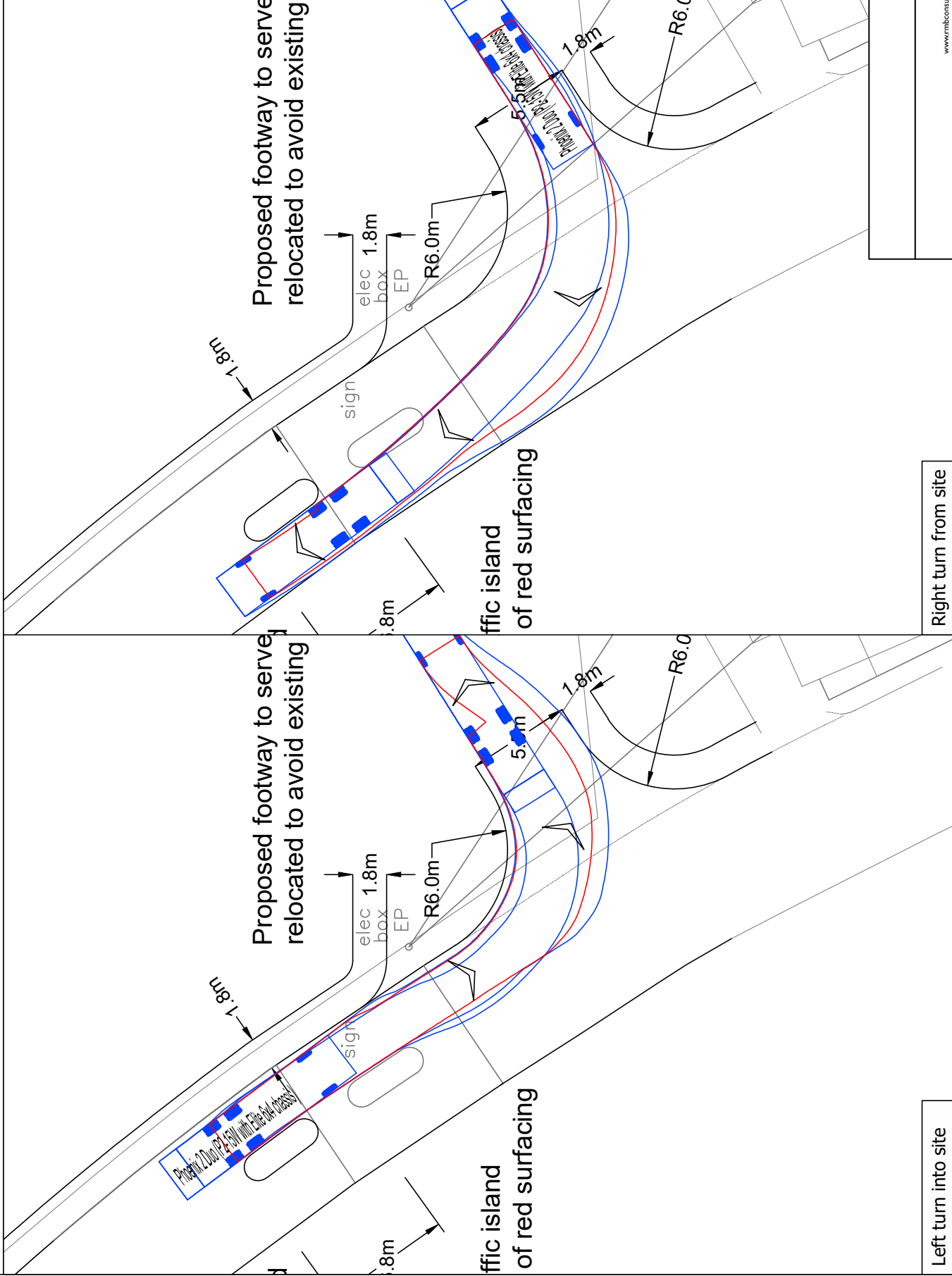
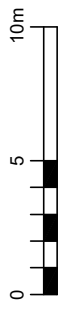

38 Cosington Road Canterbury Kent CT1 3HU
 Tel/Fax: 01227 472128 • Mobile: 07886 185705
 www.rmbconsultants.co.uk • robert.beck@rmbconsultants.co.uk

client	Montgomery & Partners LLP	project	Manston Road/Preston Road Manston Kent
drawing	11.2m Long Refuse Vehicle Sweep	scale	1:200 @ A3
date	September 2016	drawing no.	604/205
		drawn by	RB

Right turn from site

Left turn into site

Manston Road/Preston Road, Manston Kent
 11.2m Long Refuse Vehicle Sweep Path, Manston Road