



**Ben Larkham Associates Ltd,
Arboricultural &
Horticultural
Consultants**

3 Princes Street,
Tunbridge Wells,
Kent.

TN2 4SL

Tel/Fax 01892 684086

Web: www.benlarkham.co.uk

Email: info@benlarkham.co.uk

Arboricultural survey and constraints

Land north of Old Ashford Road Lenham Kent

Client and Address:	c/o Lee Evans Planning, St John's Lane, Canterbury, Kent CT1 2QQ
Inspector:	B.Larkham, Dip.Arb.(RFS), Tech.Cert.(Arbor.A), F.Arbor.A.
Date of Inspection:	9 th December 2015
Date of Report:	9 th December 2015
Reference no.:	tr-1208-15

Land north of Old Ashford Road, Lenham, Kent

No	Species	Hgt	Ø at 1.5m	Spread NSEW	Crown c/rance	Age	Condition and <u>Recommendations</u>	Erc	BS grade	RPA (rad)
T1	Ash	17.0	40+36	Ø10.0	5.0	Mat	Twin stemmed – Bifurcated at ground level. Moderate Ivy restricting full inspection. Moderate Ivy to 6.0 metres. overhead wire through crown – maintained clear. <u>Remove Ivy and re-inspect.</u>	40+	B1	6.7
T2	Ash	13.0	32+30	Ø7.0	5.0	Mat	Bifurcated at ground level. Moderate Ivy to 7.0 metres restricting full inspection. Minor obstruction to street light. Scrub Field Maple to west side. <u>Remove Ivy and re-inspect.</u>	40+	B1	5.2
T3	Ash	10.0	e.28	Ø8.0	5.0	Mat	Triple stemmed at 2.5 metres. Five smaller stems of Ash from ground level.	40+	B1	3.3
T4	Ash	6.5	22,18, 15 +10	Ø3.0	2.0	Mat	Limited foliage. Canker and significant Ivy. Dead/decline. Limited future value. <u>Recommend removal.</u>	<10	U	-

Land north of Old Ashford Road, Lenham, Kent

No	Species	Hgt	Ø at 1.5m	Spread NSEW	Crown c/rance	Age	Condition and <u>Recommendations</u>	Erc	BS grade	RPA (rad)
T5	Ash	16.5	e.35x3	6.0,6.0, 7.0, 5.0	2.0(E) 4.5(S)	Mat	Asymmetric to east. Triple stemmed from ground level. Significant Ivy to 8.0 metres restricting full inspection. Remove Ivy and re-inspect.	40+	B1	7.3
T6	Ash	17.0	48	Ø15.0	2.0(E/W) 5.0(S)	Mat	Triple stemmed at 4.5 metres. Dead Ivy remaining to stem.	40+	A1	5.7
H1	Mixed	<2.4	<3x 10cm at g/1	Ø1.5	-o-	Mat	Reasonable section of hedging to east of T6. Topped at 1.4 metres. Ash, Blackthorn, Hazel and Elder.	40+	B2	1.5 adj
H2	Beech	<2.2	<15	Ø1.5	-o-	Mat	Offsite hedging. Topped and faced to fence line. Field ploughed 1.5 metres from stems.	20-40	B2	1.5 adj
T7	Ash	13.5	34cm X2	Ø12.0	5.5	Mat	Offsite tree. Twin stemmed from ground level. Pruned up to field side.	40+	B1	5.7

Land north of Old Ashford Road, Lenham, Kent

No	Species	Hgt	Ø at 1.5m	Spread NSEW	Crown c/rance	Age	Condition and <u>Recommendations</u>	Erc	BS grade	RPA (rad)
T8	Hawthorn	<8.0	22,12, 12+10	Ø9.0	0.5	Mat	Offsite. Even age belt of trees to south side of drainage ditch. One Elder present. Faced up to field side. Single most eastern tree not reduced. Two stems failed to north approximately 25.0 metres west of T7.	40+	B2	4.0 adj
T9	Ash	e.16.0	e.45	Ø12.0	7.0(s)	Mat	Offsite tree. Marked with orange dot from highway inspection. Branch division at 4.0 metres. Asymmetric to east.	40+	B1	5.4
T10	Sycamore	14.0	<7x25cm average	<Ø9.0	6.0(s)	Mat	Two groups of even aged trees. Offsite to north side of drainage ditch. Multi-stemmed. Cavities/coppice pockets to west tree – marked with orange spray from highway inspection.	40+	B1	7.9

Land north of Old Ashford Road, Lenham, Kent

No	Species	Hgt	Ø at 1.5m	Spread NSEW	Crown c/rance	Age	Condition and <u>Recommendations</u>	Erc	BS grade	RPA (rad)
T11	Ash	11.5	28,25, 24,22+ 5x8cm	4.0,4.0 6.0,7.0	6.0(S)	Mat	Moderate Ivy restricting full inspection. Offsite tree. South side of ditch. Multi-stemmed from ground level Topped stem and cavity at 1.0 metre. Asymmetric to west.	20-40	C1	6.3
T12	Sycamore	10.5	24+17	Ø6.0	1.5(N) 7.0(S)	Mat	Offsite tree. Faced up to 6.0 metres to south side. Asymmetric to north. Bifurcated at 0.9 metres. Bark scarring to south at ground level and to east at 1.0 metre.	20-40	C1	3.5
T13	Sycamore	<19.0	<9x 30cm average	Ø18.0	5.0(S)	Mat	Offsite. Mostly Multi-stemmed with significant Ivy restricting full inspection. East and western trees largest in group. <u>Remove Ivy and re-inspect.</u>	40+	B2	10.8

Land north of Old Ashford Road, Lenham, Kent

No	Species	Hgt	Ø at 1.5m	Spread NSEW	Crown c/rance	Age	Condition and <u>Recommendations</u>	Erc	BS grade	RPA (rad)
H3	Mixed	<6.5	<10+10	Ø3.0	-o-	Y	Offsite hedging comprising Field Maple, Dog Rose, Elder, Dogwood, Ash, Cherry, Willow, Hazel and Blackthorn. Faced up to east side. Further young standard tree planting to west within Groom Square development. <u>Recommend provision of 2.0 metres minimum protection distance.</u>	40+	C2	2.0 adj

See key and comments over

Key and general comments

Hgt	Height (estimated)
Stem Ø	Trunk diameter in centimetres measured at 1.5 metres above ground level.
Spread	Crown radii in metres to compass points or crown diameter suffixed Ø
Crown c/rance	Height in meters of crown clearance above adjacent ground level
Life Stage	Age class (Y – young, Mid Age – middle aged, Mat – mature, OM – over mature, V – veteran)
Phys cond	Physiological condition – Good, Fair, Poor, Dead
Condition and <u>Recommendations</u>	Structural condition and record of defects together with any preliminary management recommendations as underlined.
RPA (rad)	Recommended protection area. Dimension in metres = radius of circle from the centre of stem. Adj may be suffixed where RPA is increased based upon crown spread or other changes at discretion of surveyor.
Erc	Estimated remaining contribution in years (less than 10, 10-20, 20-40, more than 40)
BS grade	U –Remove, A1-A3 :Category A High quality, B1-B3 :Category B Moderate quality, C1-C3 :Category C Low quality
Bifurcated	Main stem divides into two stems
Asy	Asymmetric canopy to compass direction
N S E W	Compass point direction, may also appear as NE
Vig	Vigour (N-normal, L-Low)
Mat	Maturity (OM-Over Mature, M-Mature, Med-Medium, Y-Young)
e.	Estimated dimension
g/l	Ground level
c/l	Centre line
m/s	Multi-stemmed
Remove deadwood	Remove deadwood, significantly diseased or decayed growth, crossing or torn branches. Branch stubs and tears to be cut clean. All work to be carried out in accordance with BS3998 and current best practice.

Key and comments continued.

The survey relates to trees to land north of Old Ashford Road, Lenham, Kent. The purpose of survey is to identify trees within the subject site and record their dimensions and overall contribution in accordance with British Standard 5837:2012 Trees in relation to design, demolition and construction - Recommendation. The drawing uses the topographic survey prepared by Omega Geomatics, unit 1, Hoath Business Centre, Hoath Lane, Gillingham , Kent ME8 0BF reference 15-0103. All dimensions should be checked prior to marking out on site.

No internal investigation of any trees was undertaken.

It has not been verified whether the site is the subject of Tree Preservation Order or Conservation Area restrictions. The consent of the Local Authority should therefore be sought prior to undertaking any works recommended within these documents.

Birds and bats are protected by law and any works to trees recommended within this schedule should be undertaken with due consideration to current legislation. The assessment for the presence of bats should be undertaken by a qualified assessor.

A person professionally competent in Arboriculture should undertake all future tree inspections recommended within this schedule.

All tree surgery work is to be undertaken in accordance with BS3998:2010 and current best practice..

The Arboricultural survey was initially undertaken on the 9th December 2015. The weather at the time of survey was fair.

The details of this survey are based upon the condition of the subject tree/s present on the date of the inspection. Responsibility cannot be held for the subsequent effects of extremes of weather, vandalism or damaging acts either negligent or wilful. Liability cannot be held for any subsequent physical undertaking to the canopy, stem or roots of the tree/s. This survey is valid for a period of two years from the date of the site inspection unless the site conditions change or works unspecified in this report are undertaken.

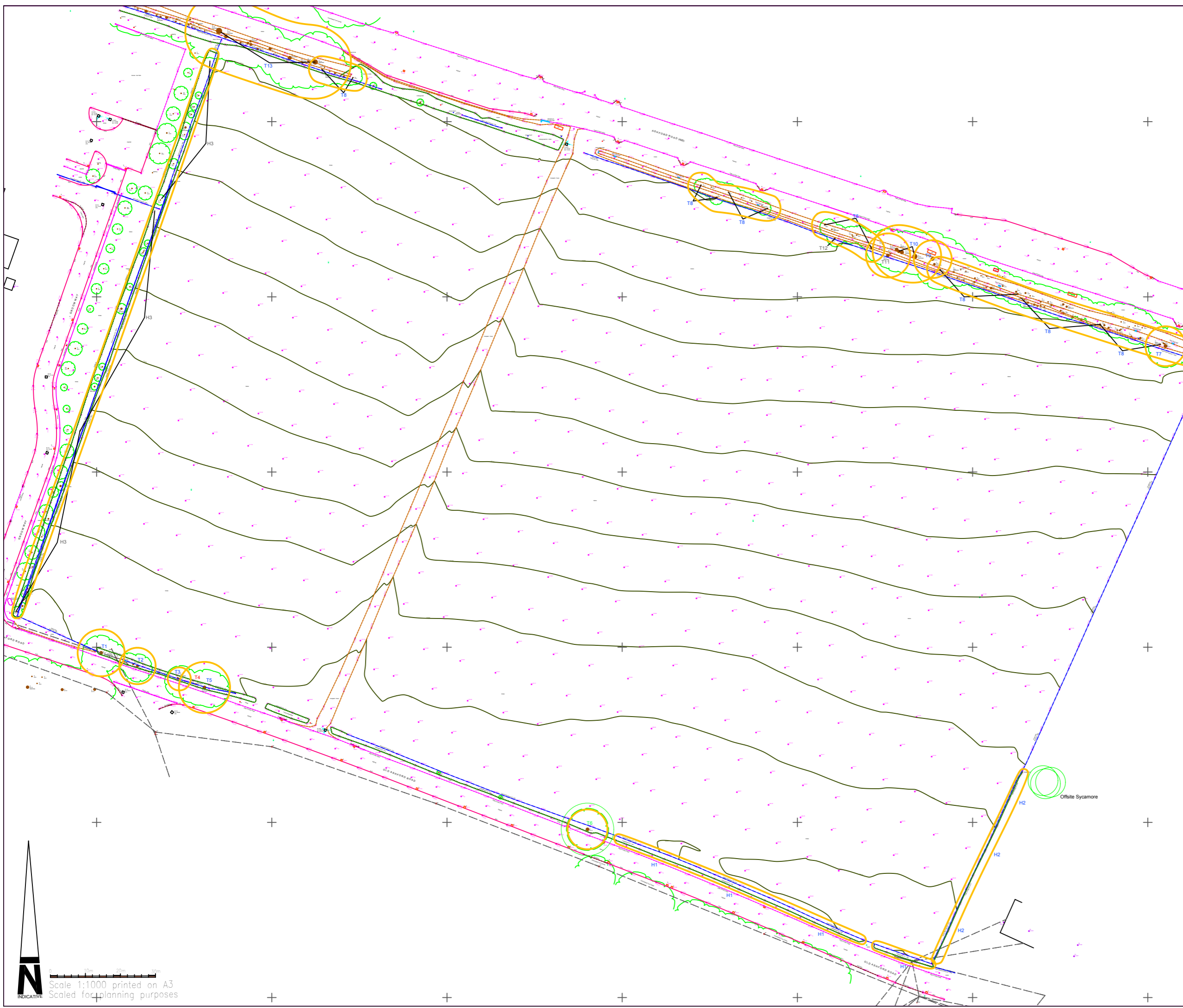

NOTES

- Do not scale from this drawing
- Report any discrepancies to the Architect
- Check dimensions on site prior to starting work

Key

- A grade trees - high quality and value
- B grade trees - moderate quality and value
- C grade trees - low quality and value
- U grade trees - recommended for removal
-  BS5837:2012 recommended root protection area

Rev.	Date	Description
------	------	-------------

Job Title:
**Land to north of Old Ashford Road
 Lenham
 Kent**



Ben Larkham Associates, 3 Princes Street,
 Tunbridge Wells, TN2 4SL
 TEL: 01892 684086 Email: office@benlarkham.co.uk

Drawing Title:
**Arboricultural survey
 and constraints**

Scale: 1:1000 at A3	Drawn By: BL	Date: Dec 15
Drawing Number: tr-1208-15		Rev.:

 Scale 1:1000 printed on A3
 Scaled for planning purposes