

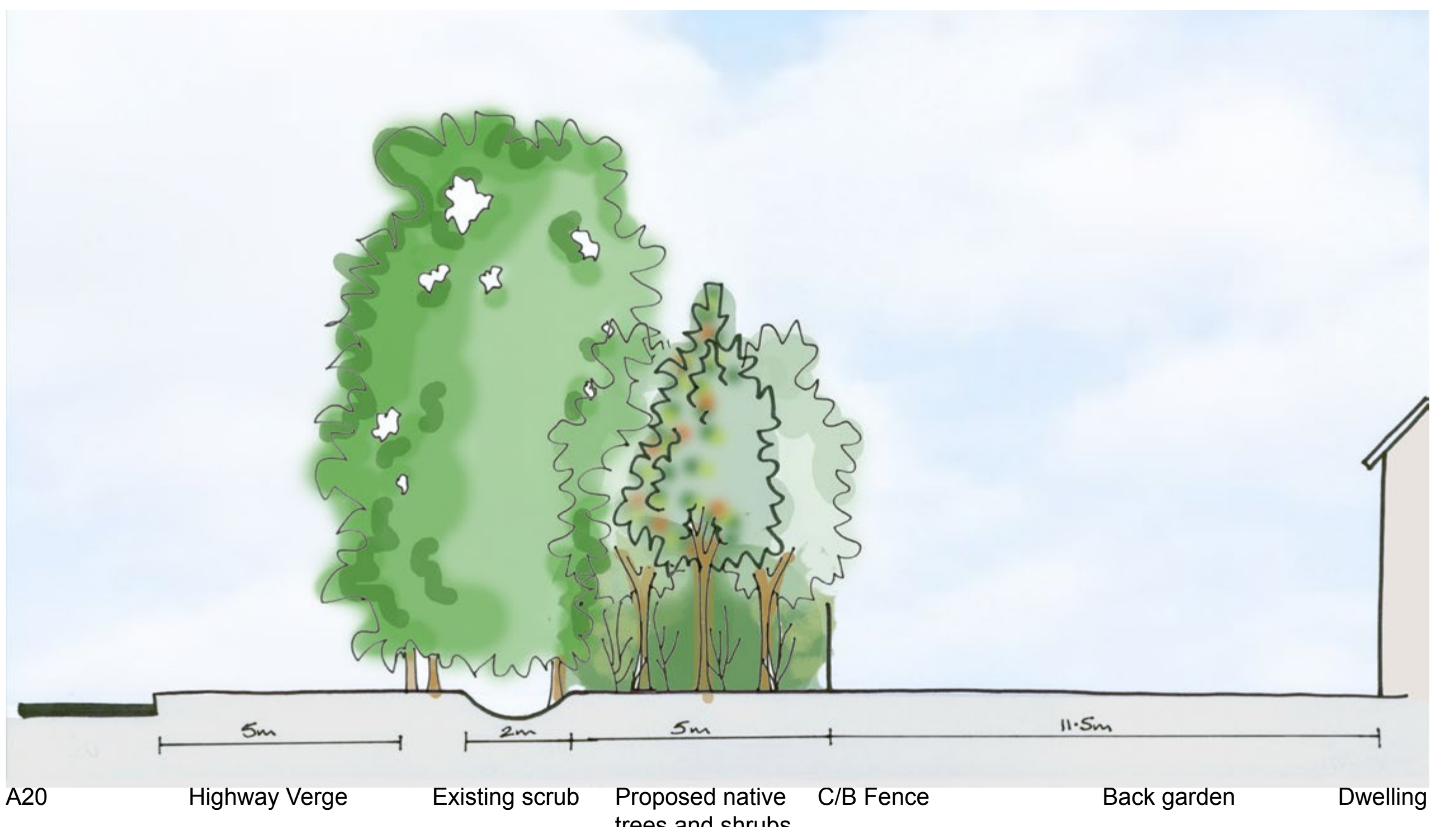

Site location plan



Horizontal buffer planting locations to mitigate views from the North Downs AONB



Cross Section C - C' Sketch proposal of the existing and proposed landscape buffer planting along the northern boundary to obscure the development from the North Downs AONB.

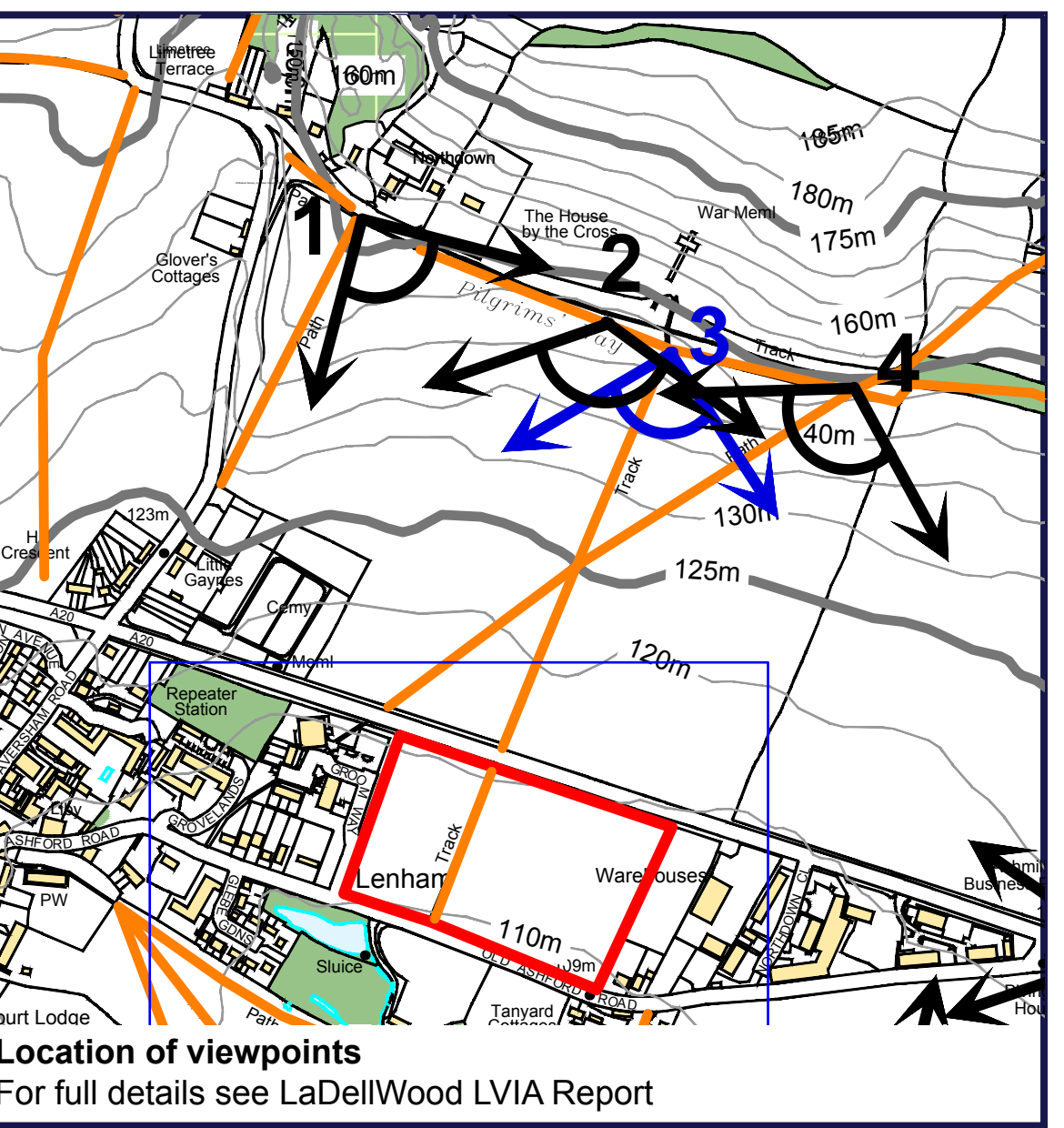

Location of viewpoints For full details see LaDellWood LVIA Report

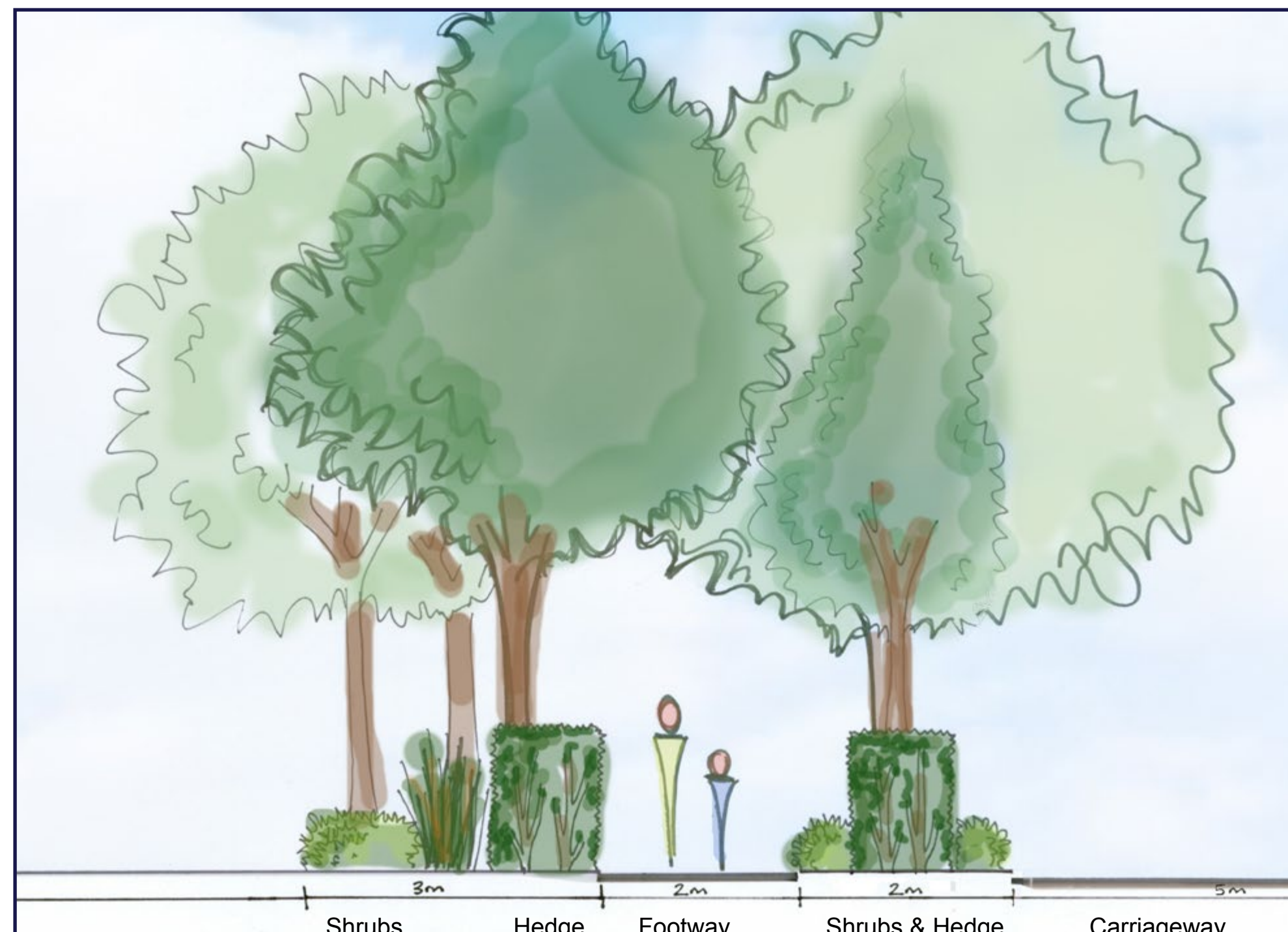

Cross Section D - D' Sketch proposal of the landscape buffer planting near the southern boundary

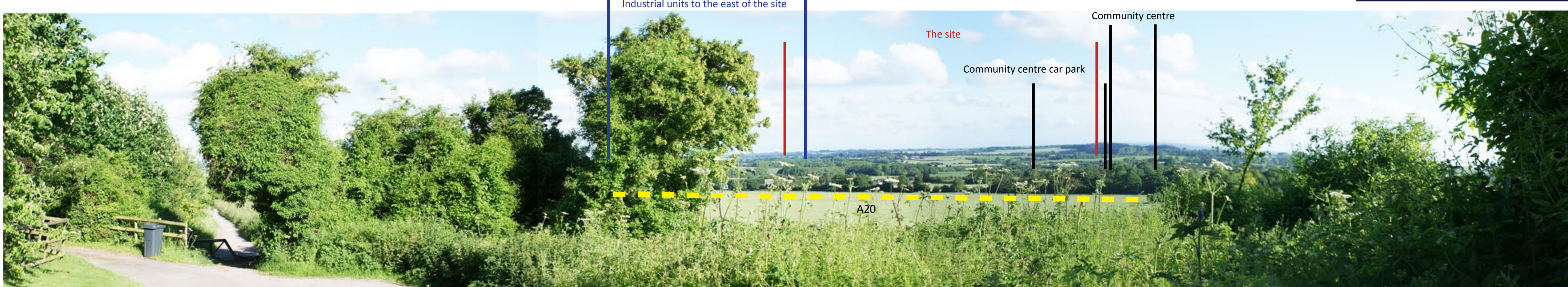
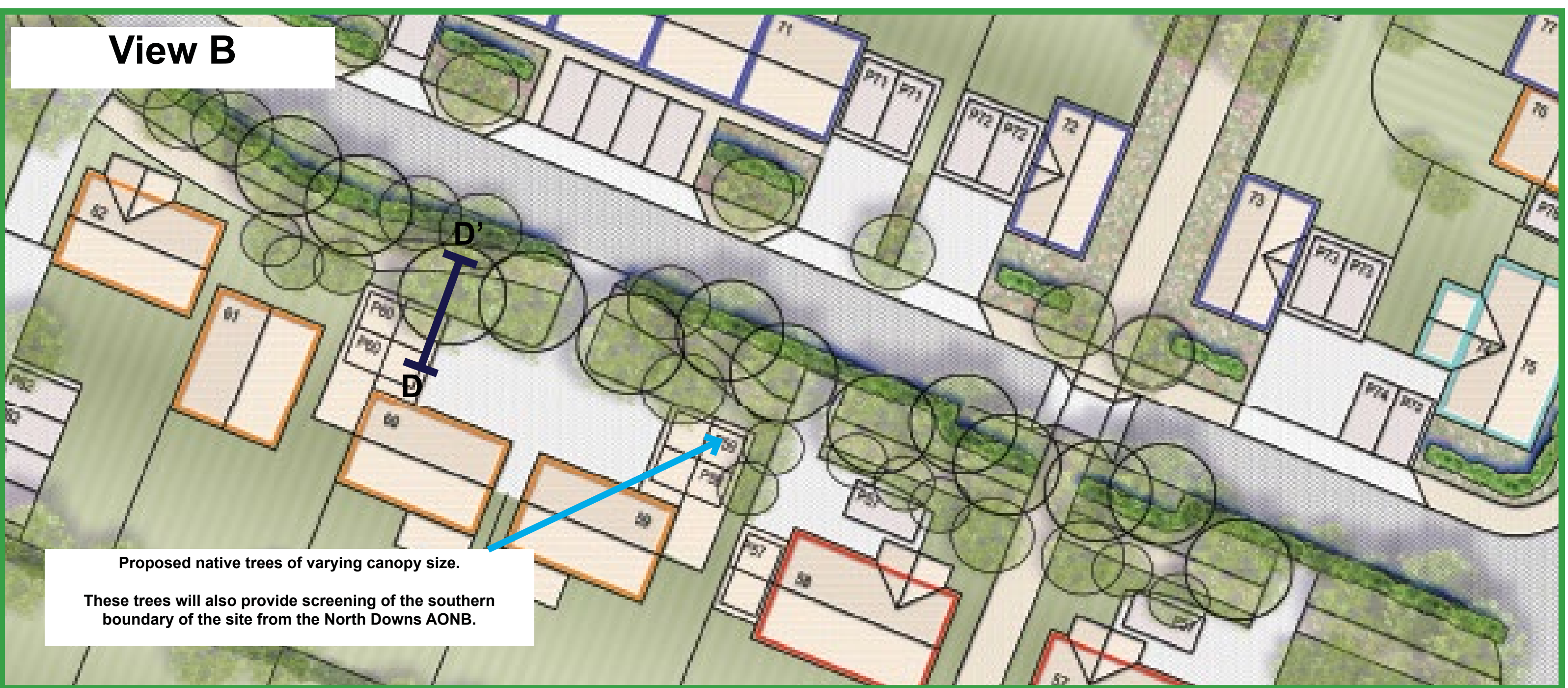

View 1 - Site as existing This is taken some 530m north west of the site at some 150m AOD. (The site lies between the 115m and 110m contours). Part of the site is visible in the centre of this view. The rising ground seen below the horizon, is the land south of Lenham. The industrial units are clearly visible to the east of the site, particularly their white roofs. The community centre car park is visible through the trees and shrubs south of the A20 in winter but less so in summer due to foliage on the trees, hedges and scrub.



View 4 - Site as existing Taken some 500m north east of the site at a height of 150m on the Pilgrims Way P16W. Looking south west towards the site, the site is visible at the bottom of the slope and to the south of the trees and shrubs running along the northern boundary of the site. The recent residential development on Groom Way is visible to the west of the site. The industrial units to the east of the site are also clearly visible. The rising ground to the south of the site allows long distance views towards and beyond Headcorn.



View 1 - with proposed development and mitigation planting with 5-10 years establishment



View 4 - with proposed development and mitigation planting with 5-10 years establishment



View 1 - enlarged image of site area with 5-10 years of mitigation planting establishment



View 4 - enlarged image of site area with 5-10 years of mitigation planting establishment