

TYPE H - PRIVATE SALE

SEMI-DETACHED
4-bedroom 6-person
2.5-storey

THIS DRAWING IS FOR THE PURPOSE OF PLANNING APPLICATION ONLY AND SHOULD NOT BE USED FOR ANY OTHER PURPOSE.

READ IN CONJUNCTION WITH PROPOSED SITE PLAN DRAWING P100, REV A.

General notes:
do not scale from the drawing, all dimensions shall be checked on site prior to commencing works.
all works shall conform to the current edition of the building regulations and other relevant statutory requirements.
all materials and workmanship shall conform with the relevant british standard specifications and codes of practice.
this drawing is the copyright of gdm architects and shall not be copied or reproduced without permission.
this drawing shall be read in conjunction with gdm architect's health and safety risk assessments and all works shall be carried out in a safe manner, by competent persons.
drawing produced by gdm architects ltd trading as gdm architects. Subject to site survey and I.A. approvals.
© gdm architects ltd trading as gdm architects

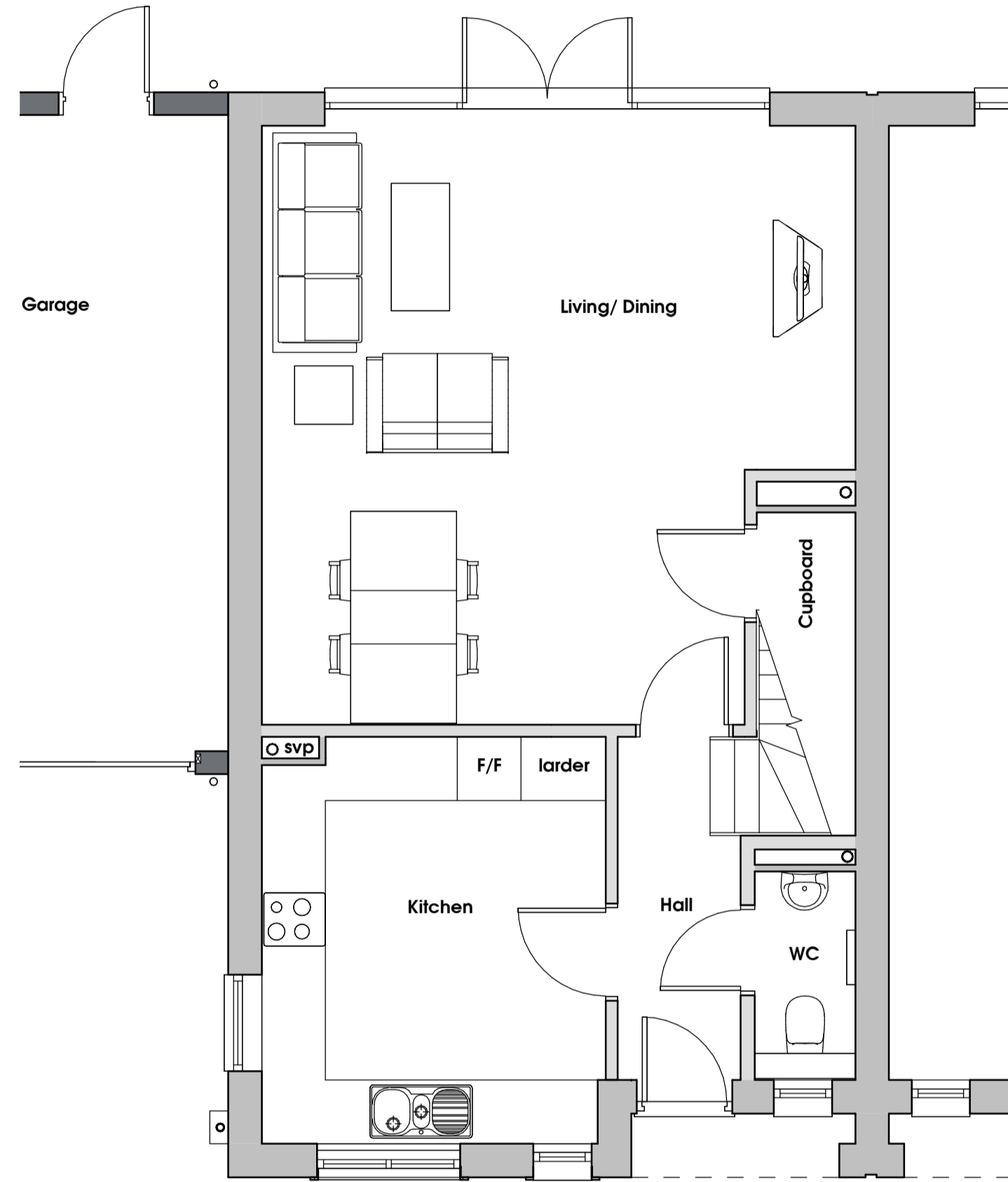

Ground Floor Layout

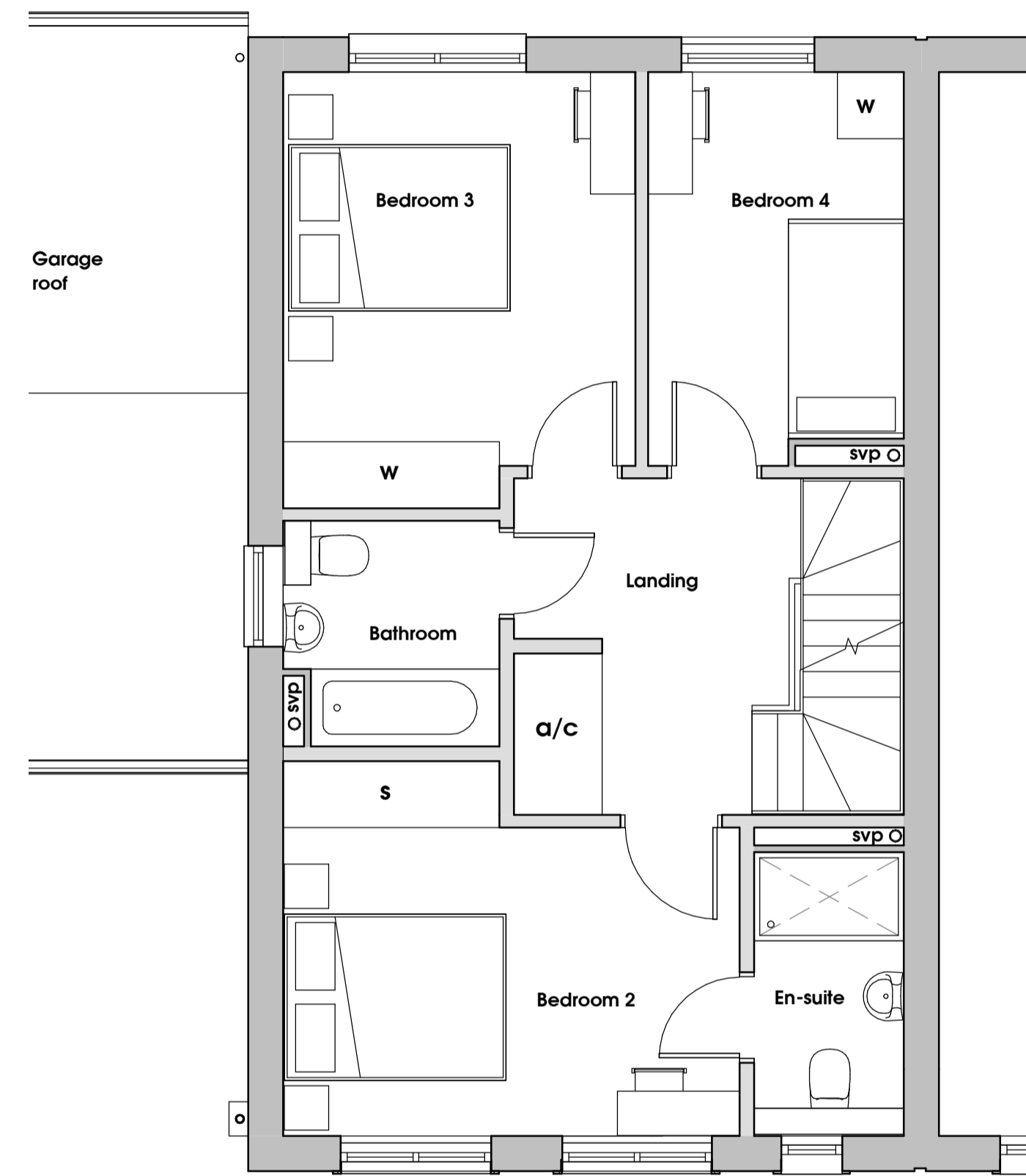

First Floor Layout

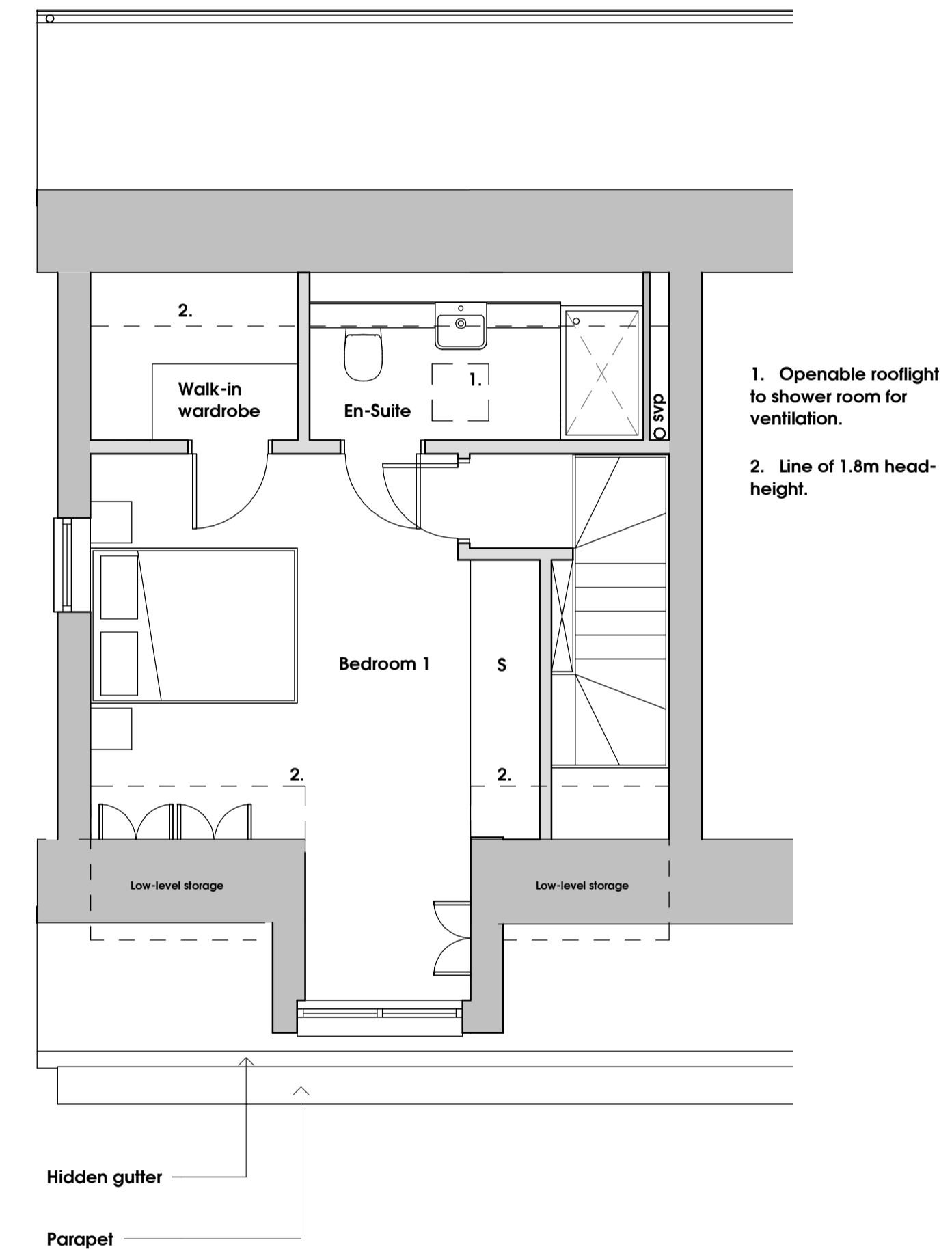

Second Floor Layout

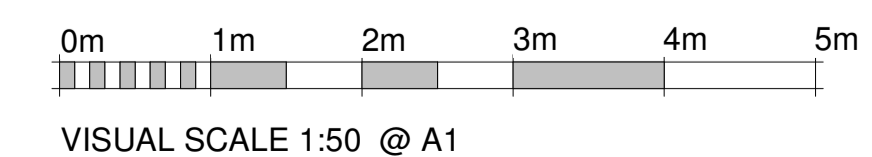

Rev	Description	Drawn	Date
A	PLANNING ISSUE	UT	27/06/19
-	For Client Comments	UT	06/06/19



the master's house, college road, maidstone, kent, ME15 6YF
t: 01622 760470 e: info@gdmarchitects.co.uk w: gdmarchitects.co.uk
client: Sunningdale House Dev's

project: Freeman's Way, Deal

drawing: Housetype H Plans

date: 27/06/2019 drawn by: ut

scale: 1 : 50 @A1 checked: km/ge

FOR PLANNING

project number	drawing number	revision
3987	P218	A