

Allocated Bins and Collection

Each property is allocated 1 each of the following bins.

- Black Lid Refuse Bin
W 50cm x D 74cm x H 109cm
- Blue Lid Recycling Bin
W 50cm x D 74cm x H 109cm
- Black Recycling Box
W 56cm x D 44cm x H 36cm
- Food Waste Bin
W 31cm x D 40cm x H 38cm

Mid terrace plots are to keep their bins in a screened bin store to the front of their property and move to the front edge of their boundary on collection day.

Plots 57-62 are to move their bins to the collection point shown on collection day.

Remaining plots are to store their bins in the back garden and move them to the front edge of their boundary on collection day.

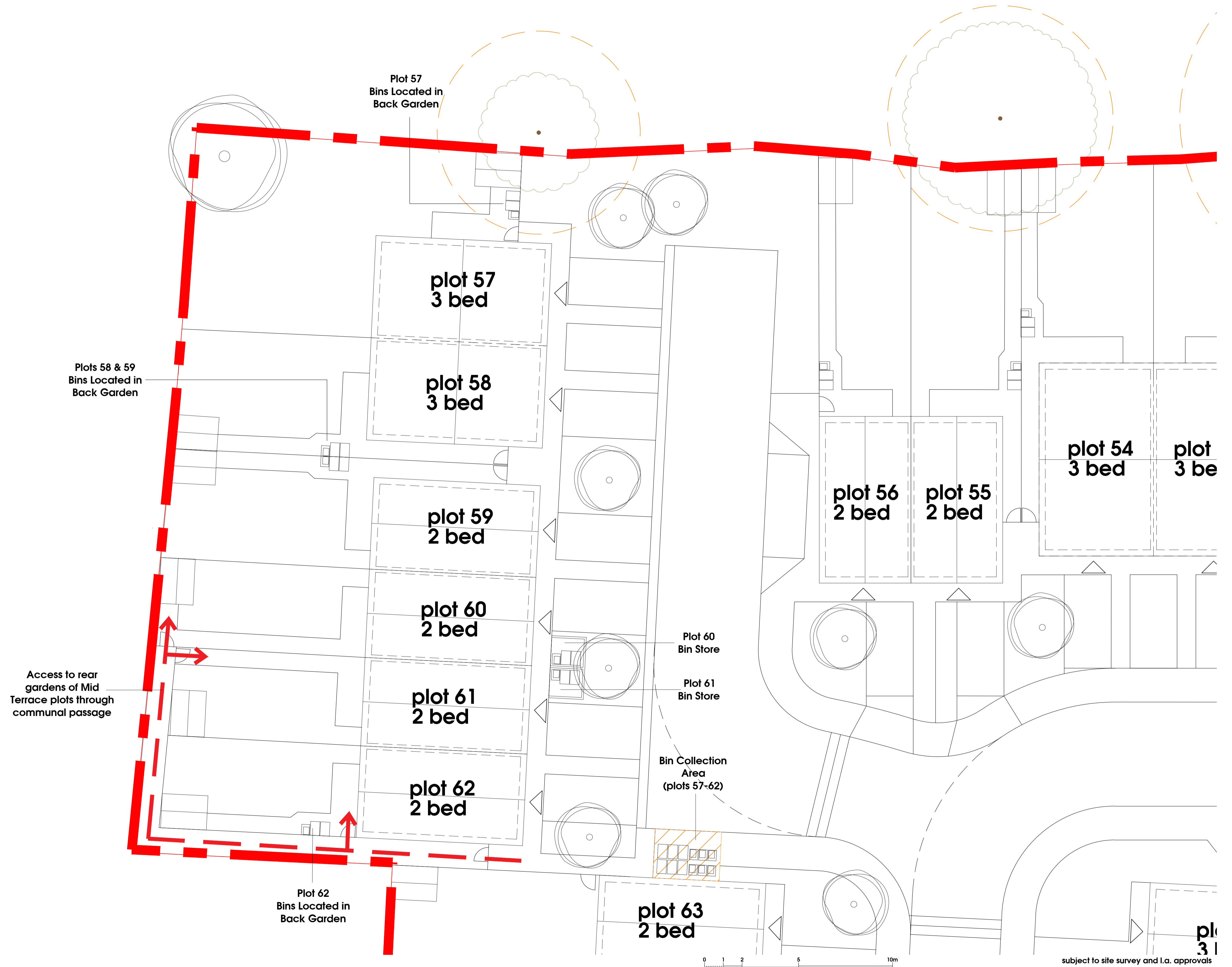

THIS DRAWING IS FOR THE PURPOSE OF PLANNING APPLICATION ONLY AND SHOULD NOT BE USED FOR ANY OTHER PURPOSE.

Freemen's Way, Deal

typical rear access & refuse diagram

number: 3987/p107b | date: mar 2020 | scale: 1:100@A3 | dm: lh chkd: ut appd: ut

subject to site survey and I.A. approvals
client: Sunningdale House Developments

gdm architects

gdm architects
the master's house, college road,
maidstone, kent, ME15 6RQ
info@gdmarchitects.co.uk
www.gdmarchitects.co.uk
© copyright gdm architects ltd