



LEGEND - MAINS		MATERIALS	
—	Distribution Main / Communication pipe	AK	Asbestos
—	Trunk Main	CI	Cast iron
—	Raw water main	CO	Concrete
—	Non potable	DI	Ductile iron
—	Abandoned main	BAC	Bonded Asbestos Cement
—	Proposed Main	GRP	Glass reinforced plastic
—	Fire main	GRE	Glass reinforced epoxy
—	Non SWS	PVC	Polyvinyl chloride
—	Sludge valve	PE	Polyethylene
—	Closed valve	ST	Steel
—	Air valve	CSB	Concrete segments bolted
—	Butterfly valve	CSU	Concrete segments unbolted
—	Pressure reducing valve	GI	Galvanized iron
—	Reflex valve	DS	Ductile sleeve
—	Motorised valve	CPS	Concrete pre-stressed
—	Clockwise closing valve	HPE	High performance polyethylene
—	Fire Hydrant	??	Unknown
—	Washout		
—	Washout hydrant		
—	Meter		
—	Capped end		
—	Emptying plug		
—	Stopcock		
—	Leak Noise Correlator Survey Point		
—	Anode		
—	Telemetry cable		
—	Access point / hatchbox		
—	Dialysis machine		
—	Break pressure tank		
—	Change node		
—	Pumping station		
—	Booster station		
—	Insertion Flow Meter Point		
—	Water tower		
—	Service reservoir		
—	Water Supply Works		
—	Bore hole / Well		
—	Intake		
—	Customer site		
—	Swab insertion point		

O.S. Ref.	AK
TQ7763SW	CI
	CO
	DI
	BAC
	GRP
	GRE
	PVC
	PE
	ST
	CSB
	CSU
	GI
	DS
	CPS
	HPE
	??

Drawn by:	spaceyk
Scale:	1:2500
Date:	04/02/2014

The positions of pipes shown on this plan are believed to be correct, but Southern Water Services Ltd accept no responsibility in the event of inaccuracy. The actual position of pipes must be determined on site.

WARNING: BAC pipes are constructed of Bonded Asbestos Cement
WARNING: Unknown (UNK) materials may include Bonded Asbestos Cement

Based upon Ordnance Survey Digital Data with the permission of the Controller of H.M.S.O. Crown Copyright Reserved Licence No. WU298530

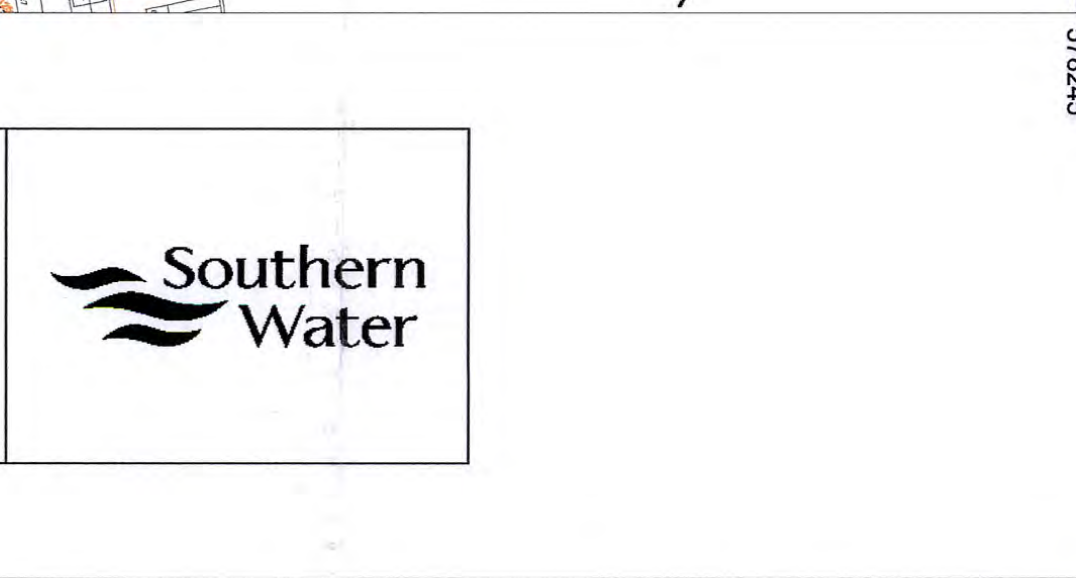
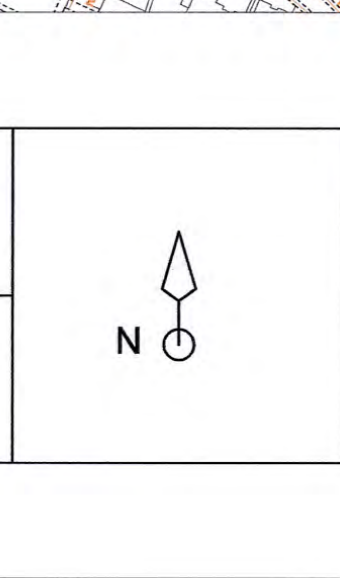

Title: 167518_Gibraltar Farm_1