

Existing Basement Floor Plan

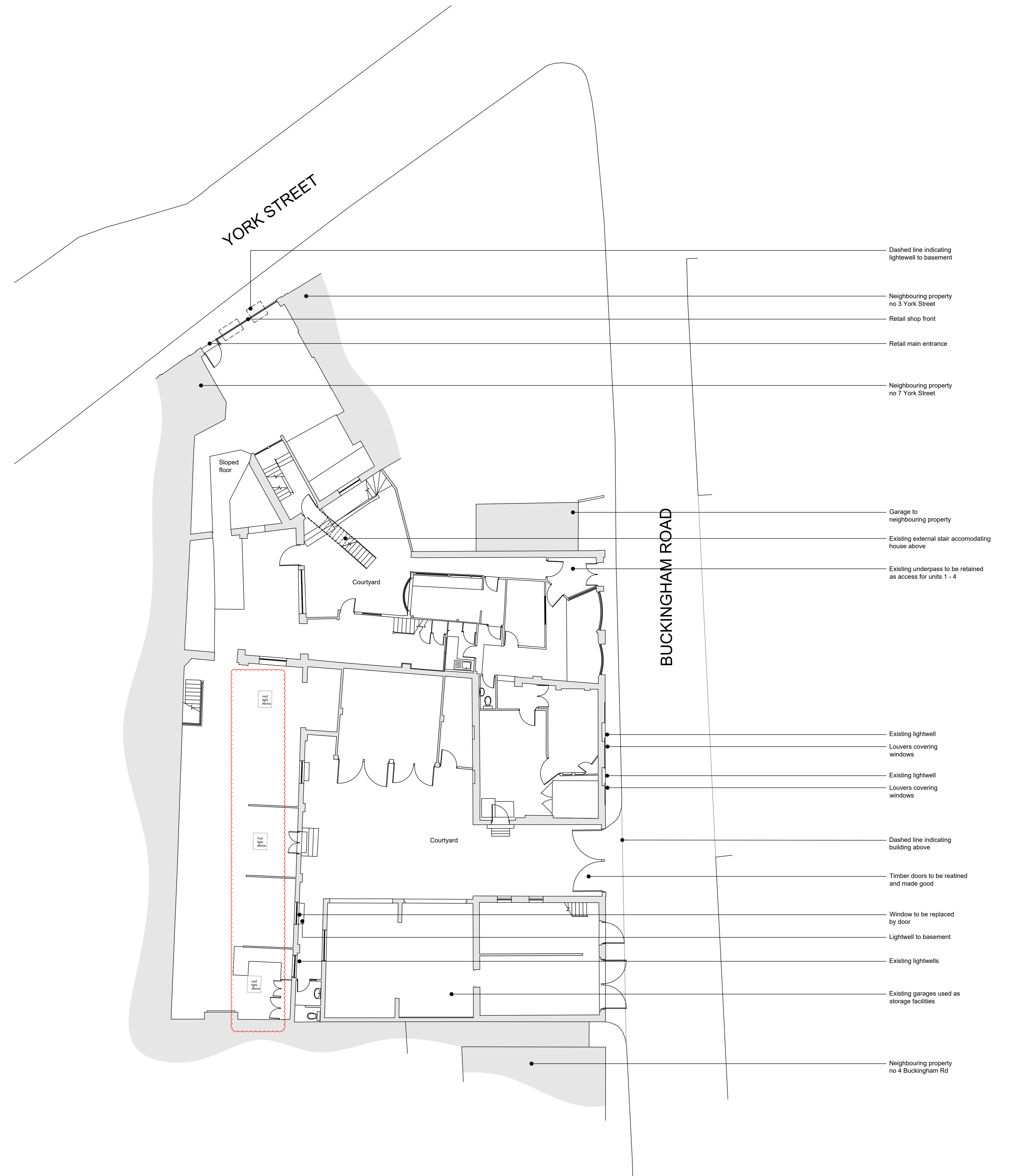

Existing Ground Floor Plan

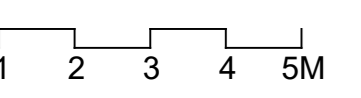

**CONVERSION OF 5 YORK STREET
EXISTING BASEMENT & GROUND FLOOR PLANS**

The drawing is the copyright of **guy holloway** architects and should not be copied, reproduced or used in any way without their consent. All Rights Reserved.
All dimensions are to be checked on site prior to construction and the Architect should be notified of any discrepancy.
Do not scale from this drawing.

PLANNING

<p>Revisions</p> <p>A GENERAL AMENDMENTS FOLLOWING SURVEY DATA B Drawing amendments to rooflights</p>	<p>AD 25.01.20 AB 26.01.20</p>	<p>Project Conversion of 5 York Street 5 York Street, Broadstairs, Kent</p> <p>Client Gilly Love</p> <p>Title Existing Basement & Ground Floor Plans</p> <p>Scale PLANNING</p> <p>Scale(s) 1:100 Date 19.08.19 Drawn AD Checked DS</p>	<p>London Fourth Floor 201 Parkside Road London N1 1PG T +44 (0)20 7014 4000 F +44 (0)20 7014 4000 E enquiries@guyholloway.co.uk W www.guyholloway.co.uk</p> <p>Kent The Terrace Studios Broadport Road Hythe Kent CT21 3SG T +44 (0)1803 289310 F +44 (0)1803 289214 E enquiries@guyholloway.co.uk W www.guyholloway.co.uk</p> <p>Project Number Drawing Number Revision 18.071 04 B</p>
---	------------------------------------	--	---

