

PLAN ECO3b

Bat Re-entry Survey Results 12.09.18



KEY:

-  SITE BOUNDARY
-  MYOTIS SPECIES REGISTRATION
-  COMMON PIPISTRELLE REGISTRATION
-  SOPRANO PIPISTRELLE REGISTRATION
-  MYOTIS SPECIES FLIGHT PATH
-  BROWN LONG-EARED BAT FLIGHT PATH
-  SOPRANO PIPISTRELLE FLIGHT PATH
-  COMMON PIPISTRELLE / MYOTIS FLIGHT PATH



Cokenach Estate
Barkway | Royston
Hertfordshire | SG8 8DL

+44(0)1763 848084
east@ecologysolutions.co.uk
ecologysolutions.co.uk

7867:
QUEEN COURT FARM BARNs,
OSPRINGE, FAVERSHAM, KENT

PLAN ECO3b: BAT RE-ENTRY
SURVEY RESULTS 12.09.18

Rev: A
Aug 2019

PLAN ECO3c

Bat Emergence Survey Results 22.05.19

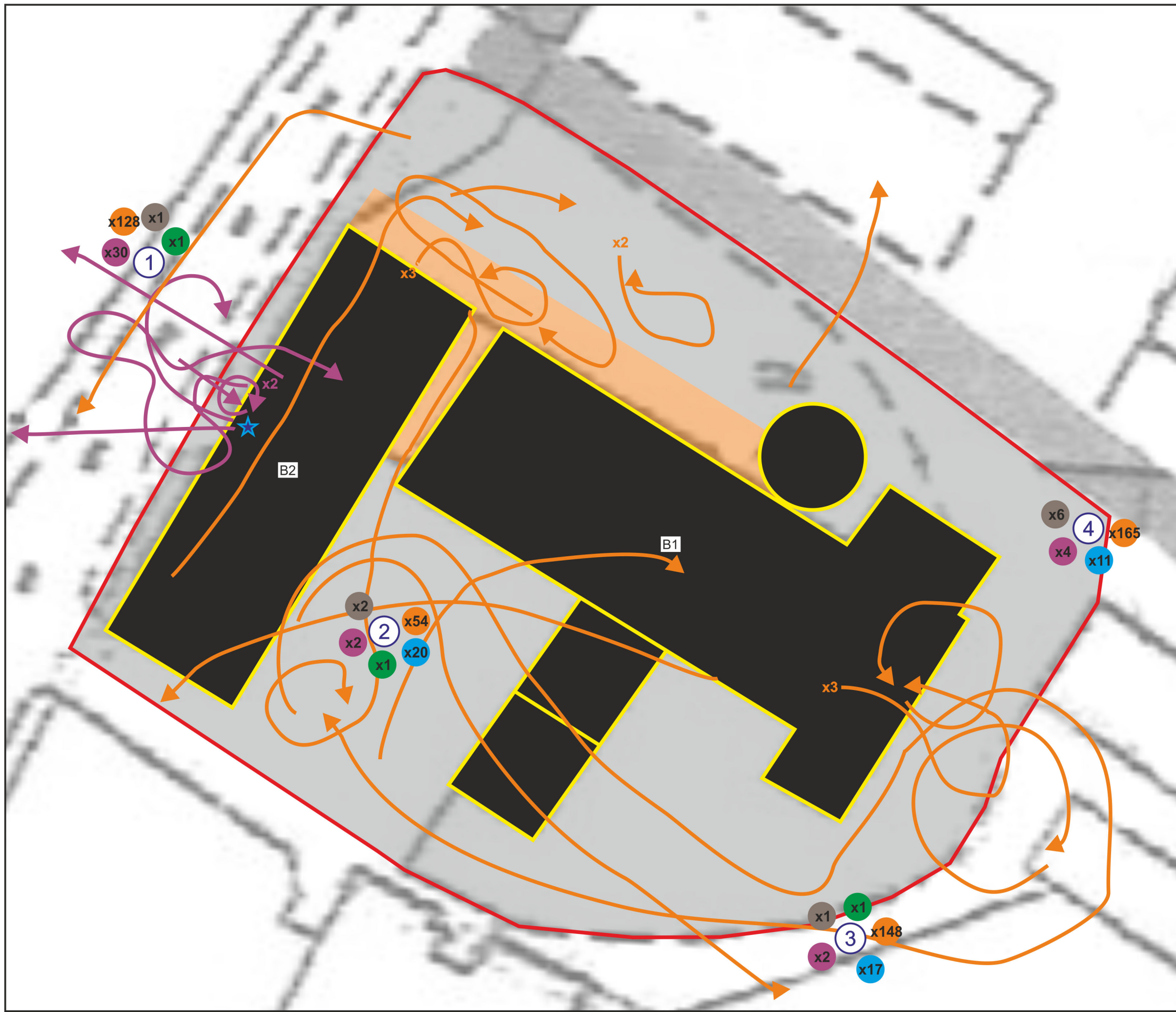

- KEY:**
- SITE BOUNDARY
 - BROWN LONG-EARED BAT REGISTRATION
 - MYOTIS SPECIES REGISTRATION
 - COMMON PIPISTRELLE REGISTRATION
 - SOPRANO PIPISTRELLE REGISTRATION
 - NOCTULE BAT REGISTRATION
 - MYOTIS SPECIES FLIGHT PATH
 - COMMON PIPISTRELLE FLIGHT PATH
 - CONFIRMED EMERGENCE



 ECOLOGY SOLUTIONS <small>Part of the ES Group</small>	Cokenach Estate Barkway Royston Hertfordshire SG8 8DL +44(0)1763 848084 east@ecologysolutions.co.uk ecologysolutions.co.uk
	7867: QUEEN COURT FARM BARNs, OSPRINGE, FAVERSHAM, KENT
PLAN ECO3c: BAT EMERGENCE SURVEY RESULTS 22.05.19	Rev: A Aug 2019

PHOTOGRAPHS

PHOTOGRAPH 1: Exterior of building B1



PHOTOGRAPH 2: Units adjoining building B1

