

Drainage Notes

- 1.0 General
 - 1.1 All dimensions are in millimetres.
 - 1.2 Do not scale from this drawing.
 - 1.3 All workmanship and materials are to be in accordance with (i) Sewers for Adoption 7th Edition (ii) the Building Regulations.
 - 1.4 The Contractor must refer to the documents listed and must not rely solely on the following notes.
- 2.0 Drainage General
 - 2.1 Before commencing construction the contractor must check the invert levels of any existing or proposed drains, sewers or outfalls to which connections are to be made.
 - 2.2 Cover levels are shown for guidance only. Final levels to be determined on site. Where affected by proposed works existing covers are to be adjusted as necessary.
 - 2.3 Drainage must be laid from the outfall upwards.
 - 2.4 Any existing drainage encountered during the course of the works is to be broken out unless it is found to be live in which case it must be diverted and/or re-connected to the site drainage system.
 - 2.5 Drains and sewers, once laid, must be protected from the effects of construction traffic.
- 3.0 Private Drainage
 - 3.1 Private drainage both foul and surface water is to be Marley Shallow Access or Osma or similar system constructed in accordance with BS EN 752 and Approved Document H of The Building Regulations. UPVC pipework is to comply with BS EN 1401-1:1998 or if clayware is used it shall comply with BS EN 295.
 - 3.2 Drains passing through footings are to be bridged by precast concrete lintels of adequate strength where necessary. Minimum clearance below lintel to be 50mm. Openings each side of the footing to be closed with rigid sheet material.
 - 3.3 Pipes beneath floor slabs are to be surrounded with granular material which is to be taken up to the oversite level unless shown otherwise. Underfloor pipes are not to be suspended from floor slabs or beams.
 - 3.4 Pipe runs adjacent to proposed foundations are to be installed in accordance with clause 2.25 of the Building Regulations part H.
 - 3.5 All gullies are to be trapped and roddable and fitted with fixed or hinged gratings.
 - 3.6 The base of each rainwater pipe must be fitted with an access plate unless it is connected directly to an inspection chamber.
- 4.0 Adoptable Drainage
 - 4.1 The sewer connection to the existing public sewer within Bortals Hill is to be constructed in accordance with Sewers for Adoption 7th Edition.
 - 4.2 All adoptable sewers and connections to adopted sewers shall be Hepworth SuperSeal clayware and shall comply with BS EN 295.

5.0 Potential Risks

The attention of the Client and the Principal Contractor is drawn to the following potential risks in connection with the proposed works as designed for this project.

- 5.1 The works will entail excavation in ground which could be unstable and therefore appropriate support, barriers and safety measure must be provided.
- 5.2 Works in the vicinity of live services including gas and electricity will be necessary and the advice of all statutory service companies must be sought before any works commence. The advice obtained must be followed.
- 5.3 Confined Spaces:
 - a) In making connection to existing sewers and drainage installations, man entry to confined spaces will be required and all appropriate safety precautions must be followed including the use of gas detection apparatus and the provision of emergency escape sets, one set for each person entering the confined space.
 - b) The apparatus and equipment must be maintained in full working order at all times.
 - c) Only suitably trained persons should enter confined spaces.
 - d) The same precautions must be followed during future inspection and/or maintenance of any part of the completed drainage system.
 - e) the risks and hazards which might be present in a confined space and during entry thereto and egress therefrom include: (i) Oxygen deficient air from surrounding ground; (ii) Explosive gas; (iii) Toxic gas; (iv) Depth and/or velocity of fluid contents; (v) Inrush of fluids causing flooding; (vi) Health hazards from sewage; (vii) Physical injury from slipping or falling.
- 5.4 Hazardous materials, including sealants, cement and bituminous materials, are specified and the manufacturer's advice on safe handling procedures must be obtained, followed and made clear to all operatives.

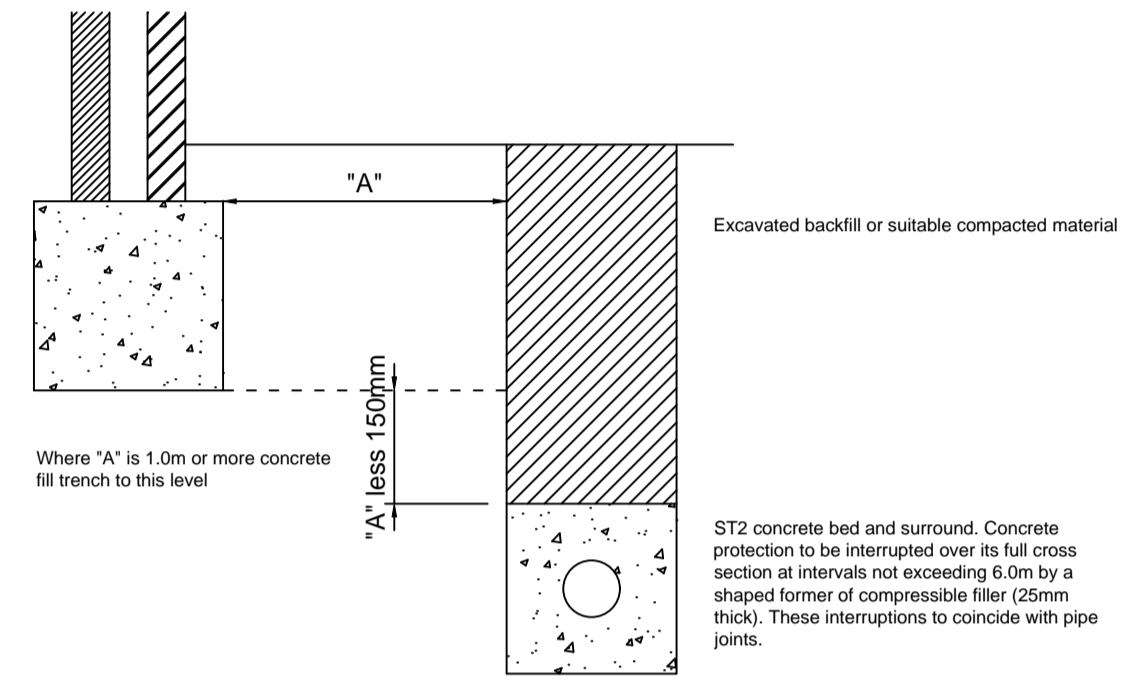
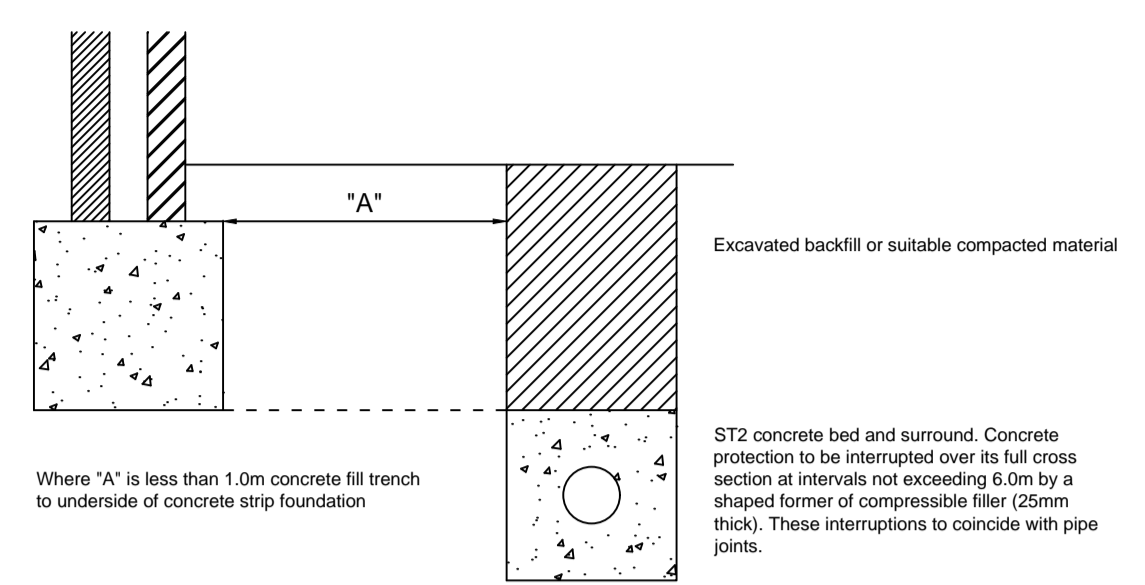

Pipe runs near buildings

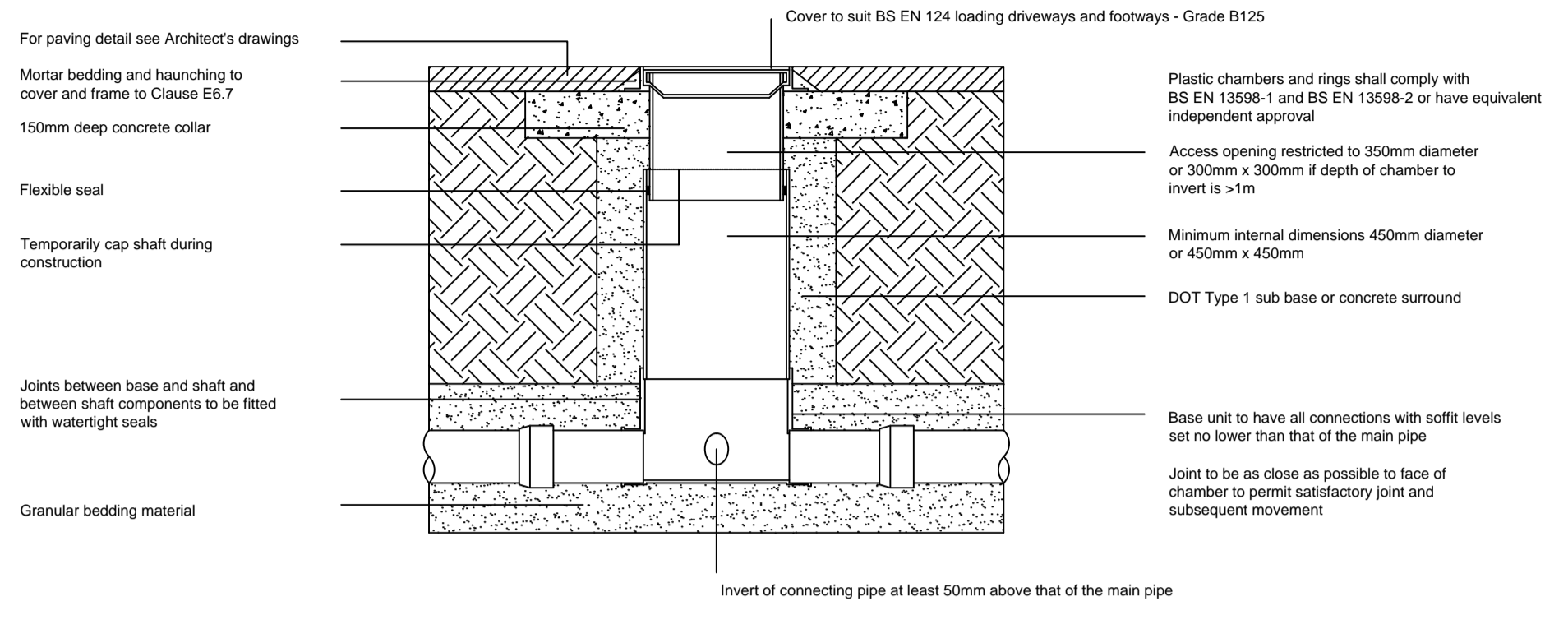

Type 3 Access Chamber Detail

To be constructed in accordance with Sewers for Adoption 7th Edition.

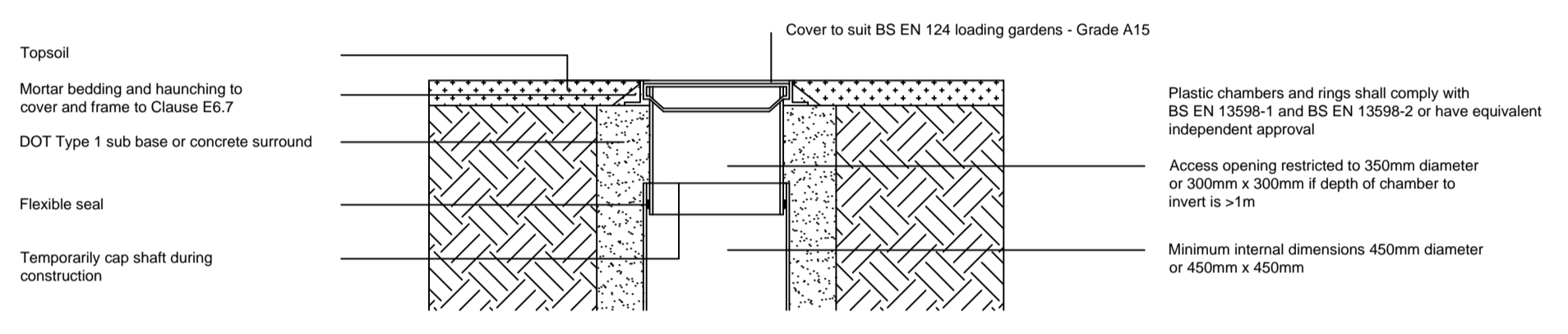

Alternative Top Detail for Domestic Gardens

Notes:
Please report all discrepancies, errors and omissions.
Verify all dimensions on site before commencing any work on site or preparing shop drawings.
All materials, components and workmanship are to comply with the relevant British Standards, Codes of Practice, and appropriate manufacturers recommendations that from time to time shall apply.
For all specialist work, see relevant drawings.
This drawing and design are copyright of RMB Consultants (Civil Engineering) Ltd.
When this document is provided in electronic file format it is intended as a guide only and the recipient is to verify all dimensions and details with the Architects. If this is not acceptable, the files must be returned unused together with a written communication declining acceptance of this condition.

Notes

Distance between lowest connection to stack and drain invert must be 450mm min for buildings up to 3 storeys and 750mm min for buildings up to 5 storeys.

Depth of cover to crown of gravity pipes without protection to be as follows:

Location	Depth
domestic gardens and pathways (no vehicular access)	0.35m
domestic driveways, parking areas etc (vehicles <7.5)	0.5m
domestic driveways, parking areas etc (limited access for vehicles >7.5)	0.9m
public open space	0.9m
highways and parking areas (vehicles >7.5)	1.2m

depth of cover as shown in notes
75mm deep lintel unless specified otherwise on structural engineering drawings.
For sealing of gaps refer to pipes through walls detail

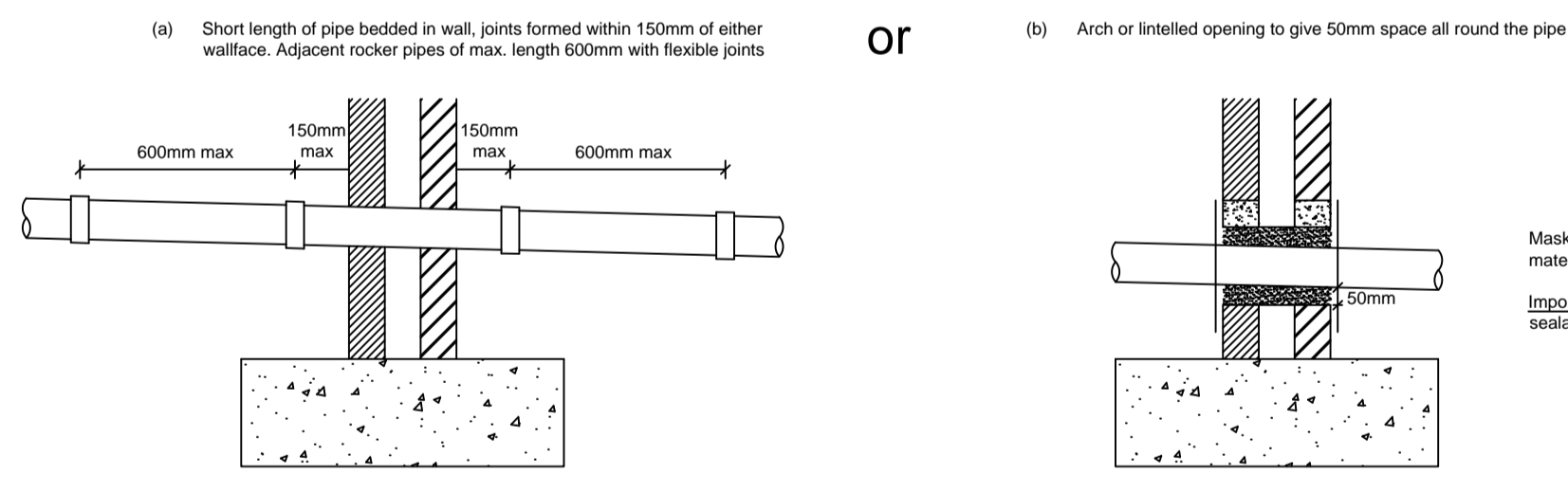

Pipes through walls

Soil and vent pipe connection and stub stack connection

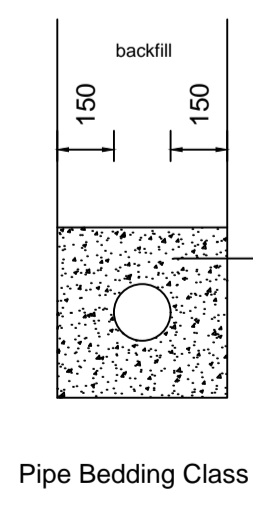
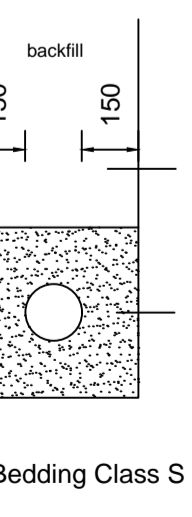
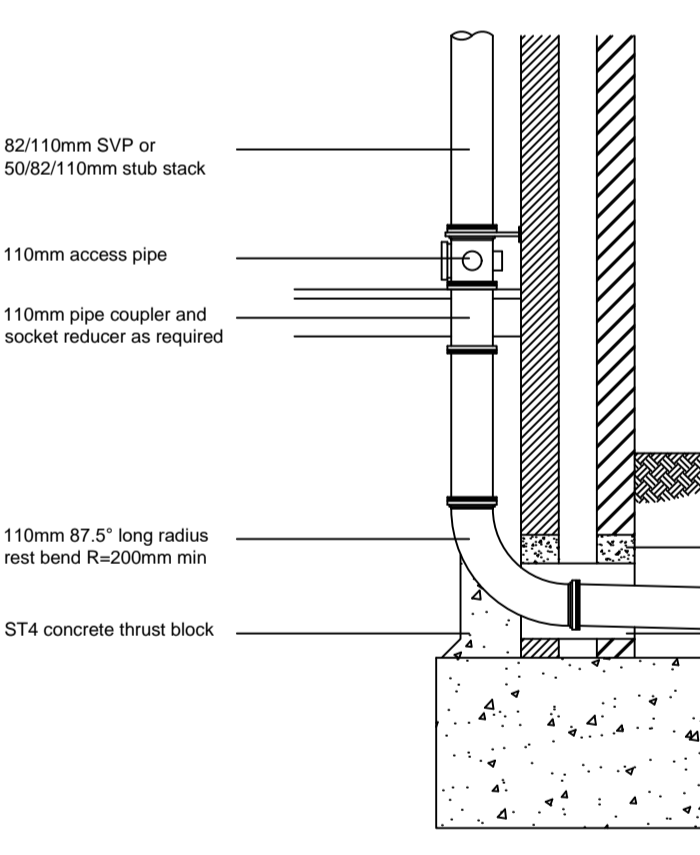

Bedding details

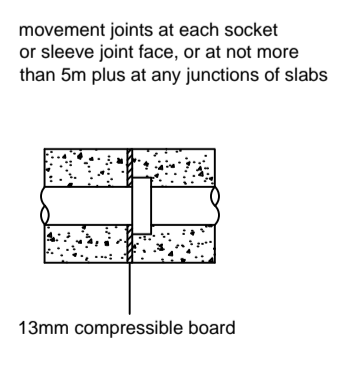
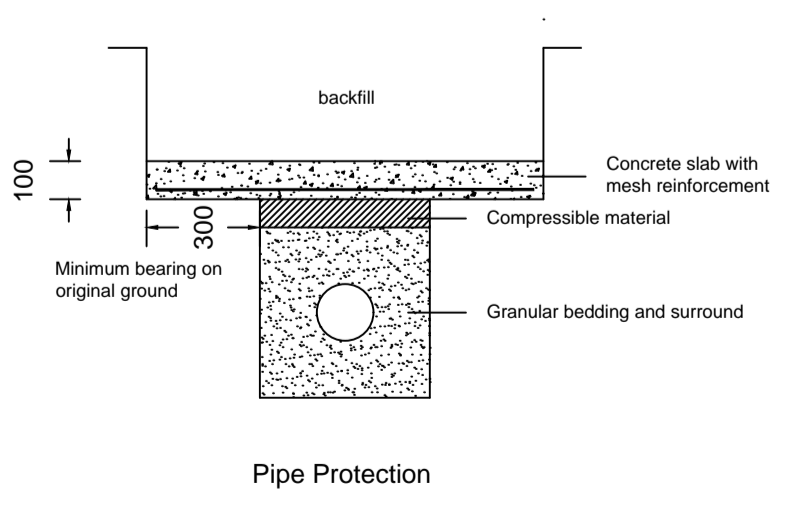

Pipe Protection

Type 4 Access Chamber Detail

To be constructed in accordance with Sewers for Adoption 7th Edition.

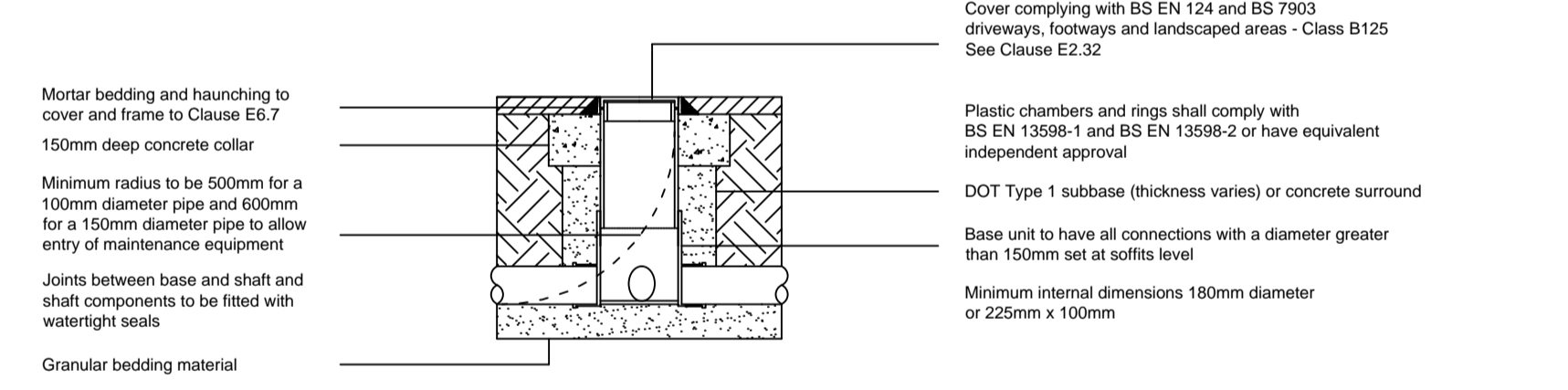

Alternative Top Detail for Domestic Gardens

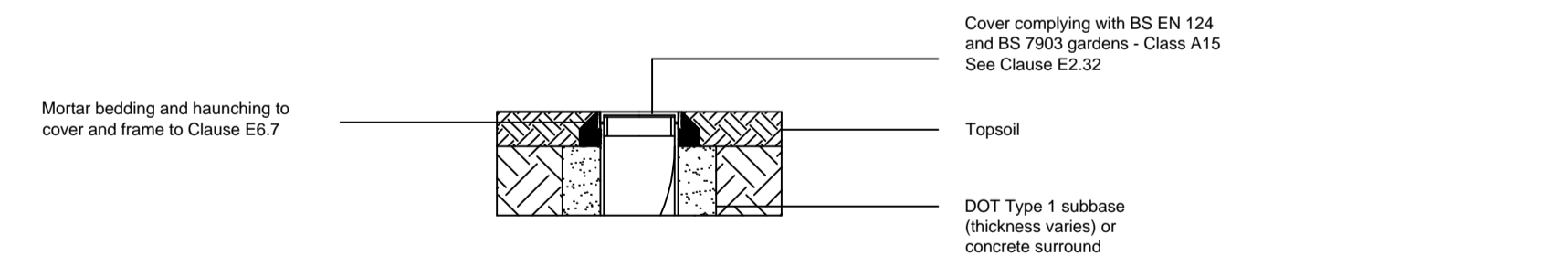

Rodding eye

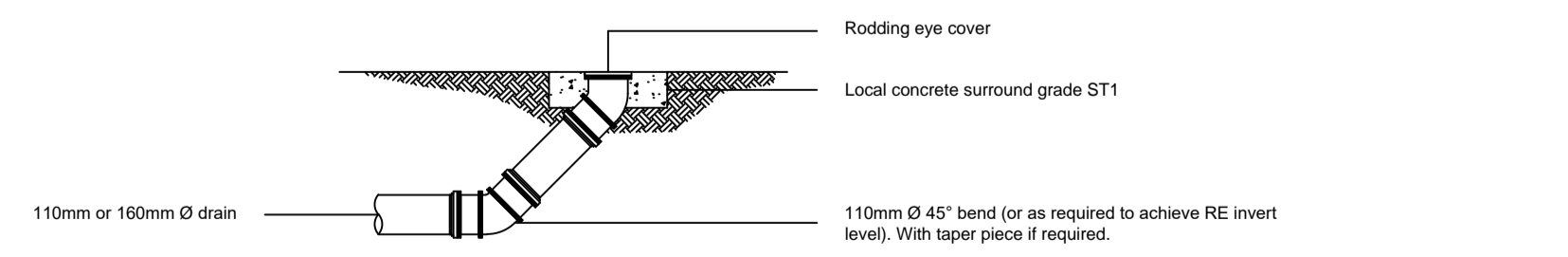

Rev.

All works to comply with Sewers for Adoption 7th Edition.



39 Cossington Road Canterbury Kent CT1 3HU Tel/Fax: 01227 472128 • Mobile: 07886 183705 www.rmbconsultants.co.uk • robert.bird@rmbconsultants.co.uk		
client Wilson Residential (South East) Ltd	project 66 Borstal Hill Whitstable CT5 4NB	
scale 1:20 @ A1	date August 2019	drawing no. 908/301
		drawn by RB