



**Contact Us**  
**Mapping Enquiries:** All areas  
**General Enquiries:** All areas

Date Requested: 28/06/2021  
 Job Reference: 22527418  
 Site Location: 579127 137777  
 Requested by:  
 Mr TDS Southern  
 Your Scheme/Reference:  
 Golding Homes

This plan shows the location of those pipes owned by Scotia Gas Networks (SGN) by virtue of being a licensed Gas Transporter (GT). Gas pipes owned by other GTs or third parties may also be present in this area but are not shown on this plan. Information with regard to such pipes should be obtained from the relevant owners. No warranties are given with regard to the accuracy of the information shown on this plan. Service pipes, valves, siphons, sub-connections etc. are not shown but their presence should be anticipated. You should be aware that a small percentage of our pipes/assets may be undergoing review and will temporarily be highlighted in yellow. If your proposed works are close to one of these pipes, you should contact the SGN Safety Admin Team on 0800 912 1722 for advice. No liability of any kind whatsoever is accepted by SGN or its agents, servants or sub-contractors for any error or omission contained herein. Safe digging practices, in accordance with HS (G)47, must be used to verify and establish the actual position of mains, pipes, services and other apparatus on site before any mechanical plant is used. It is your responsibility to ensure that plant location information is provided to all persons (whether direct labour or sub-contractors) working for you on or near gas apparatus. Information included on this plan should not be referred to beyond a period of 28 days from the date of issue.

**Report damage immediately – KEEP EVERYONE AWAY FROM THE AREA**  
**0800 111 999**

Low Pressure Mains	
Medium Pressure Mains	
Intermediate Pressure Mains	
High Pressure Mains	
LAs	
GTs	
SSSIs	

Some Examples Of Plant Items  
 Valve Syphon Depth of Cover Diameter Change Material Change

Digsite: Line: Area:



This plan is reproduced from or based on the OS map by Scotia Gas Networks plc, with the sanction of the controller of HM Stationery Office. Crown Copyright Reserved. Southern Gas – 100044373 and Scotland Gas – 100044366.

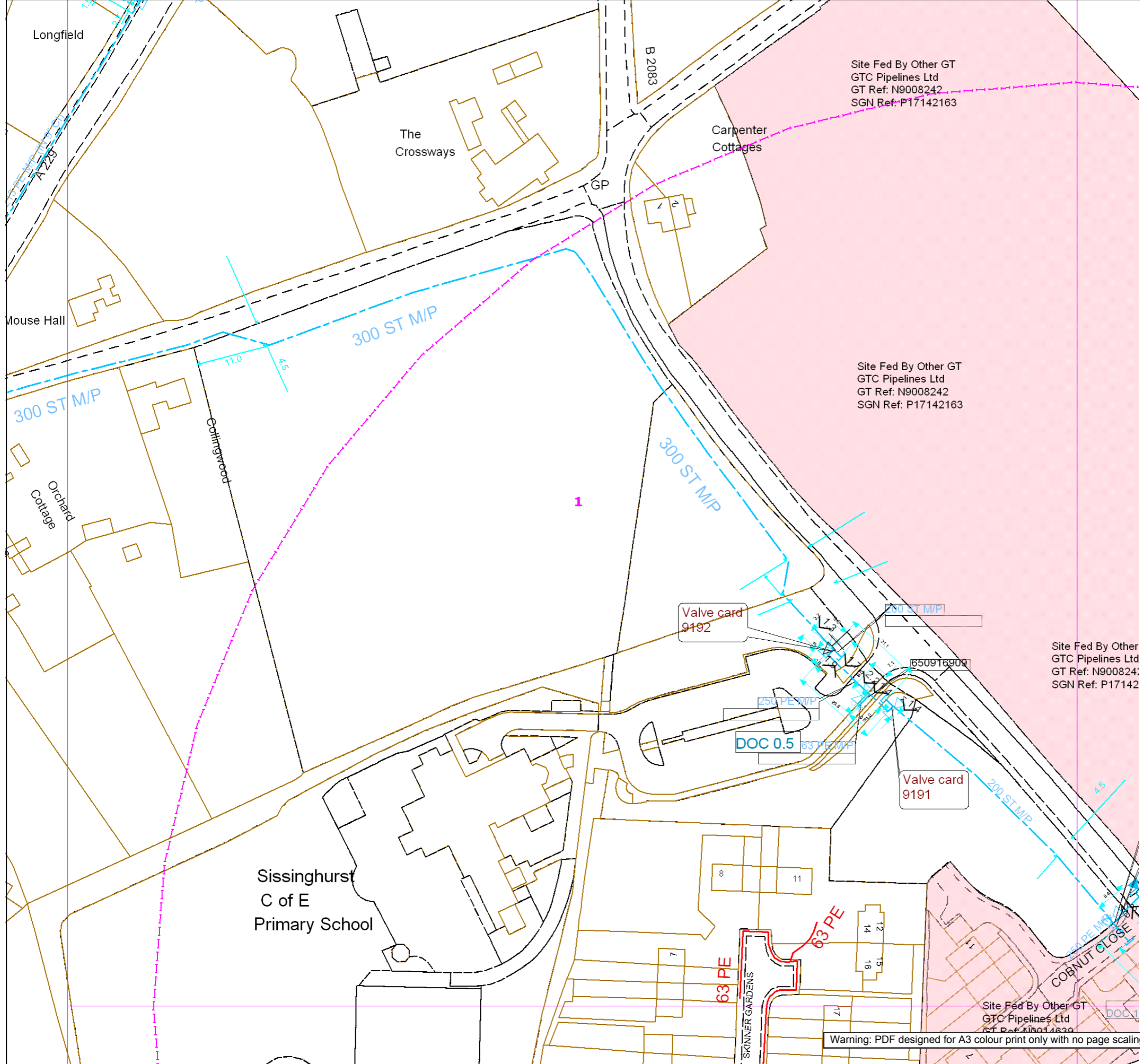

**Contact Us**  
**Mapping Enquiries:** All areas  
**General Enquiries:** All areas

Date Requested: 28/06/2021  
 Job Reference: 22527418  
 Site Location: 579127 137777  
 Requested by:  
 Mr TDS Southern  
 Your Scheme/Reference:  
 Golding Homes  
 Exact Scales:  
 1:1000 Area or Circle dig site  
 1:1000 Line dig site

This plan shows the location of those pipes owned by Scotia Gas Networks (SGN) by virtue of being a licensed Gas Transporter (GT). Gas pipes owned by other GTs or third parties may also be present in this area but are not shown on this plan. Information with regard to such pipes should be obtained from the relevant owners. No warranties are given with regard to the accuracy of the information shown on this plan. Service pipes, valves, siphons, sub-connections etc. are not shown but their presence should be anticipated. You should be aware that a small percentage of our pipes/assets may be undergoing review and will temporarily be highlighted in yellow. If your proposed works are close to one of these pipes, you should contact the SGN Safety Admin Team on 0800 912 1722 for advice. No liability of any kind whatsoever is accepted by SGN or its agents, servants or sub-contractors for any error or omission contained herein. Safe digging practices, in accordance with HS (G)47, must be used to verify and establish the actual position of mains, pipes, services and other apparatus on site before any mechanical plant is used. It is your responsibility to ensure that plant location information is provided to all persons (whether direct labour or sub-contractors) working for you on or near gas apparatus. Information included on this plan should not be referred to beyond a period of 28 days from the date of issue.

**Report damage immediately – KEEP EVERYONE AWAY FROM THE AREA**  
**0800 111 999**

- Low Pressure Mains —
- Medium Pressure Mains - - -
- Intermediate Pressure Mains - · - · -
- High Pressure Mains - - -
- LAs
- GTs  SSSIs

Some Examples Of Plant Items  
 Valve Syphon Depth of Cover Diameter Change Material Change

Digsite: Line: - - - - - Area:  



This plan is reproduced from or based on the OS map by Scotia Gas Networks plc, with the sanction of the controller of HM Stationery Office. Crown Copyright Reserved. Southern Gas – 100044373 and Scotland Gas – 100044366.

Warning: PDF designed for A3 colour print only with no page scaling.





**SGN**  
Your gas. Our network.

**Contact Us**

**Mapping Enquiries:**  
All areas

**General Enquiries:**  
All areas

Date Requested: 28/06/2021  
Job Reference: 22527418  
Site Location: 579127 137777  
Requested by:  
Mr TDS Southern  
Your Scheme/Reference:  
Golding Homes  
Exact Scales:  
1:1000 Area or Circle dig site  
1:1000 Line dig site

This plan shows the location of those pipes owned by Scotia Gas Networks (SGN) by virtue of being a licensed Gas Transporter (GT). Gas pipes owned by other GTs or third parties may also be present in this area but are not shown on this plan. Information with regard to such pipes should be obtained from the relevant owners. No warranties are given with regard to the accuracy of the information shown on this plan. Service pipes, valves, siphons, sub-connections etc. are not shown but their presence should be anticipated. You should be aware that a small percentage of our pipes/assets may be undergoing review and will temporarily be highlighted in yellow. If your proposed works are close to one of these pipes, you should contact the SGN Safety Admin Team on 0800 912 1722 for advice. No liability of any kind whatsoever is accepted by SGN or its agents, servants or sub-contractors for any error or omission contained herein. Safe digging practices, in accordance with HS (G)47, must be used to verify and establish the actual position of mains, pipes, services and other apparatus on site before any mechanical plant is used. It is your responsibility to ensure that plant location information is provided to all persons (whether direct labour or sub-contractors) working for you on or near gas apparatus. Information included on this plan should not be referred to beyond a period of 28 days from the date of issue.

**Report damage immediately – KEEP EVERYONE AWAY FROM THE AREA**  
**0800 111 999**

Low Pressure Mains	
Medium Pressure Mains	
Intermediate Pressure Mains	
High Pressure Mains	
LAs	
GTs	
SSSIs	

Some Examples Of Plant Items  
Valve Syphon Depth of Cover Diameter Change Material Change

Digsite: Line: Area:



This plan is reproduced from or based on the OS map by Scotia Gas Networks plc, with the sanction of the controller of HM Stationery Office. Crown Copyright Reserved. Southern Gas – 100044373 and Scotland Gas – 100044366.

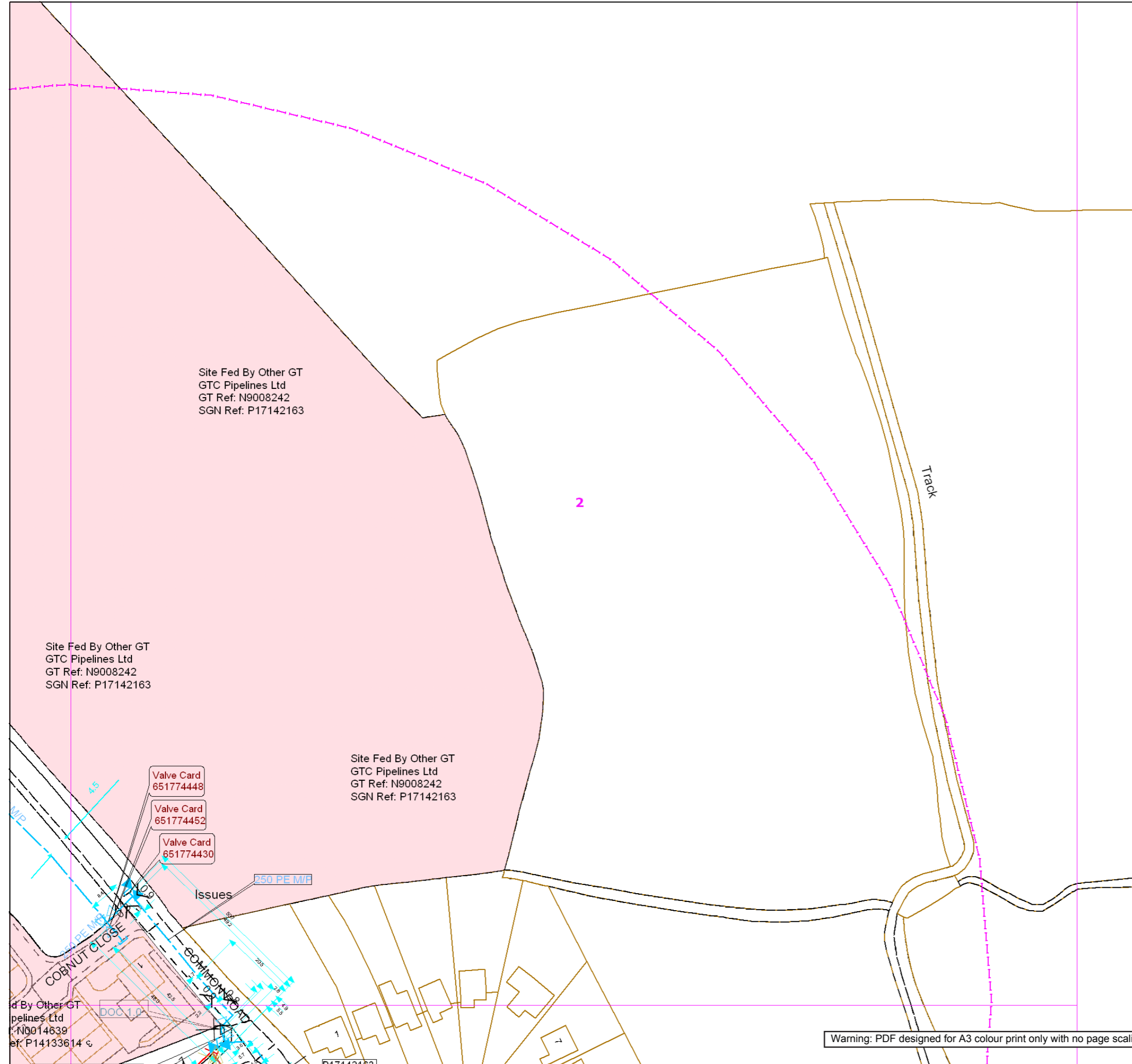

Warning: PDF designed for A3 colour print only with no page scaling.

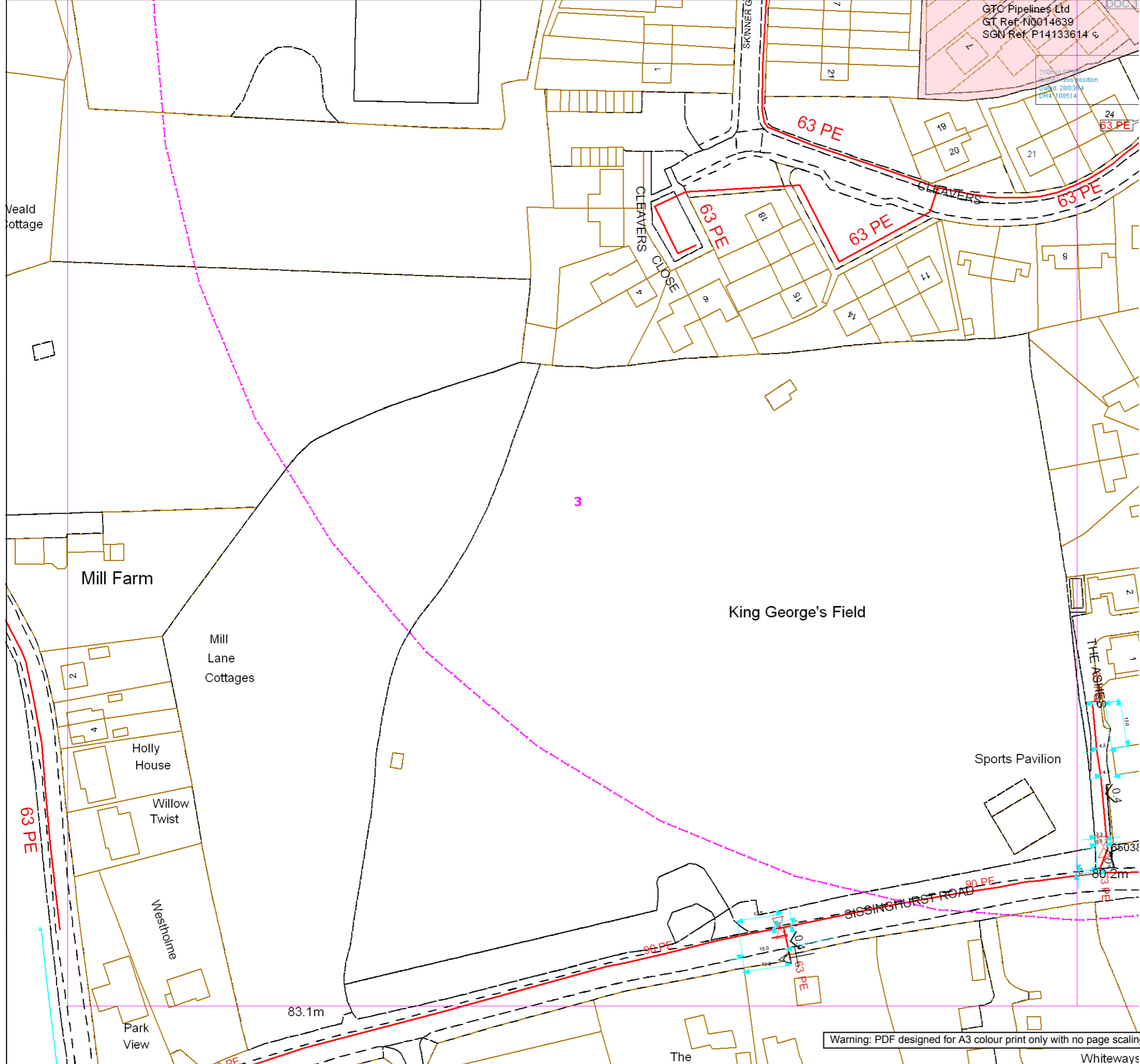

GTC Pipelines Ltd  
 GT Ref: N0014639  
 SGN Ref: P14133614



**Contact Us**  
**Mapping Enquiries:** All areas  
**General Enquiries:** All areas

Date Requested: 28/06/2021  
 Job Reference: 22527418  
 Site Location: 579127 137777  
 Requested by:  
 Mr TDS Southern  
 Your Scheme/Reference:  
 Golding Homes  
 Exact Scales:  
 1:1000 Area or Circle dig site  
 1:1000 Line dig site

This plan shows the location of those pipes owned by Scotia Gas Networks (SGN) by virtue of being a licensed Gas Transporter (GT). Gas pipes owned by other GTs or third parties may also be present in this area but are not shown on this plan. Information with regard to such pipes should be obtained from the relevant owners. No warranties are given with regard to the accuracy of the information shown on this plan. Service pipes, valves, siphons, sub-connections etc. are not shown but their presence should be anticipated. You should be aware that a small percentage of our pipes/assets may be undergoing review and will temporarily be highlighted in yellow. If your proposed works are close to one of these pipes, you should contact the SGN Safety Admin Team on 0800 912 1722 for advice. No liability of any kind whatsoever is accepted by SGN or its agents, servants or sub-contractors for any error or omission contained herein. Safe digging practices, in accordance with HS (G)47, must be used to verify and establish the actual position of mains, pipes, services and other apparatus on site before any mechanical plant is used. It is your responsibility to ensure that plant location information is provided to all persons (whether direct labour or sub-contractors) working for you on or near gas apparatus. Information included on this plan should not be referred to beyond a period of 28 days from the date of issue.

**Report damage immediately – KEEP EVERYONE AWAY FROM THE AREA**  
**0800 111 999**

- Low Pressure Mains —
- Medium Pressure Mains - - -
- Intermediate Pressure Mains - · - · -
- High Pressure Mains - · - · -
- LAs
- GTs
- SSSIs

Some Examples Of Plant Items  
 Valve Syphon Depth of Cover Diameter Change Material Change

Digsite: Line: - · - · - Area:



This plan is reproduced from or based on the OS map by Scotia Gas Networks plc, with the sanction of the controller of HM Stationery Office. Crown Copyright Reserved. Southern Gas – 100044373 and Scotland Gas – 100044366.



pelines Ltd  
 110014639  
 Ref: P14133614

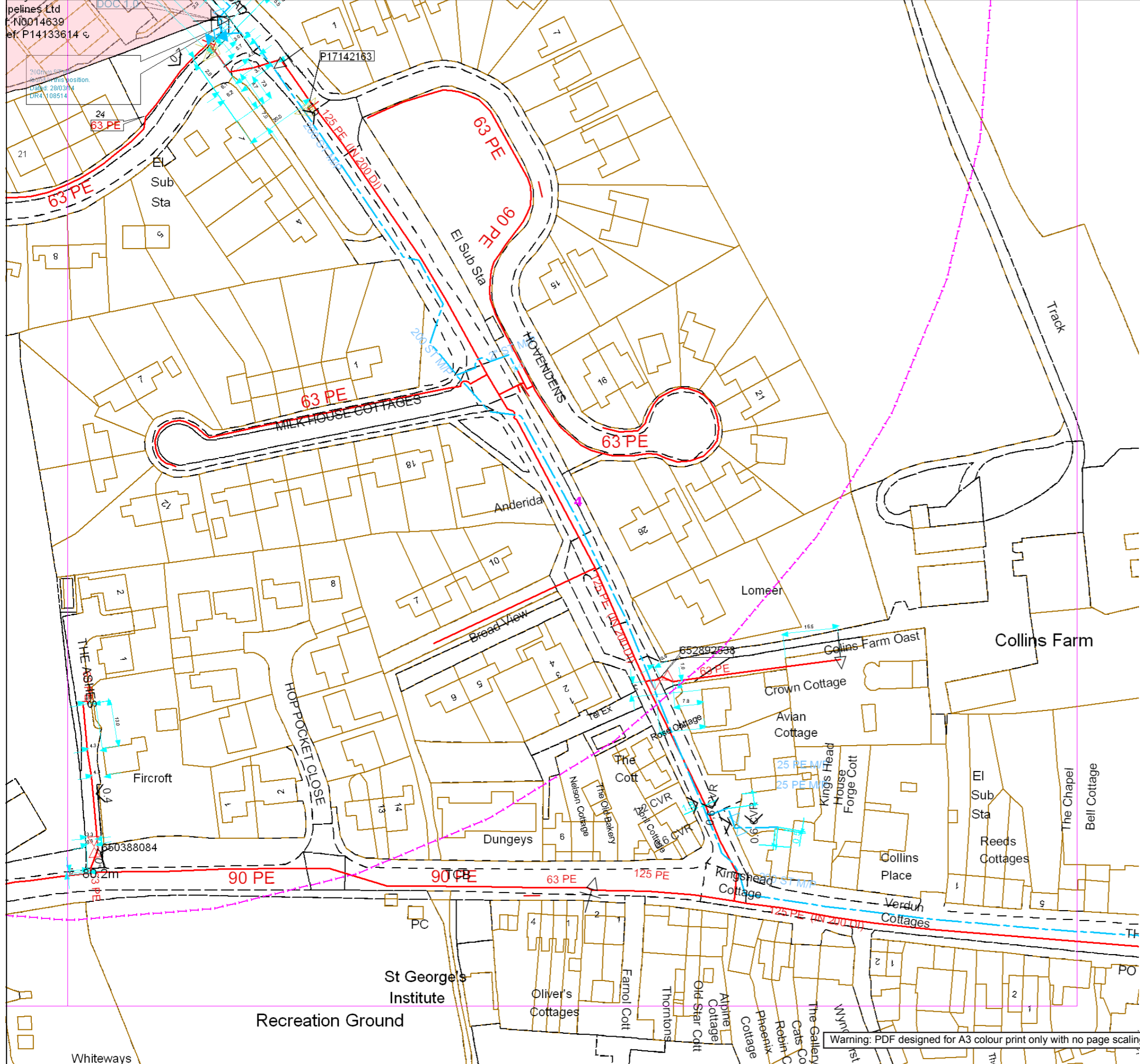

**Contact Us**  
**Mapping Enquiries:** All areas  
**General Enquiries:** All areas

Date Requested: 28/06/2021  
 Job Reference: 22527418  
 Site Location: 579127 137777  
 Requested by:  
 Mr TDS Southern  
 Your Scheme/Reference:  
 Golding Homes  
 Exact Scales:  
 1:1000 Area or Circle dig site  
 1:1000 Line dig site

This plan shows the location of those pipes owned by Scotia Gas Networks (SGN) by virtue of being a licensed Gas Transporter (GT). Gas pipes owned by other GTs or third parties may also be present in this area but are not shown on this plan. Information with regard to such pipes should be obtained from the relevant owners. No warranties are given with regard to the accuracy of the information shown on this plan. Service pipes, valves, siphons, sub-connections etc. are not shown but their presence should be anticipated. You should be aware that a small percentage of our pipes/assets may be undergoing review and will temporarily be highlighted in yellow. If your proposed works are close to one of these pipes, you should contact the SGN Safety Admin Team on 0800 912 1722 for advice. No liability of any kind whatsoever is accepted by SGN or its agents, servants or sub-contractors for any error or omission contained herein. Safe digging practices, in accordance with HS (G)47, must be used to verify and establish the actual position of mains, pipes, services and other apparatus on site before any mechanical plant is used. It is your responsibility to ensure that plant location information is provided to all persons (whether direct labour or sub-contractors) working for you on or near gas apparatus. Information included on this plan should not be referred to beyond a period of 28 days from the date of issue.

**Report damage immediately – KEEP EVERYONE AWAY FROM THE AREA**  
**0800 111 999**

**Low Pressure Mains** ———— (red solid line)  
**Medium Pressure Mains** - - - - - (blue dashed line)  
**Intermediate Pressure Mains** ······ (green dotted line)  
**High Pressure Mains** —·—·—· (yellow dash-dot line)

**LAs** (pink shaded area)  
**GTs** (green shaded area)

**SSSIs** (green shaded area)

Some Examples Of Plant Items  
 Valve ⊗ Syphon ○ Depth of Cover ∨ Diameter Change ⊕ Material Change |

**Digsite:** Line: - - - - - Area: [dashed outline]



This plan is reproduced from or based on the OS map by Scotia Gas Networks plc, with the sanction of the controller of HM Stationery Office. Crown Copyright Reserved. Southern Gas – 100044373 and Scotland Gas – 100044366.

Warning: PDF designed for A3 colour print only with no page scaling.