



planning
transport
design
environment
infrastructure

feasibility document

former playing fields, whitehill road,
gravesend, kent, DA12 5PJ

march 2020

Image Obtained Via Google Maps



Aerial Image of the Site



Aerial Image of the Site

Site Boundary

N

SITE PHOTOGRAPHS

Image Obtained Via Google Earth



Aerial Image of the Site in 1940



Aerial Image of the Site in 1960



Aerial Image of the Site in 1990



Aerial Image of the Site in 2003



Aerial Image of the Site in 2013



Aerial Image of the Site in 2018

 Site Boundary

SITE PHOTOGRAPHS



Image Obtained Via Google Maps



Aerial View



SITE PHOTOGRAPHS



Image Obtained Via Google Maps

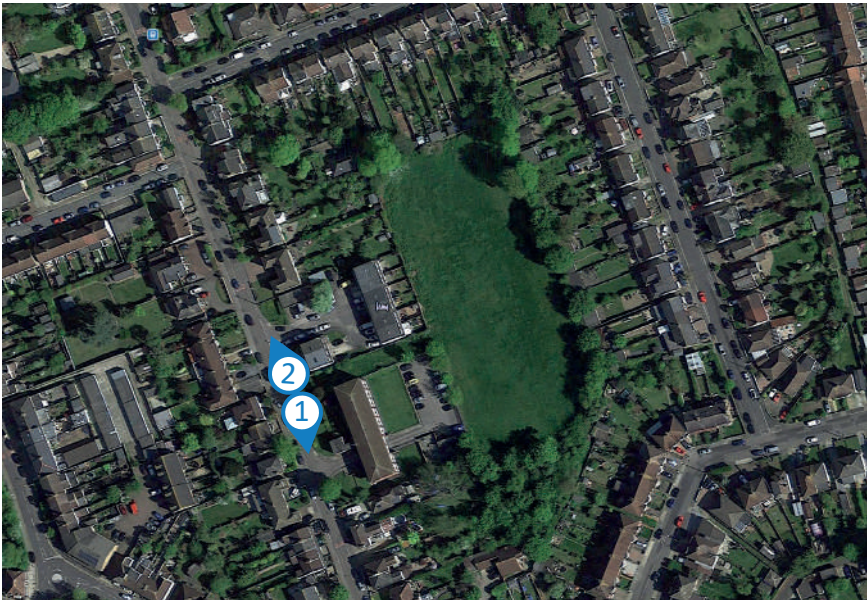

Aerial View



SITE PHOTOGRAPHS

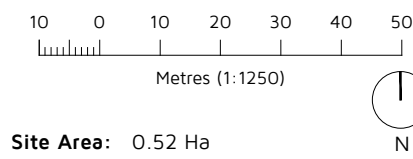
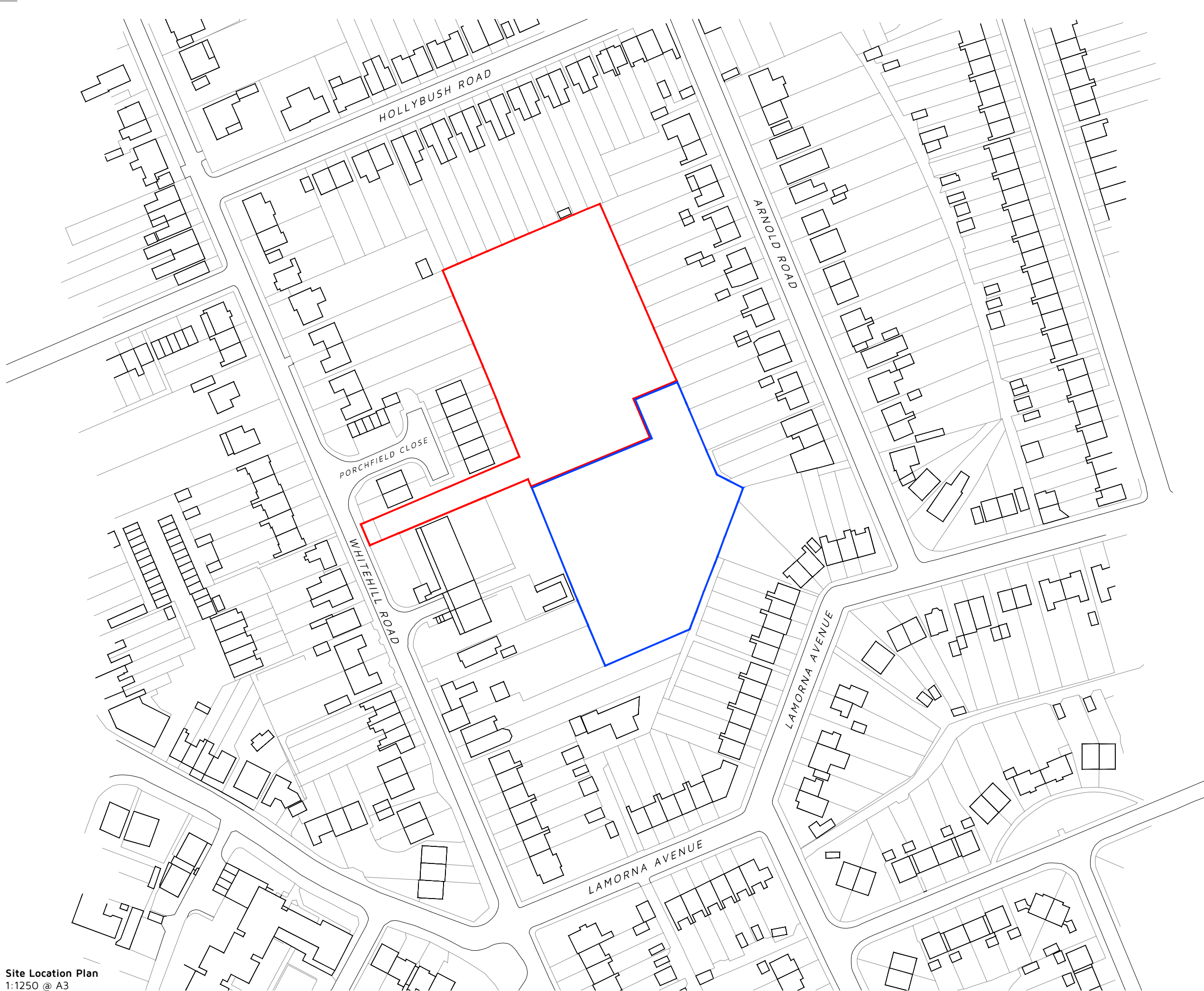

Site Area: 0.52 Ha

 Application Boundary

 Applicant Ownership

Site Location Plan
1:1250 @ A3

Rev:	Reason:	Date:	
Client: KENT COUNTY COUNCIL			
Project: LAND OFF WHITEHILL ROAD, GRAVESEND, KENT, DA12 5PJ			
Title: SITE LOCATION PLAN			
Drawing No: DHA/14263/01	Rev:	Scale: 1:1250	Date: MAR 2020



Eclipse House, Eclipse Park, Sittingbourne Road
Maidstone, Kent. ME14 3EN

t: 01622 776226 f: 01622 776227
e: info@dhaplanning.co.uk w: www.dhaplanning.co.uk

No reproduction by any method of any part of this document
is permitted without the consent of the copyright holders.
Produced for Town and Country planning purposes only.

© Crown Copyright 2019. All rights reserved. Licence Number: 100031961

CAD Reference: DHA_14263_FRMR WHITEHILL FIELDS_CF03

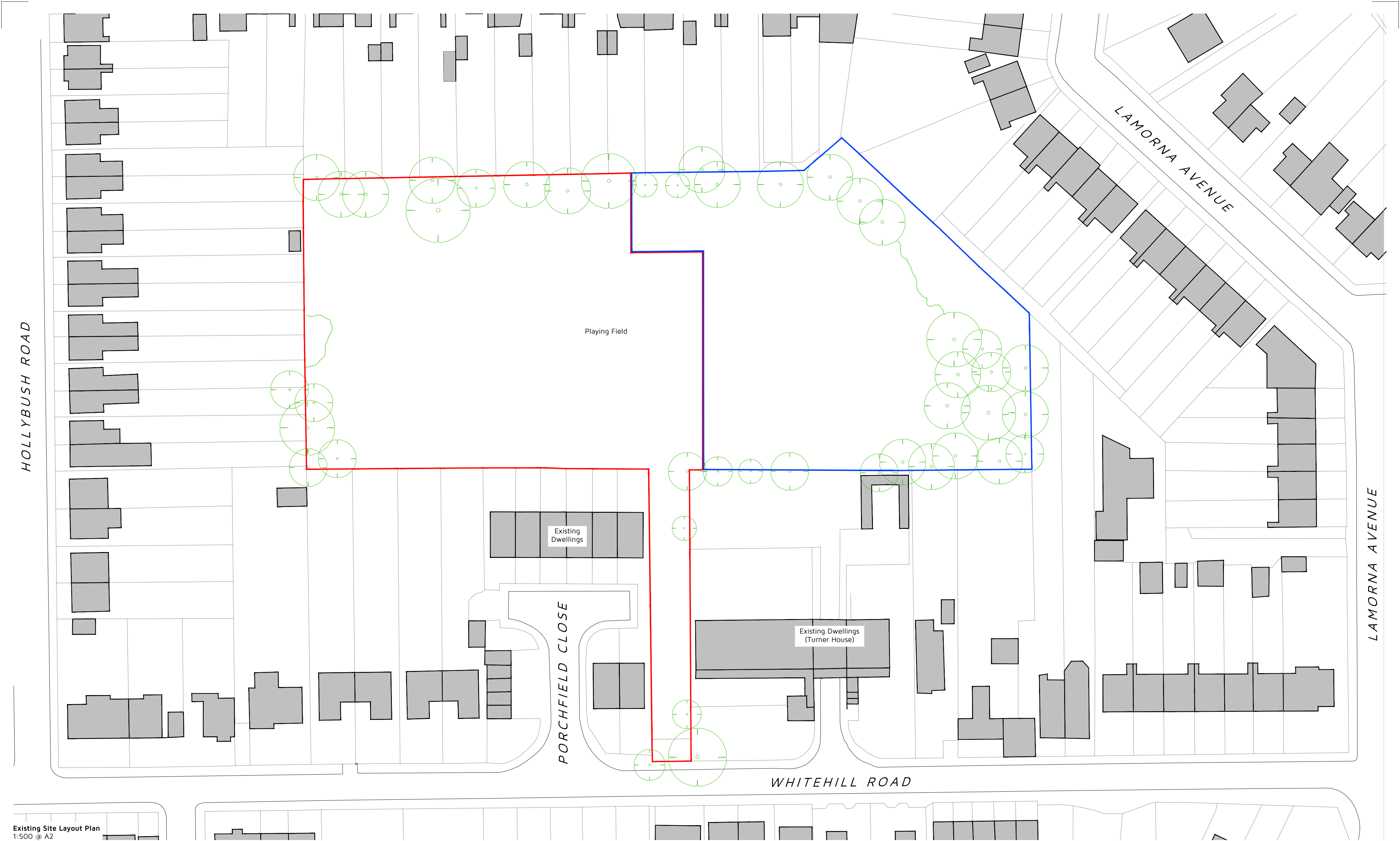

Existing Site Layout Plan
1:500 @ A2

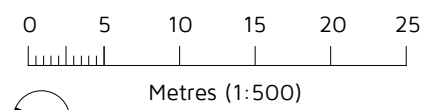

Site Area: 0.52 Ha

- Application Boundary
- Applicant Ownership

- Approximate Location of Existing Tree
- Approximate Location of Existing Tree Group/Hedgerow

Rev: Reason:

Date:

Client:

KENT COUNTY COUNCIL

Project:

LAND OFF WHITEHILL ROAD, GRAVESEND,
KENT, DA12 5PJ

Title:

EXISTING SITE LAYOUT PLAN

Drawing No:

DHA/14263/02

Rev:

Scale:

1:500

Date:

MAR 2020



Eclipse House, Eclipse Park, Sittingbourne Road
Maldstone, Kent, ME14 3EN

t: 01622 776226 f: 01622 776227
e: info@dhaplanning.co.uk w: www.dhaplanning.co.uk

No reproduction by any method of any part of this document
is permitted without the consent of the copyright holders.
Produced for Town and Country planning purposes only.

© Crown Copyright 2019. All rights reserved. Licence Number: 100031961

CAD Reference: DHA_14263_FRMR WHITEHILL FIELDS_CF01 A2



Illustrative Proposed Site Layout Plan
1:500 @ A2

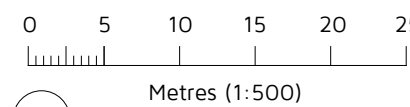

Site Area: 0.52 Ha

- Application Boundary
- Applicant Ownership

- Proposed Tree
- Approximate Location of Existing Tree
- Approximate Location of Existing Tree Group/Hedgerow

Outline Schedule of Accommodation

14 Unit Scheme:

4No. 2-Bedroom House @ circa 70 sqm
(Plots: 1-4)

8No. 3-Bedroom House @ circa 85 sqm
(Plots: 5,6,8,9,11-14)

2No. 4-Bedroom House @ circa 120 sqm
(Plots: 7,10)

On-site parking is provided in accordance with
*Kent Design Guide Review IG3 - Residential
Parking.

Rev: Reason:

Date:

Client:

KENT COUNTY COUNCIL

Project:

LAND OFF WHITEHILL ROAD, GRAVESEND,
KENT, DA12 5PJ

Title:

ILLUSTRATIVE PROPOSED SITE LAYOUT PLAN

Drawing No:

DHA/14263/03

Rev:

Scale:

1:500

Date:

MAR 2020



Eclipse House, Eclipse Park, Sittingbourne Road
Maldstone, Kent, ME14 3EN

t: 01622 776226 f: 01622 776227
e: info@dhaplanning.co.uk w: www.dhaplanning.co.uk

No reproduction by any method of any part of this document
is permitted without the consent of the copyright holders.

Produced for Town and Country planning purposes only.

© Crown Copyright 2019. All rights reserved. Licence Number: 100031961

CAD Reference: DHA_14263_FRMR WHITEHILL FIELDS_CF03 A2