

THIS PAGE IS INTENTIONALLY LEFT BLANK

A3. HISTORIC WEATHER RECORDS FROM WALMER

Thursday

23rd February

Time	00:00	03:00	06:00	09:00	12:00	15:00	18:00	21:00
Weather								
Temp	11 °c	7 °c	6 °c	9 °c	12 °c	14 °c	12 °c	10 °c
Feels Like	7 °c	2 °c	1 °c	5 °c	8 °c	11 °c	7 °c	5 °c
Rain	0.3 mm	1.1 mm	0.8 mm	0.5 mm	0.6 mm	0.0 mm	0.0 mm	0.0 mm

Friday

24rd February

Time	00:00	03:00	06:00	09:00	12:00	15:00	18:00	21:00
Weather								
Temp	4 °c	5 °c	4 °c	5 °c	6 °c	6 °c	5 °c	5 °c
Feels Like	-1 °c	0 °c	0 °c	0 °c	2 °c	2 °c	2 °c	2 °c
Rain	0.1 mm	0.0 mm	0.0 mm	0.0 mm	0.0 mm	0.0 mm	0.0 mm	0.0 mm









Saturday

25th February

Time	00:00	03:00	06:00	09:00	12:00	15:00	18:00	21:00
Weather								
Temp	8 °c	7 °c	6 °c	9 °c	10 °c	11 °c	10 °c	8 °c
Feels Like	5 °c	3 °c	2 °c	5 °c	6 °c	8 °c	6 °c	4 °c
Rain	0.0 mm	0.0 mm	0.0 mm	0.1 mm	0.0 mm	0.1 mm	0.1 mm	0.6 mm







Sunday

26th February

Time	00:00	03:00	06:00	09:00	12:00	15:00	18:00	21:00
Weather								
Temp	9 °c	9 °c	9 °c	10 °c	10 °c	11 °c	10 °c	10 °c
Feels Like	5 °c	5 °c	5 °c	7 °c	7 °c	8 °c	7 °c	6 °c
Rain	1.0 mm	0.4 mm	0.1 mm	0.1 mm	0.1 mm	0.1 mm	0.1 mm	0.1 mm

Monday

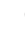
27th February

Time	00:00	03:00	06:00	09:00	12:00	15:00	18:00	21:00
Weather								
Temp	7 °c	7 °c	6 °c	8 °c	10 °c	11 °c	9 °c	8 °c
Feels Like	2 °c	1 °c	0 °c	4 °c	6 °c	7 °c	5 °c	4 °c
Rain	0.1 mm	0.2 mm	5.2 mm	2.6 mm	2.1 mm	1.7 mm	0.1 mm	0.2 mm

Tuesday









28th February

Time	00:00	03:00	06:00	09:00	12:00	15:00	18:00	21:00
Weather								
Temp	6 °c	5 °c	5 °c	7 °c	7 °c	7 °c	6 °c	6 °c
Feels Like	1 °c	0 °c	0 °c	3 °c	4 °c	2 °c	1 °c	1 °c
Rain	0.2 mm	0.9 mm	0.0 mm	0.0 mm	0.0 mm	0.2 mm	0.9 mm	0.1 mm

Wednesday

1st March

Wed 01st Mar, 2017

Time	00:00	03:00	06:00	09:00	12:00	15:00	18:00	21:00
Weather								
Temp	7 °c	7 °c	6 °c	7 °c	8 °c	10 °c	8 °c	7 °c
Feels Like	2 °c	2 °c	2 °c	4 °c	5 °c	7 °c	5 °c	4 °c
Rain	0.1 mm	0.1 mm	0.1 mm	0.0 mm	0.0 mm	0.1 mm	0.3 mm	0.1 mm

A4. SWEEP PATH ANALYSIS

THIS PAGE IS INTENTIONALLY LEFT BLANK

Notes:
 1. This drawing is based upon drawing number 2016-124/Topo_01_2D supplied by Gladman and Icení. Projects Ltd. shall not be liable for any inaccuracies or deficiencies.

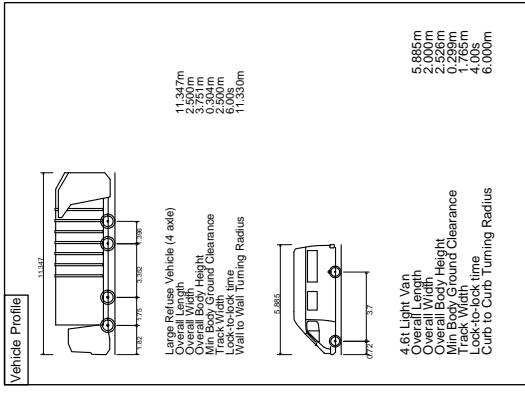

iceni

Icení Projects
 Filcraft House
 11-116 Charing Cross Road
 London, WC2H 0JR

T 020 3640 8508
 F 020 3435 4228
 mail@iceniprojects.com

Client: Gladman Developments

Project: Dover Road, Walmer, Kent

Title: Swept Path Analysis

Drawn By: FA	Checked By: EF	Approved By: FP
Scale @ A3: 1:500	Date: 08/06/2017	Date: 08/06/2017
Project No.: 16-T129	Drawing No.: 05	Rev.: -

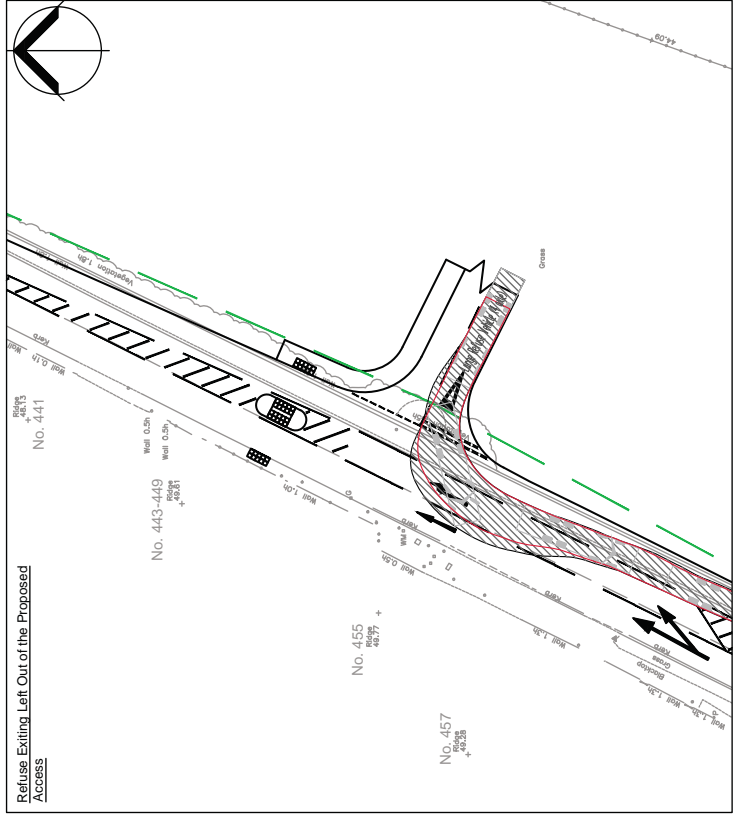
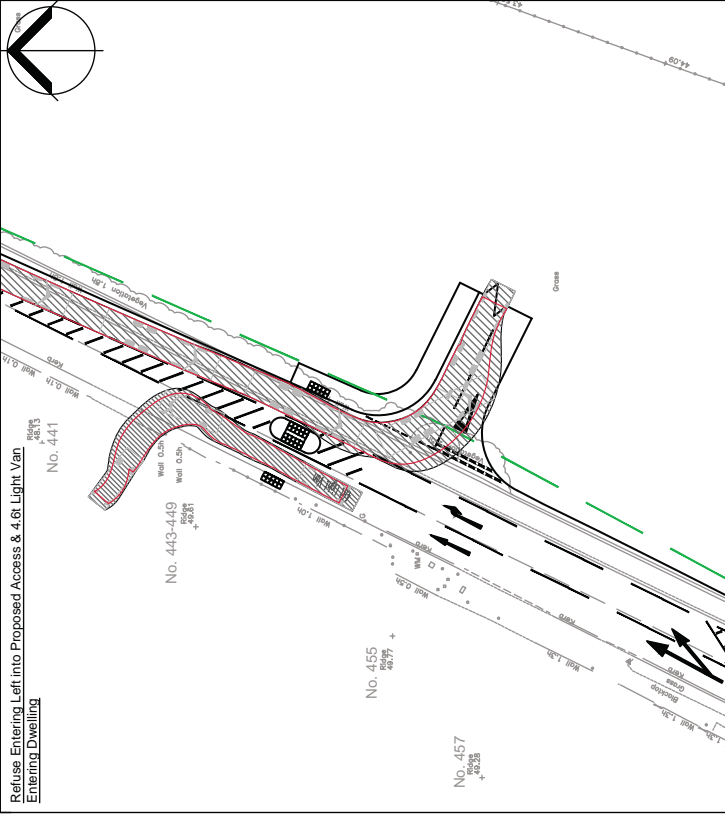
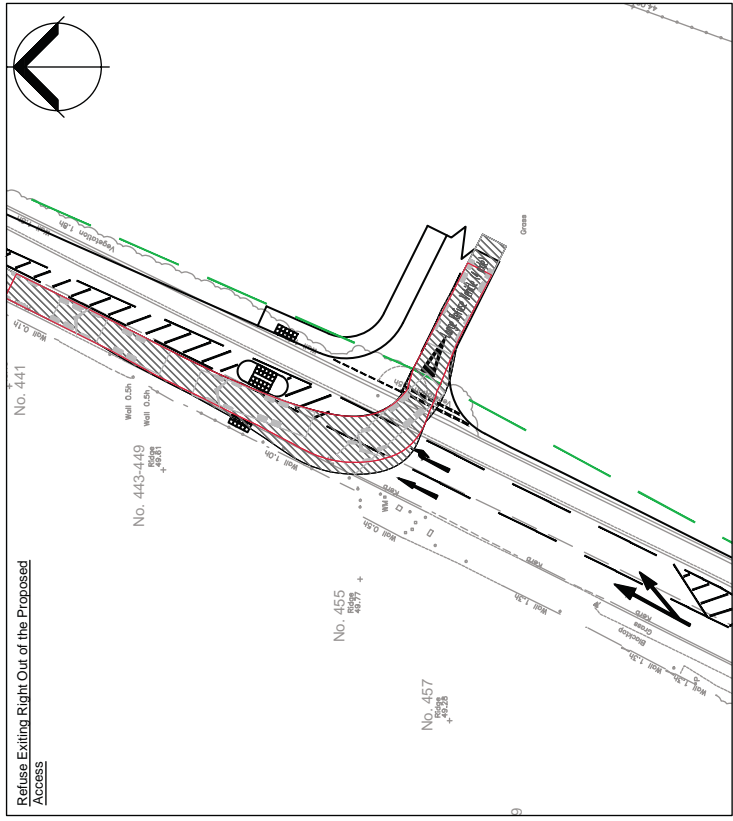
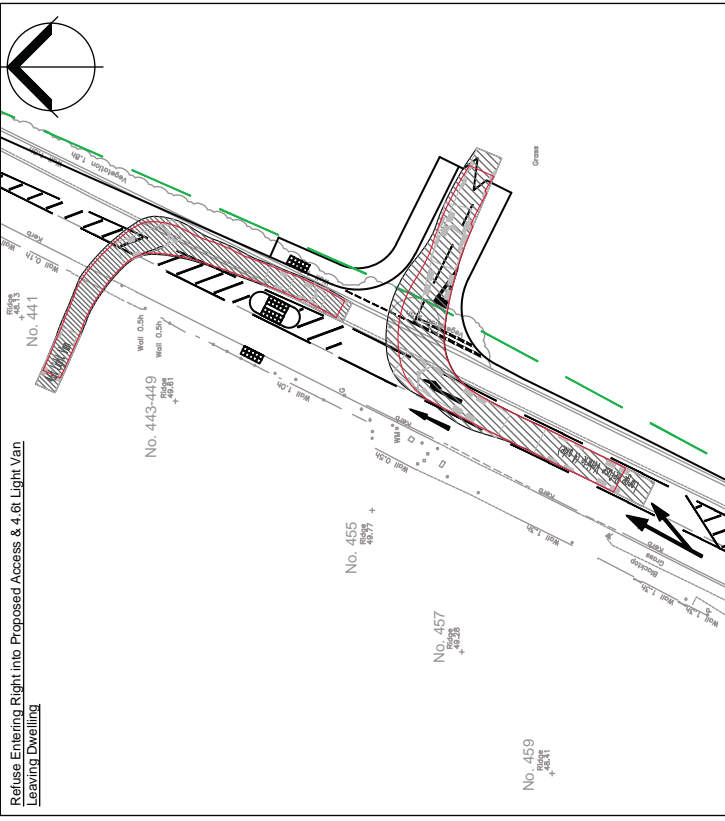

THIS PAGE IS INTENTIONALLY LEFT BLANK

A5. PROPOSED ACCESS OPTIONS

THIS PAGE IS INTENTIONALLY LEFT BLANK