

ROOF PLAN @ 1:50

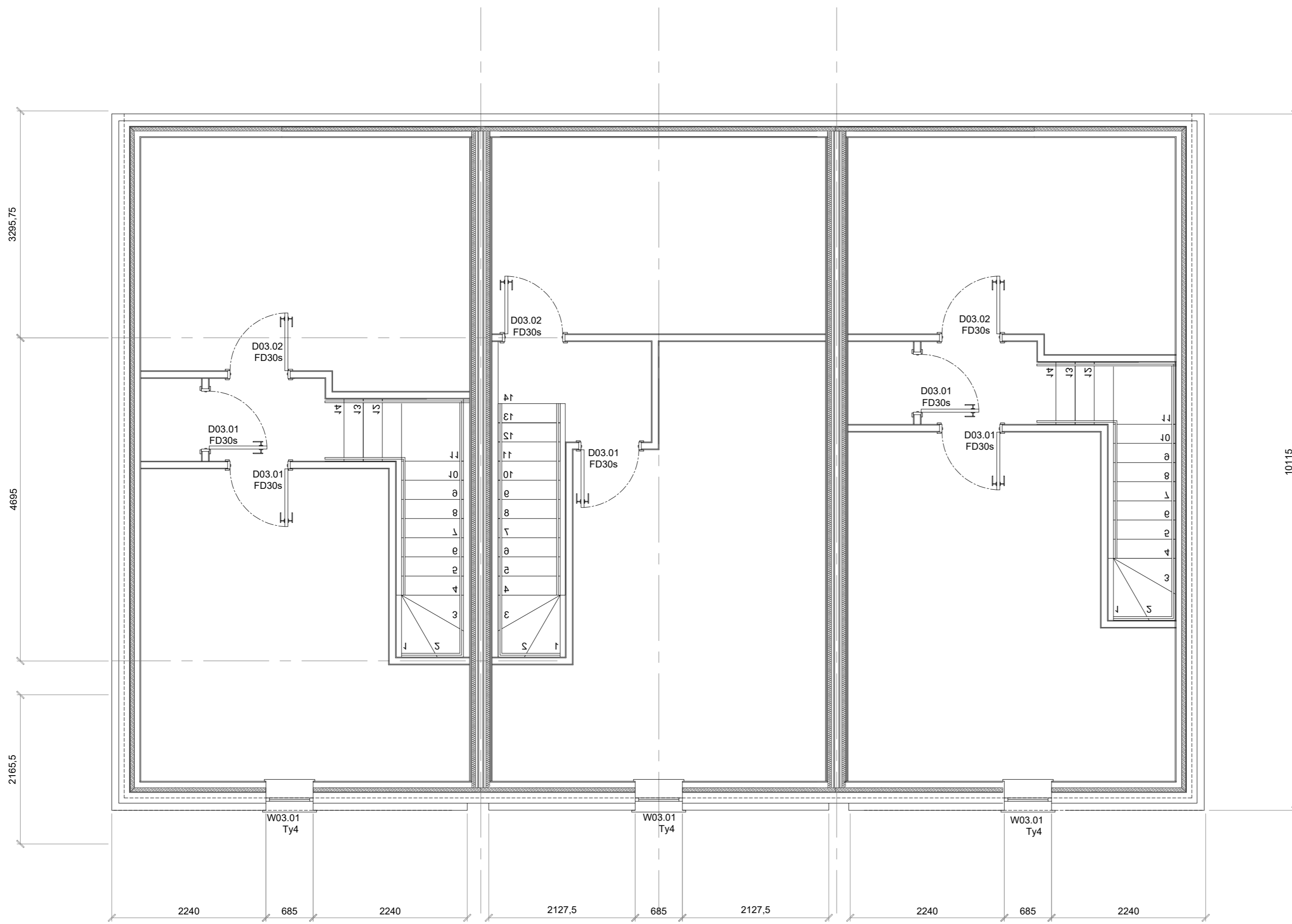

THIRD FLOOR PLAN @ 1:50

00 For information 20.09.21 SS

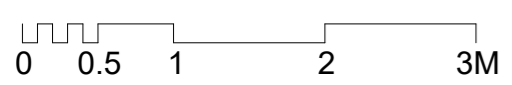

Hollaway

London | 30a Acton Street | London | WC2H 9PG
 T +44 (0) 20 7096 5429 | E london@hollawaystudio.co.uk | W www.hollawaystudio.co.uk

West | The Tramway Studios | Rampart Road | Hyde | East | T211 5BG
 T +44 (0)1293 260 313 | E west@hollawaystudio.co.uk | W www.hollawaystudio.co.uk

Project | Royal Victoria Hospital

Client | RVH Folkestone Ltd

Title | House Type 2 - GAs 3

Status | FOR INFORMATION

Scale | A1 | 1:50 Date | 15.09.21 Drawn | SS Chk'd | MP

Project Number | Drawing Number | Revision
 18.140-A-H2-100.002 00

Bim Number