

1. CONTRACTORS MUST CHECK ALL DIMENSIONS ON SITE. ONLY FIGURED DIMENSIONS ARE TO BE WORKED FROM. DISCREPANCIES MUST BE REPORTED TO THE ARCHITECT OR ENGINEER BEFORE PROCEEDING. © THIS DRAWING IS COPYRIGHT.
2. REPRODUCED FROM OS SITEMAP © BY PERMISSION OF THE CONTROLLER OF HER MAJESTY'S STATIONERY OFFICE. © CROWN COPYRIGHT 2008. ALL RIGHTS RESERVED. LICENCE NUMBER 100007126.
3. UNTIL TECHNICAL APPROVAL HAS BEEN OBTAINED FROM THE RELEVANT AUTHORITIES, ALL DRAWINGS ARE ISSUED AS PRELIMINARY AND NOT FOR CONSTRUCTION. SHOULD THE CONTRACTOR COMMENCE SITE WORK PRIOR TO APPROVAL BEING GIVEN IT IS ENTIRELY AT THEIR OWN RISK.
4. WOODS HARDWICK CANNOT ACCEPT LIABILITY FOR ANY DISCREPANCIES IN TERMS OF COORDINATES OR ANY OTHER INFORMATION DECIPHERED FROM DWG'S.

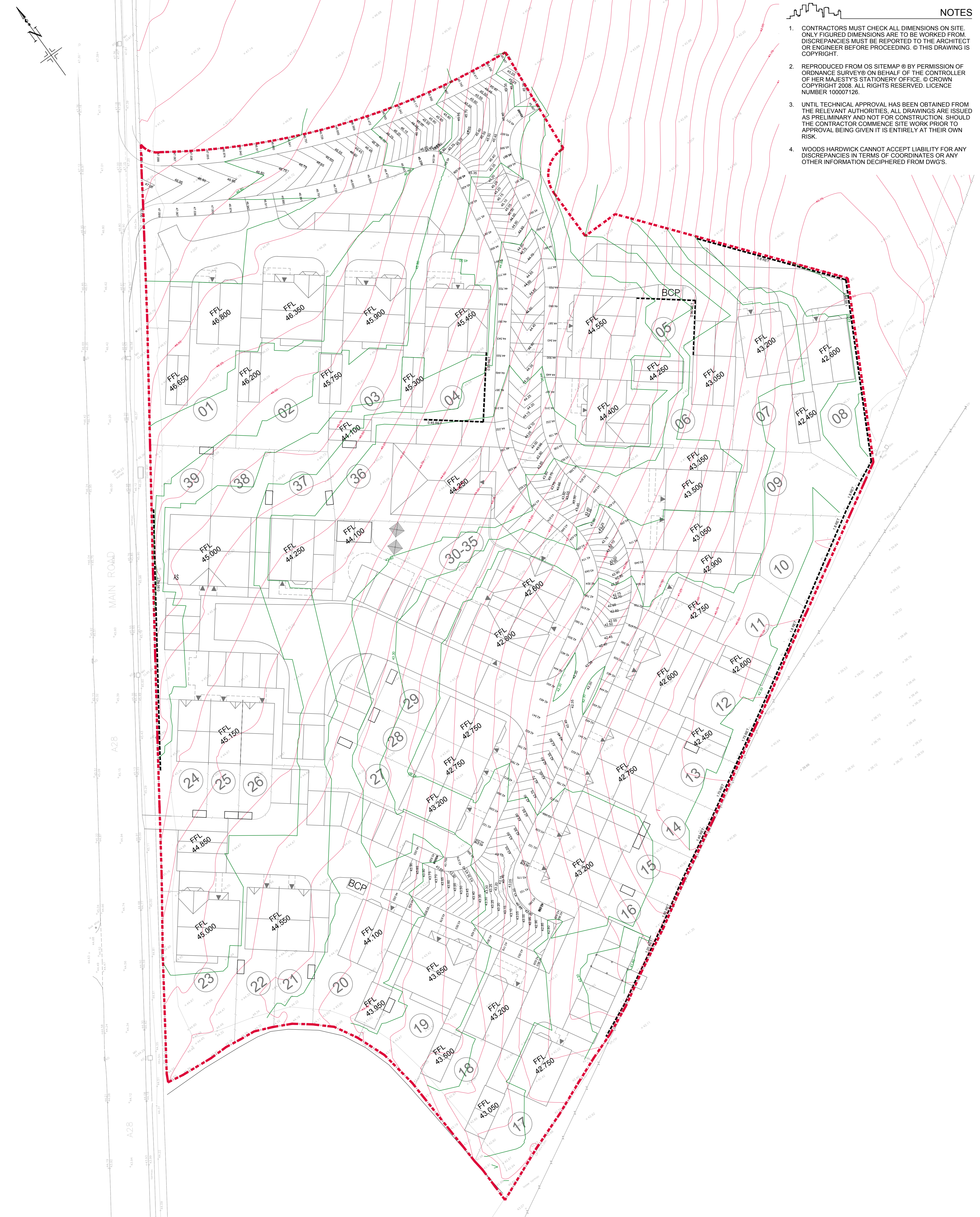

KEY

- SITE BOUNDARY
- FINISHED FLOOR LEVEL
- RETAINING FEATURE (MAX. RETAINING AS ANNOTATED)
- EXISTING CONTOURS
- PROPOSED CONTOURS

REVISION	DESCRIPTION	DRAWN	CHECKED	DATE
E	RETAINING REDUCED ALONG BOUNDARIES	CG	MDF	27.09.2018
D	UPDATED FOLLOWING INTERNAL AUDIT	CG	MDF	18.09.2018
C	UPDATED TO SUIT LATEST LEVEL STRATEGY	CG	MDF	18.09.2018
B	UPDATED TO SUIT LATEST LAYOUT	CG	MDF	17.07.2018
A	EXISTING AND PROPOSED CONTOURS ADDED	MDF	MDF	16.06.2017

WOODS HARDWICK
ARCHITECTS, ENGINEERS AND DEVELOPMENT CONSULTANTS

15-17 GOLDINGTON ROAD
BEDFORD, MK40 3NH
T: +44 (0)1234 268662
FORT DUNLOP, FORT PARKWAY
BIRMINGHAM, B24 9PE
UNITED KINGDOM
T: +44 (0)121 6297784
MAIL@WOODSHARDWICK.COM
WWW.WOODSHARDWICK.COM

TITLE: WESTFIELD DOWN
SUSSEX
DETAILS: PROPOSED LEVELS STRATEGY

SCALE: 1:250 @ A1 DATE: JUNE 2017 DRAWN: PK CHK: MDF

