

Notes
 1. This drawing is the property of GBA Designs Limited. Copyright is reserved by them and this drawing is issued on the condition that it is not reproduced or copied in part or in whole without their written consent. Do not scale from this drawing. All dimensions to be checked on site before commencement of work. This drawing is to be read in conjunction with specifications and/or other consultants drawings as applicable.



Block North Front Elevation (to Forstal Road) 1:100

SECOND FLOOR

FIRST FLOOR

+0.900 GROUND FFL

-0.000 PAVEMENT (datum)

-1.100 TOWPATH GL

9 No. Market price Housing units (1-9)

ROAD FRONTAGE

Block Ground Floor Plans 1:100

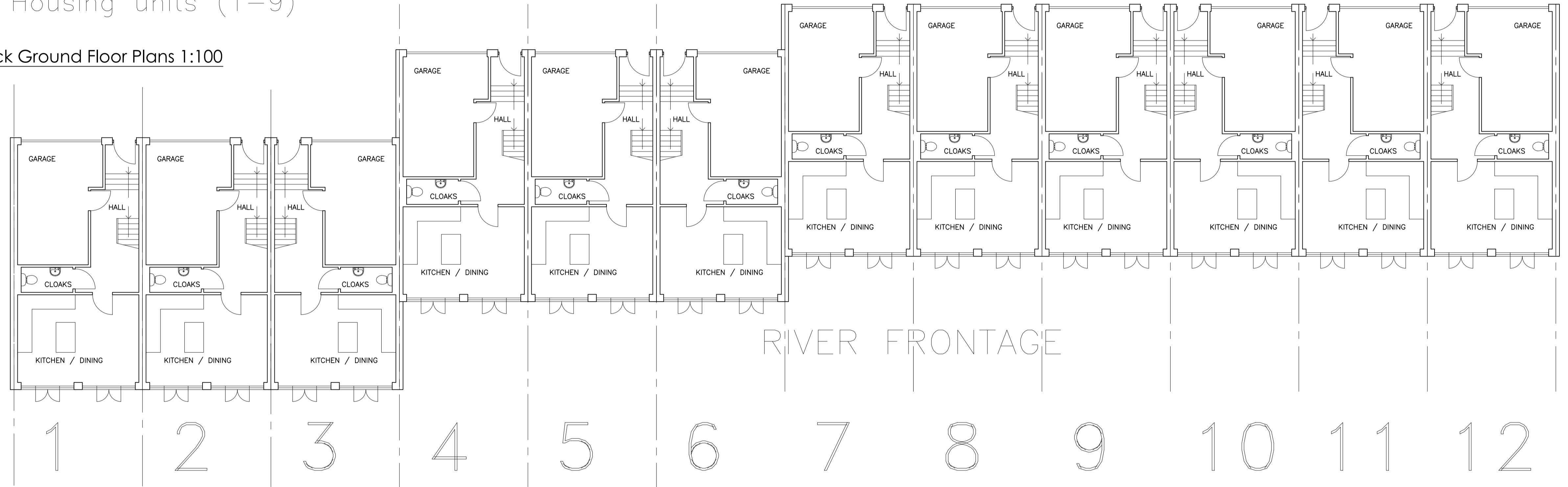

RIVER FRONTAGE

Block South Rear Elevation (to River) 1:100

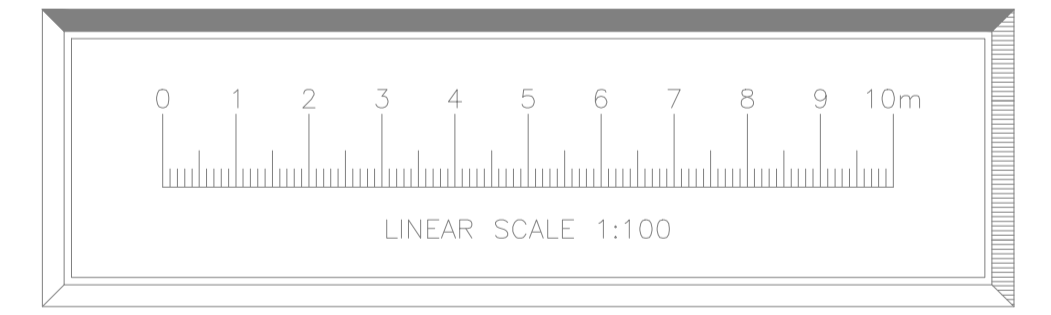

+0.900 GROUND FFL
 -0.000 PAVEMENT (datum)
 -1.100 TOWPATH GL

REV.	DESCRIPTION	DATE
C	River elevation and plans update	11.5.16
B	General revision	23.3.16
A	Housing scheme altered	24.1.16

architectural & interior designers
 Suite 18770 Churchill Square Business Centre #
 Kings Hill Kent
 ME19 4YU
 tel: 01732523521 fax: 01732523522 email: info@gbadesigns.com



proposed development at:
Phoenix House
 Aylesford, Kent, ME20 7AU

Proposed Ground Plan & Elevations

SCALE: 100 @ A1
 DATE: Jan 2016
 DWG NO.: PHA/110C