

# Tree Survey Plan

Walderslade Round Wood Site, Walderslade, Kent

Kent County Council



This drawing and design are the copyright of Lloyd Bore Ltd. Do not scale from this drawing.

All dimensions to be checked on site by contractor prior to commencement of any work.

All materials, components and workmanship shall comply with the relevant British Standards, Codes of Practice and manufacturers written instructions.

T14	Beech	10	100, 100, 300, 100, 100, 100	C1	3.37
T15	Sweet Chestnut	20	250, 300, 300, 100, 250, 250, 150, 100, 200, 250, 250, 250, 250	B1	10.04
T16	Sweet Chestnut	18	200, 200, 350, 350, 90, 150, 400	B2	8.62
T17	Beech	10	100, 150, 80, 100	C1	2.65
T18	Beech	10	250	C1	3
T19	Sweet Chestnut	7	300, 300	U	5.09
T20	Goat Willow	16	450, 250	B2	6.18
T21	Goat Willow	10	300	C1	3.6
T22	Goat Willow	10	200	C1	2.4
T23	Silver Birch	6	150	C2	1.8
T24	Unknown	6	200	U	2.4
T25	Sweet Chestnut	18	250, 250, 300, 300, 150, 200, 200	B2	7.66
T26	Sweet Chestnut	18	250, 250, 150, 200, 200	B2	5.72
T27	Goat Willow	5	300	U	3.6
T28	Goat Willow	10	250	C2	3
G1	Group	8	100	C2	2.4
G2	Group	15	300	B2	3.6
G3	Group	17	200	B2	2.4
G4	Group	17	200	B2	2.4
G5	Group	17	150	B2	1.8
G6	Group	20	300	B2	3.6

### LEGEND:

- Tree Canopy
- Root Protection Area
- Site Boundary

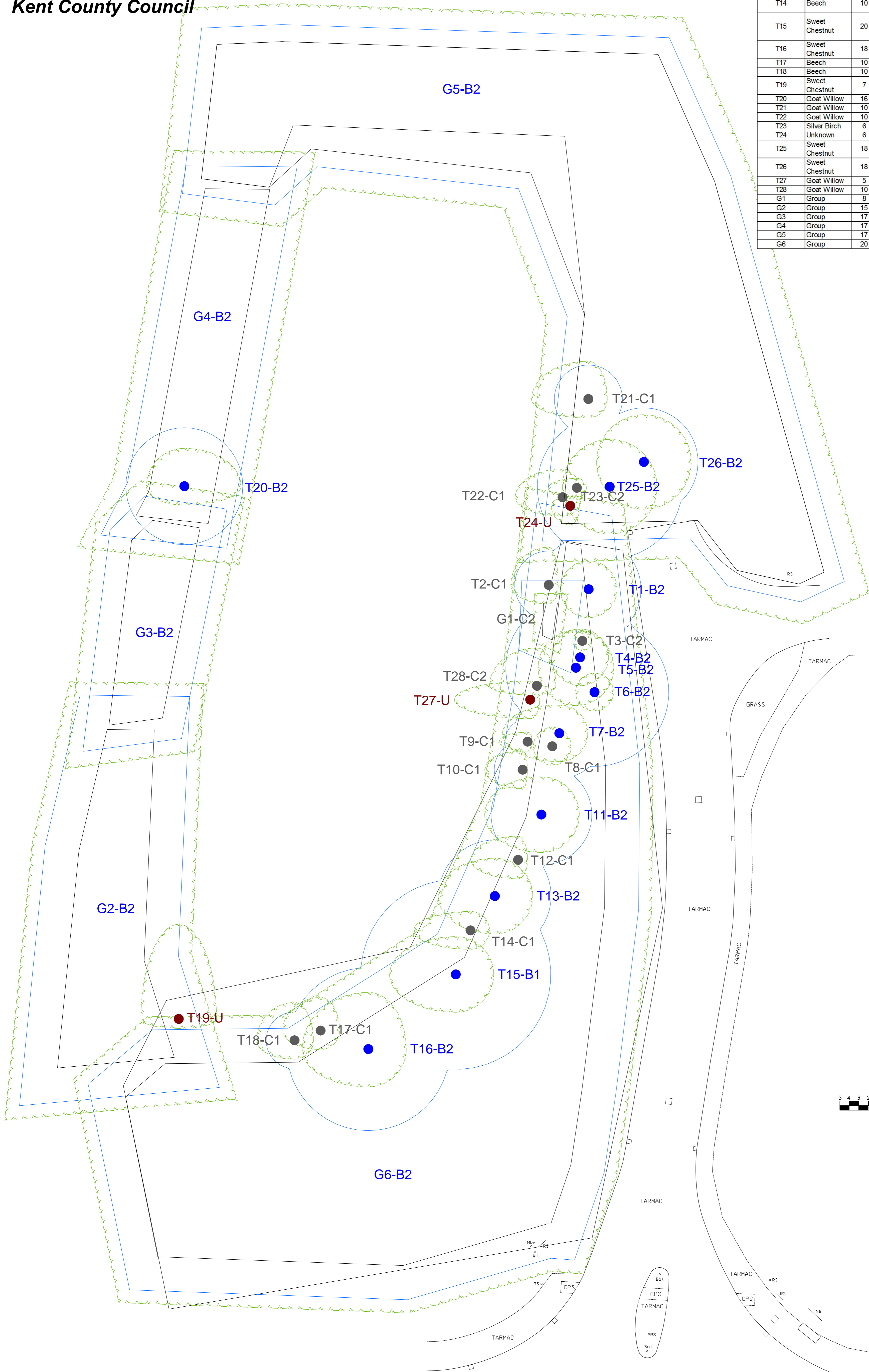

rev. **A** rev date: **24/11/15**  
revision notes:

drawing no. **3478\_DR\_001**

client & project:  
**Kent County Council**  
**Walderslade Round Wood Site**  
**Walderslade, Boxley, Kent**  
**Walderslade Woods**

drawing title:  
**Tree Survey Plan**

status: **PLANNING**  
scale: **1:200** drawn by: **CB**  
sheet: **A1** checked by: **JH**

**lloyd bore**

33 ST GEORGE'S PLACE  
CANTERBURY  
KENT CT1 1UT

t: 01227 464 340  
e: mail@lloyd bore.co.uk  
w: www.lloyd bore.co.uk