

AMENDED



FRONT BAY STUDY @ 1:50



REAR BAY STUDY @ 1:50

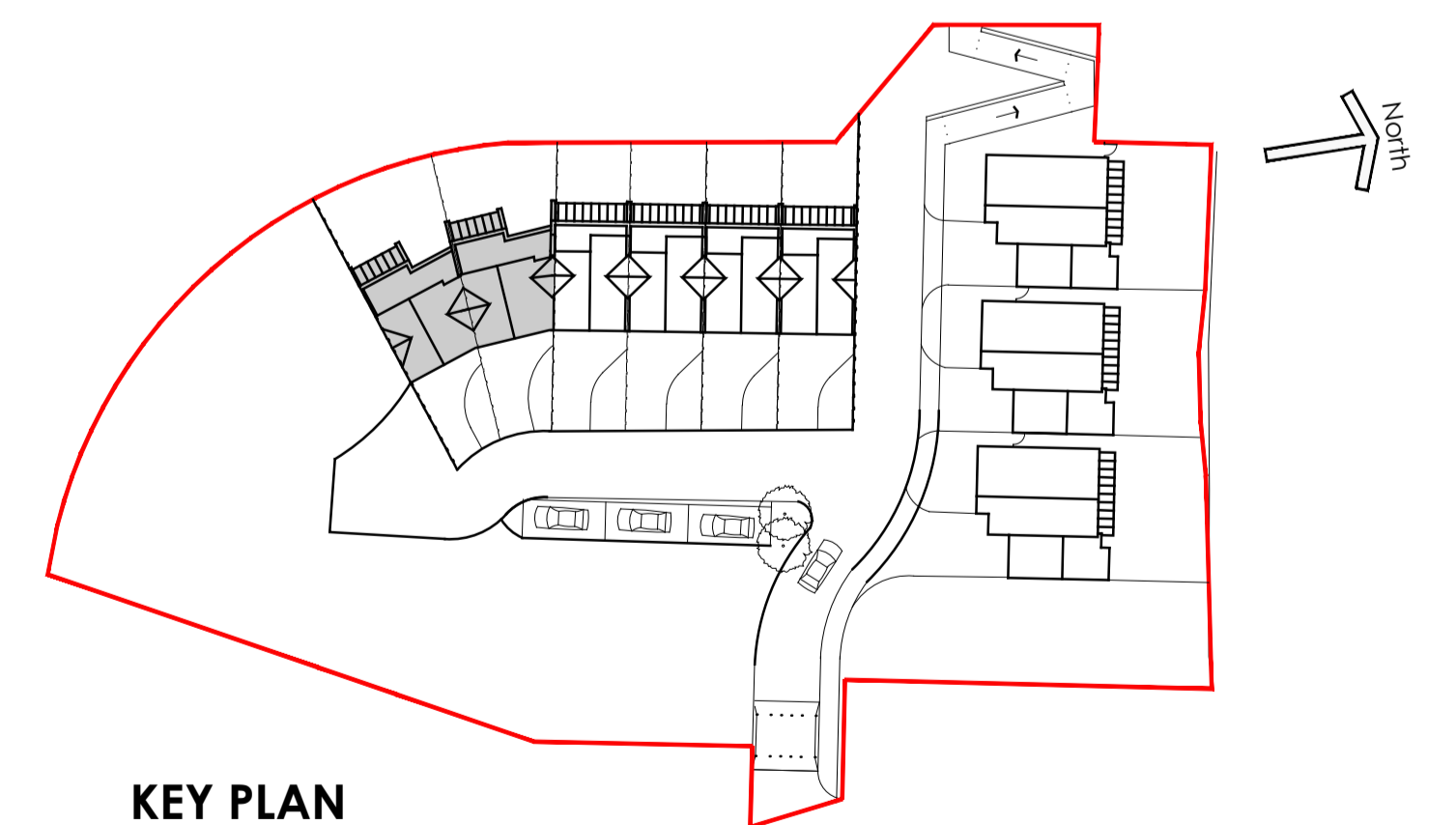

KEY PLAN

Walderslade Wood, Boxley Housetype 2 - PROPOSED FRONT AND REAR ELEVATIONS

©This drawing is the copyright of **guy hollaway** architects and should not be copied, reproduced or used without written consent. All Rights Reserved.
All dimensions are to be checked on site prior to fabrication and the Architect should be notified of any discrepancy.
Do not scale from this drawing.

Revisions

Revision	Date
A General Amends	23.12.09
B General Amends	21.01.10
C Revised Site Location Plan & Proposed Site Plan	02.01.18
D Revised Site Location Plan, Proposed Site Plan, Elevations & Floor Plans	12.02.18
E Revised Site Location Plan, Proposed Site Plan, Elevations & Floor Plans	27.02.18

Project | Proposed Residential Development,
Walderslade Round Wood Site, Boxley

Client | KCC

Title | Proposed Front and Rear Elevations

Status | **PLANNING**

Scale@A1 | 1:50@A1 Date | 15.01.18 Drawn | TS Chkd | BL

guy hollaway

London | Fourth Floor | 251 Pentonville Road | London | N1 9HG
T +44 (0) 20 7014 4900 | F +44 (0) 1303 268 214 | E london@guyhollaway.co.uk | W www.guyhollaway.co.uk

Kent | The Tramway Stables | Rompark Road | Hythe | Kent | CT21 5EG
T +44 (0) 1303 260 515 | F +44 (0) 1303 268 214 | E kent@guyhollaway.co.uk | W www.guyhollaway.co.uk

Project Number
07.10

Drawing Number
07.10.07

Revision
E

Rev Number