

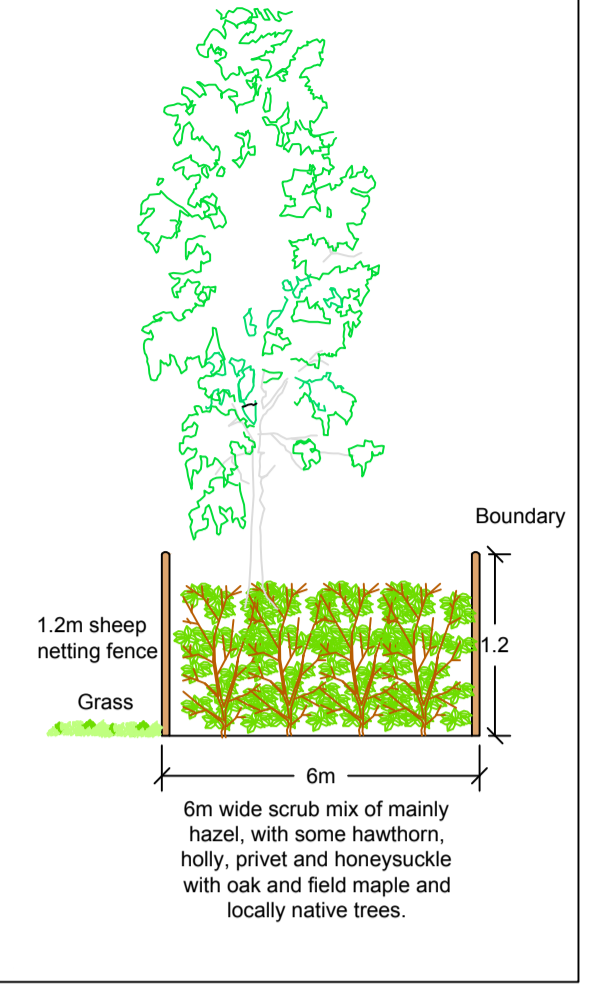

(um)

Boundary scrub and tree planting



New scrub and tree planting between rear gardens and site boundary with mainly hazel with some hawthorn, holly, privet and honey suckle with oak and field maple - see detail.

MANAGEMENT OF EXISTING TREES, HEDGES AND SHRUBS

Shared Management Company
All significant existing trees hedges and shrubs will be within areas controlled by the proposed areas of shared ownership. The management plan for these areas will be secured by a Section 106 Agreement. The extent of the shared management company land is shown on the drawing.

Existing Boundary Trees and Hedgerows
These will be retained and inspected for safety as required. The hedge along Wootton Lane will only be cut for highway safety and for visibility splays.

Areas of Whip Planting
These areas were planted some 20 years ago. They are dense, with many poor quality trees which will not develop in to mature trees. The proposed management of these areas is shown on the drawing.

Proposed New Planting
The principal new planting to reinforce the screening of the proposed development from views from the Kent Downs AONB is all within the shared management areas. The details of this planting will be conditioned and full details will be provided under Reserved Matters applications. This will include the establishment of the planting and the long term management of it to enhance the existing trees, hedges and shrubs in the shared management areas.

Key

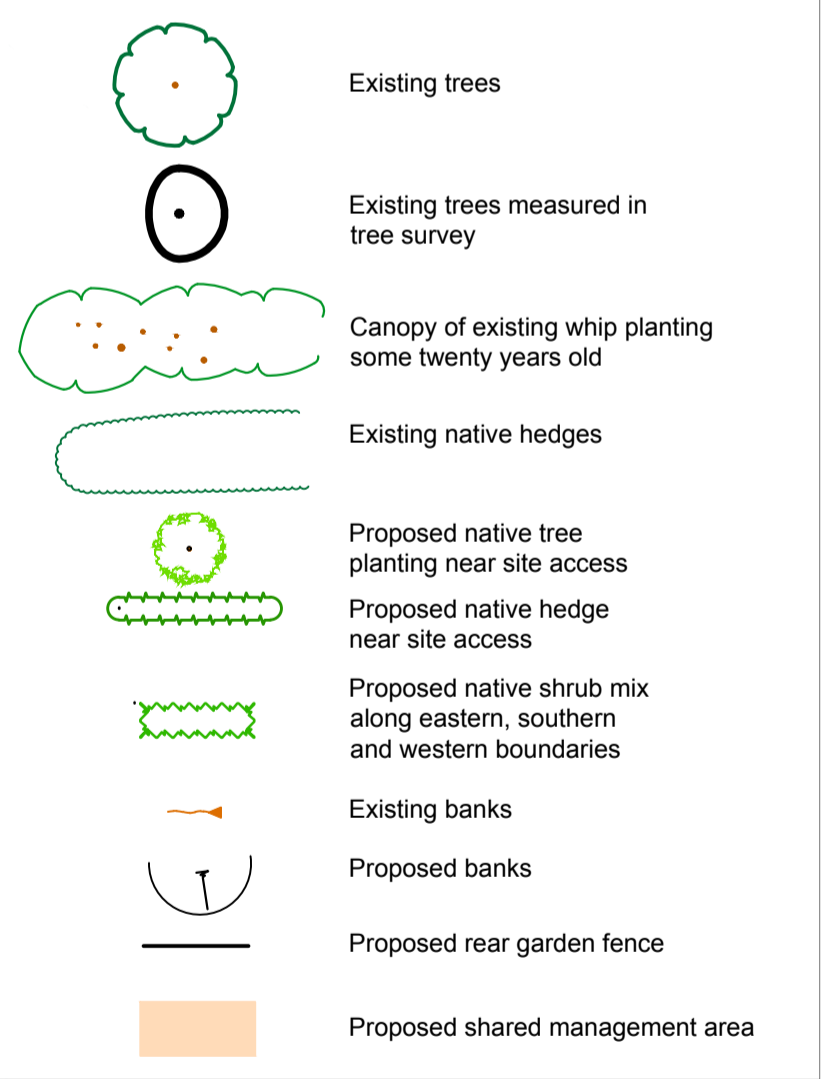

C	LEAP location amended	08.16
B	Details added	05.16
A	Architects layout updated	05.16
Rev	Description	Date

PLANNING

LaDellWood
t: 01622 850245
e: info@ladellwood.co.uk
w: www.ladellwood.co.uk
Stocks Studio, Grafty Green, Maidstone, Kent ME17 2AP

Project **DEACON LANDSCAPE, CANTERBURY**

Drawing title **Landscape strategy - supporting details**

Scale	Date	Drawing number	Rev
1:500@A2	Aug 2015	2257/15/B/4C	

